

**BENCHMARK**

- BM#1 60' IN SOUTH LEG OF "H" POLE HIGH LINE STRUCTURE, 75' NORTH & 80' EAST OF C 127TH STREET & CENTERLINE BURLINGTON NORTHERN RAILROAD. ELEV. = 1365.37'
- BM#2 Top of iron at SW. Cor. SW. 1/4 Sec. 2, T27S, R2E, (127th St. E. & 21st St. N.). ELEV. = 198.01 (CITY DATUM) 1385.41 NGVD

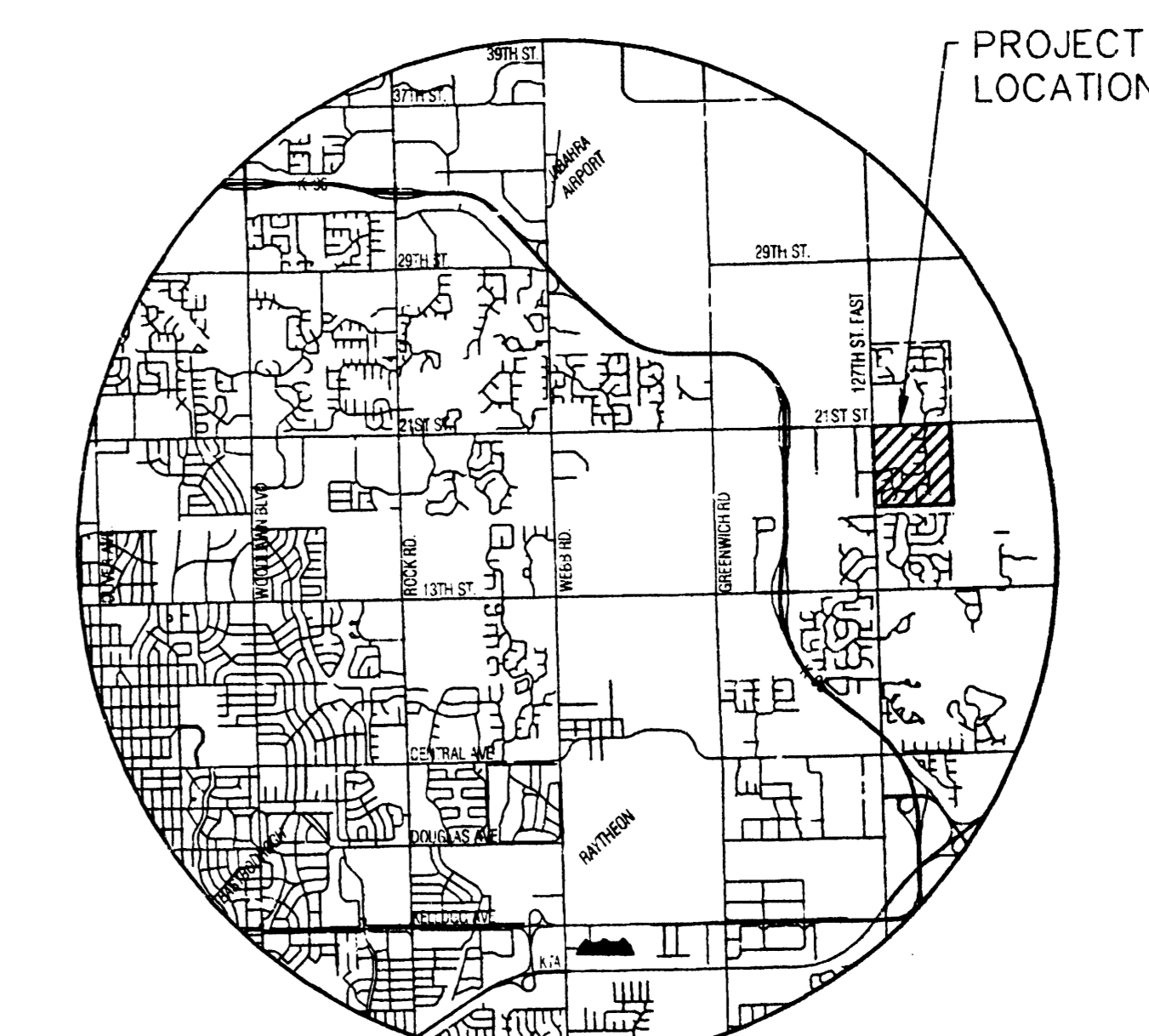

**VICINITY MAP**

**LEGEND**

- CONIFEROUS TREE & DIAMETER
- DECIDUOUS TREE & DIAMETER
- BUSH
- EDGE OF TREES
- FENCE
- SANITARY SEWER MANHOLE
- GAS METER
- POLE
- HIGH LINE POLE
- GATE
- WALL
- LIGHT POLE
- FIRE HYDRANT
- WATER VALVE
- WATER METER
- POWER POLE AND GUY ANCHOR
- TELEPHONE RISER
- INLET
- STORM SEWER PIPE
- WATER LINE
- SANITARY SEWER LINE
- GAS LINE
- TELEPHONE LINE
- UNDERGROUND ELECTRIC LINE
- OVERHEAD TELEPHONE
- OVERHEAD ELECTRIC
- UNDERGROUND FIBER OPTIC CABLE
- SECTION CORNER
- PROPERTY CORNER FOUND
- BENCHMARK
- WO — WALKOUT
- VO — VIEWOUT
- TVO — TERRACED VIEWOUT
- TWO — TERRACED WALKOUT
- WO\* — WALKOUT WHICH MAY REQUIRE THICKER FOOTING AND/OR ENGINEERED FILL UNDER FOOTINGS
- SPOT — SPOT ELEV.
- PAD=1302.8 ADD 2 STEPS TF=1364.8 W=1302.1 — PROP. HOUSE ELEV.
- PAD=1362.8 ADD 2 STEPS TF=1384.8 W=1362.1 — EXST. PLOT PLAN HOUSE ELEV.

**REED'S COVE ADDITION**

MINIMUM PAD ELEVATIONS (LOWEST OPENINGS)			
LOT	BLOCK	ELEVATION (CITY DATUM)	ELEVATION (USGS)
1	1	165.60	1353.00
2	1	165.60	1353.00
3	1	165.60	1353.00
4	1	165.60	1353.00
5	1	165.60	1353.00
9	1	169.60	1357.00
10	1	169.10	1356.50
11	1	168.10	1355.50
12	1	168.10	1355.50
13	1	166.60	1354.00
14	1	166.60	1354.00
15	1	168.10	1355.50
16	1	168.10	1355.50
17	1	169.10	1356.50
18	1	169.60	1357.00
1	2	165.60	1353.00
2	2	165.60	1353.00
3	2	165.60	1353.00
4	2	165.60	1353.00
5	2	165.60	1353.00
6	2	165.60	1353.00
7	2	165.60	1353.00
8	2	163.60	1351.00
9	2	161.60	1349.00
10	2	161.60	1349.00

**REED'S COVE 2ND ADDITION**

MINIMUM PAD ELEVATIONS (LOWEST OPENINGS)			
LOT	BLOCK	ELEVATION (CITY DATUM)	ELEVATION (USGS)
1	1	166.10	1353.00
1	4	165.10	1353.00

\* WITH CORRECTION TO PLAT

DATE	NOTES
11/24/03	INITIAL PHASE
12/11/03	ADD REED'S COVE 2ND
8/24/03	ADDITIONAL PHASES

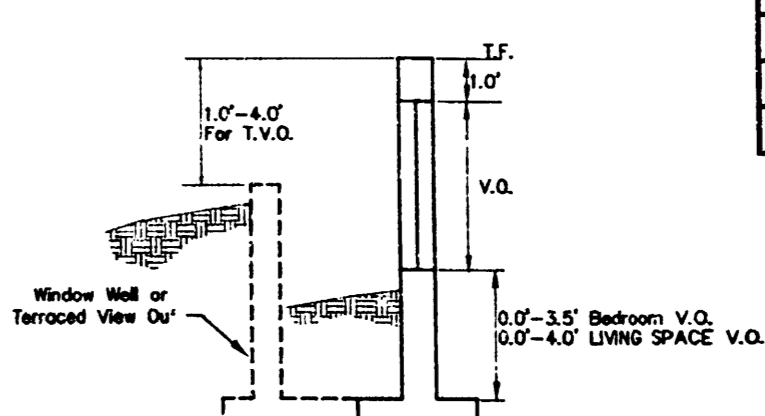

VIEW OUT & TERRACED VIEW OUT DETAIL

**VIEW OUT & WALK OUT PLAN**

