

THURLOW ADDITION
(Drainage)

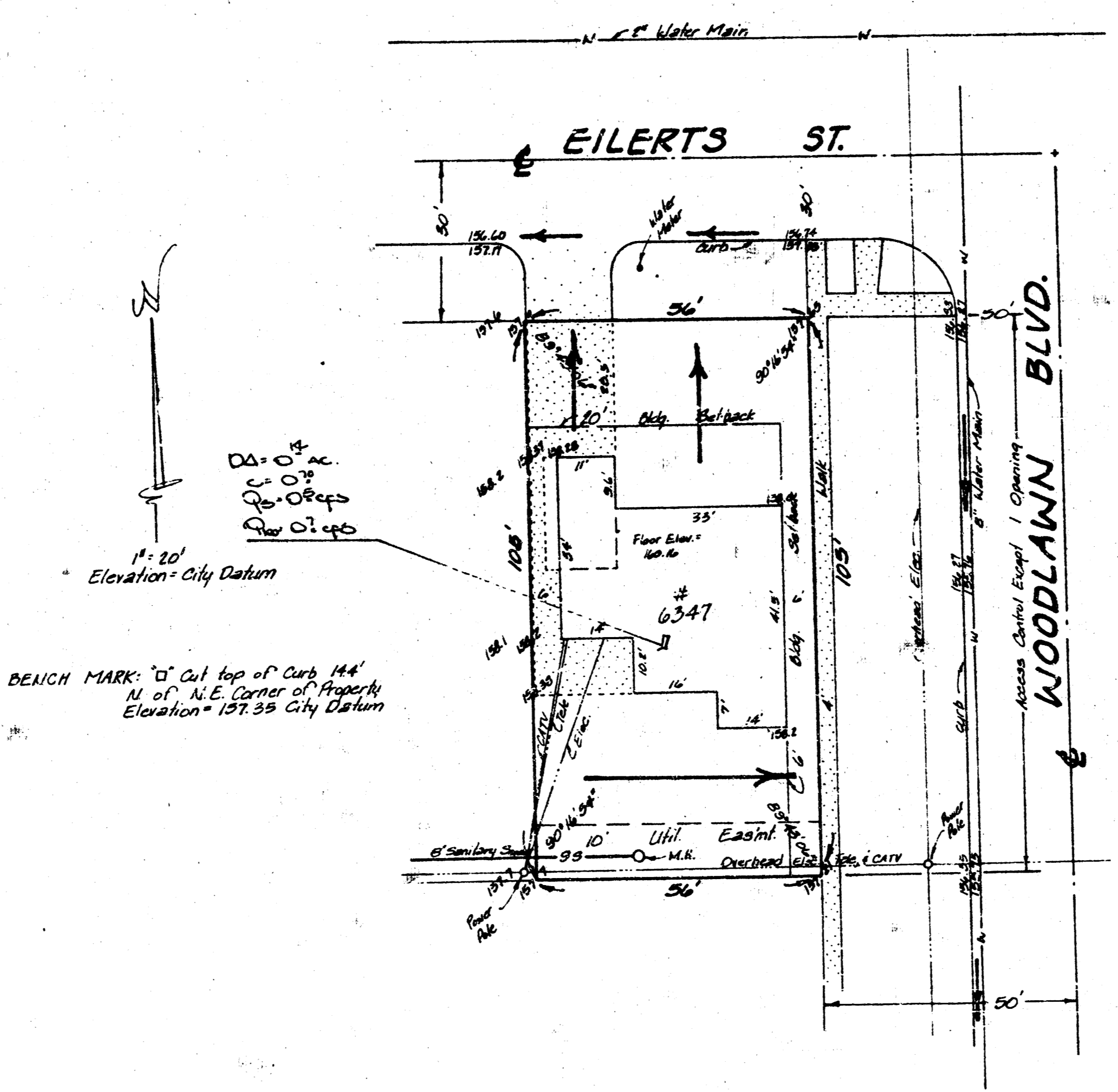

SKETCH PLAT

THURLOW ADDITION

REPLAT OF LOT 9, DENNISON ADDITION TO
WICHITA, SEDGWICK COUNTY, KANSAS

OWNER: JOHN FREDERICK THURLOW
PATRICIA A THURLOW

DRAINAGE PLAN

GENERAL NOTE
The proposed plat is being developed for office zoning usage.
Runoff from the lot will discharge to the adjacent streets.