

GENERAL NOTES

1. THE CONTRACTOR SHALL BE RESPONSIBLE FOR PRESERVING PROPERTY IRONS. THE CONTRACTOR SHALL BE REQUIRED TO RE-ESTABLISH ANY PROPERTY IRONS WHICH ARE DAMAGED OR DESTROYED BY HIS CONSTRUCTION OPERATIONS. SUCH IRONS SHALL BE RE-ESTABLISHED BY A LICENSED LAND SURVEYOR IN ACCORDANCE WITH STATE LAWS.
2. CONTRACTOR SHALL NOTIFY UTILITY COMPANIES OF CONSTRUCTION SCHEDULING.
3. EXISTING UTILITIES AND THEIR LOCATIONS, AS SHOWN ON THE PLANS REPRESENT THE BEST INFORMATION OBTAINABLE FOR DESIGN. LOCATION INFORMATION HAS BEEN OBTAINED FROM THE VARIOUS COMPANIES AND IS EITHER FROM COMPANY UTILITY DRAWINGS OR COMPANY PROVIDED FIELD LOCATIONS. THE PLAN LOCATIONS SHOWN ARE NOT GUARANTEED. ADDITIONAL EXISTING UTILITIES MAY ALSO BE ENCOUNTERED.
4. CONTRACTOR WILL BE REQUIRED TO PROVIDE A MINIMUM ADVANCE NOTICE OF SEVENTY-TWO (72) HOURS TO UTILITY COMPANIES PRIOR TO STARTING ANY EXCAVATION AS FOLLOWS:

KANSAS ONE-CALL 800-344-7233
OR 687-2470 (LOCAL WICHITA)

THE CONTRACTOR MUST NOTIFY THE FOLLOWING IN CASE OF EMERGENCY:

COX COMMUNICATIONS (CABLE)	262-0661
WESTAR (ELECTRIC)	261-6512
KANSAS GAS SERVICE (GAS)	832-3101
SBC (TELEPHONE)	800-870-8390
CITY OF WICHITA WATER & SEWER	262-6000
AQUILA (GAS)	946-0096

5. RUBBLE FROM THE REMOVAL OF MISCELLANEOUS STRUCTURES AND EXCESS EXCAVATION WHICH IS TO BE WASTED SHALL BE DISPOSED OF ON SITES TO BE PROVIDED BY THE CONTRACTOR. THESE SITES SHALL BE APPROVED BY THE ENGINEER AS TO SUITABILITY, APPEARANCE AND SITE LOCATION. LOCATIONS THAT, IN THE OPINION OF THE ENGINEER, WILL LEAVE AN UNSIGHTLY APPEARANCE WILL NOT BE APPROVED. ALL DISPOSAL SITES MUST BE APPROVED BY THE KANSAS DEPARTMENT OF HEALTH AND ENVIRONMENT. MATERIAL EITHER STOCKPILED OR DISPOSED OF IN A FLOOD PLAIN WOULD REQUIRE A KANSAS STATE BOARD OF AGRICULTURE PERMIT. ANY MATERIAL DUMPED IN WATERS OF THE UNITED STATES OR WETLANDS IS SUBJECT TO U.S. CORPS OF ENGINEERS PERMITTING REGULATIONS. ANY MATERIAL BURIED OR STOCKPILED BEYOND APPROVED CONSTRUCTION LIMITS WOULD REQUIRE ADDITIONAL ARCHAEOLOGICAL INVESTIGATIONS UNLESS BURIED IN A PREVIOUSLY APPROVED BORROW LOCATION.
6. ALL EARTHWORK COMPACTION SHALL BE 95% STANDARD DENSITY. CONTRACTOR SHALL PROVIDE TEST RESULTS TO CONFIRM COMPACTION.
7. OTHER PUBLIC IMPROVEMENT CONSTRUCTION PROJECTS MAY BE UNDER WAY SIMULTANEOUSLY. THE CONTRACTOR SHALL COORDINATE WITH ANY CONTRACTORS CONSTRUCTING OTHER PORTIONS OF THE PROJECT.
8. IF FILL MATERIAL RUNS SHORT OF AMOUNT NEEDED, ADDITIONAL EXCAVATION MAY BE TAKEN FROM POND CUTS ON SITE BY DEEPENING ONLY, OR MAY BE FURNISHED BY CONTRACTOR. COORDINATE WITH ENGINEER. COST SUBSIDIARY TO PROJECT.
9. CONTRACTOR SHALL SEED ALL DISTURBED AREAS AS NOTED. (REFER TO SHEET 7)
10. ALL EXISTING TRASH / DEBRIS WITHIN THE CONSTRUCTION AREAS SHALL BE REMOVED AND DISPOSED OF ON SITES PROVIDED BY THE CONTRACTOR. THESE SITES SHALL BE APPROVED BY THE ENGINEER AND MEET THE REQUIREMENTS OF NOTE 6 ABOVE. THIS SHALL BE CONSIDERED SUBSIDIARY TO SITE CLEARING AND RESTORATION.
11. IN PROPOSED RIGHT-OF-WAYS, CONTRACTOR SHALL LEAVE ROAD SUBGRADE TO WITHIN 0.1' OF FINAL GRADE FOR PAVING CONTRACTOR. CONTRACTOR SHALL VERIFY FINAL GRADES WITH ENGINEER PRIOR TO CONSTRUCTION.
12. CONTRACTOR SHALL COORDINATE TO PLACE SELECT MATERIAL WITHIN ROAD RIGHT OF WAYS. THIS MATERIAL SHALL BE APPROVED BY THE CITY ENGINEER PRIOR TO PLACEMENT.
13. SITE CLEARING AND RESTORATION SHALL BE SUBSIDIARY TO PROJECT.
14. OTHER PUBLIC IMPROVEMENT CONSTRUCTION PROJECTS MAY BE UNDER WAY SIMULTANEOUSLY. THE CONTRACTOR SHALL COORDINATE WITH ANY CONTRACTORS CONSTRUCTING OTHER PORTIONS OF THE PROJECT.
15. CONTRACTOR SHALL STOCKPILE EXCESS 1,450 C.Y. DIRT IN ADD ALTERNATE #1 LOCATION ALONG WESTLAKES PARKWAY.

GRADING PLANS FOR FOX RIDGE ADDITION

PHASE 2C-1
SWD #263
PROJECT NO 468-83997
OCA 751424

CITY OF WICHITA, KANSAS
JIM ARMOUR, CITY ENGINEER

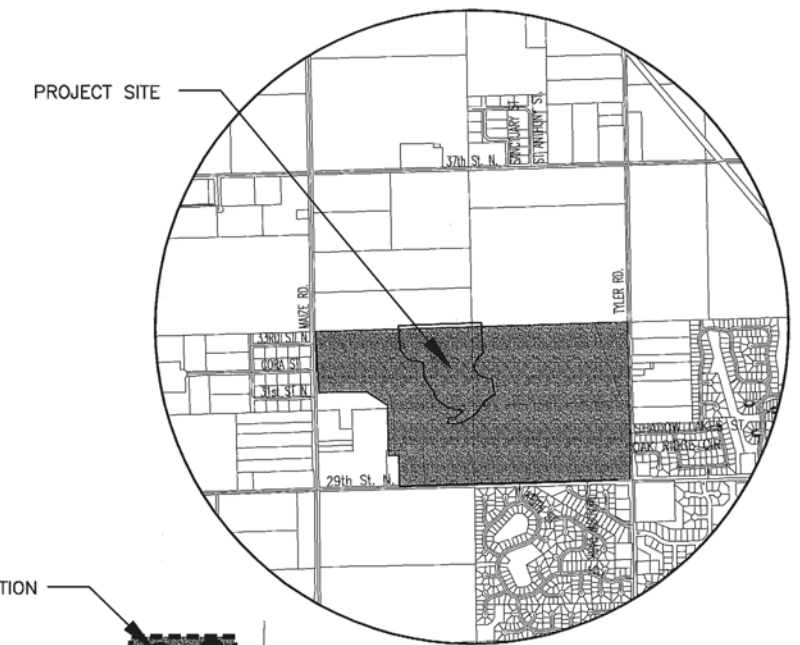

VICINITY MAP

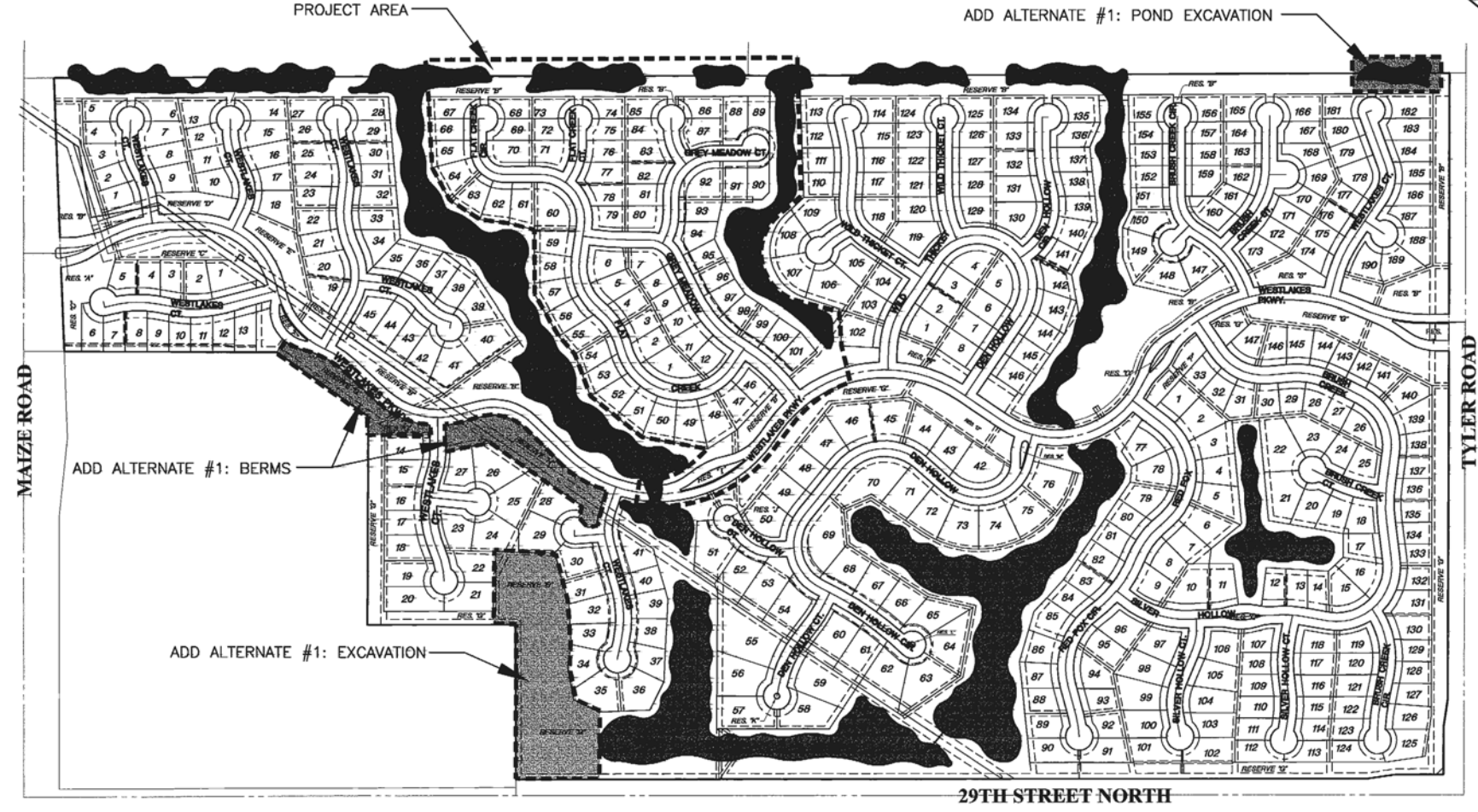

SITE MAP

INDEX TO DRAWINGS

SHEET NO.	DESCRIPTION
1	TITLE SHEET
2	BENEFIT DISTRICT AND BORING MAPS
3	GRADING DETAILS
4-5	GRADING PLANS
6	ADD ALTERNATE #1
7	EROSION CONTROL / SEEDING
8-11	BMP'S / EROSION CONTROL DETAILS
12	FINAL PLAT

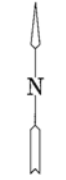

SCALE: 1" = 300'

EARTHWORK SUMMARY

PHASE 2C-1	
EXCAVATION	82,150 C.Y.
COMPACTED FILL (95% DENSITY)	80,700 C.Y.

NOTE: 20% HAS BEEN ADDED TO FILL QUANTITIES TO ALLOW FOR COMPACTION AND HANDLING.

**ADD ALTERNATE #1
EARTHWORK SUMMARY**

PHASE 2C-1	
EXCAVATION	14,820 C.Y.
BERMS (90% DENSITY)	14,800 C.Y.

NOTE: 15% HAS BEEN ADDED TO FILL QUANTITIES TO ALLOW FOR COMPACTION AND HANDLING.

MKEC
ENGINEERING CONSULTANTS, INC.
411 N. WEBB ROAD
WICHITA, KS. 67206
316-684-9600

JASON A. GRAY
LICENSED PROFESSIONAL LANDSCAPE ARCHITECT
No. 628
KANSAS

GRADING PLANS FOR PHASE 2C-1
FOX RIDGE ADDITION
 PROJECT NO 468-83997
 SWD #263

PH_TITLE
SHEET TITLE
9911B
PROJECT #

DBG
DESIGN BY
DBG
DRAWN BY
JAG
CHECKED BY

ISSUED
JUNE 21, 2006
REVISED
JUNE 27, 2006

SHEET NO.
1 of 12