

Scale: 1" = 60'

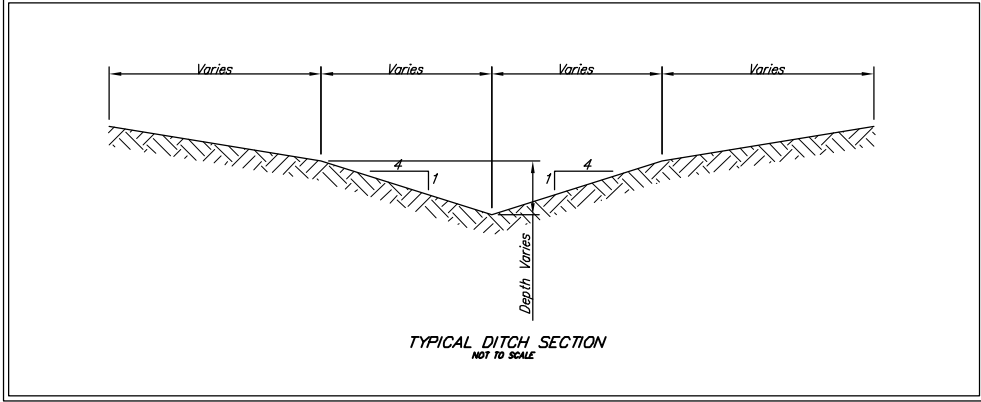
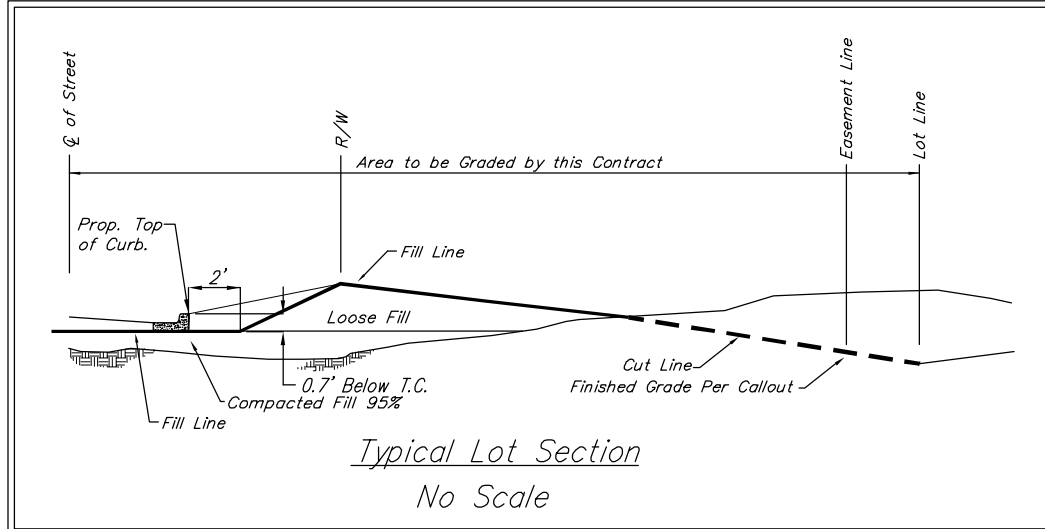

Legend:

- 185 Existing Grade
- Proposed Grade
- X X X X Silt Fence
- ~ ~ ~ ~ Cut-Off Trench
- U Ditch Checks

**EARTHWORK TOTALS**

	CY EXC	CY FILL
FF2&FF3	47,435	327,402
FF Comm	30,733	18,652
Mass Grading	78,168	346,054
Pond 1	19,478	1,767
Pond 2	25,689	1,852
Pond 3	19,650	2,024
Pond 4	38,118	3,550
Pond 5	230,309	2,947
POND5	333,244	12,140
<b>GRAND TOTAL</b>	<b>411,412</b>	<b>358,194</b>

**NOTES:**  
 Earthwork quantities are for reference only. All cost associated with mass grading shall be incidental to lump sum bid item "Mass Grading".  
 1. Contractor to strip top 3" of soil in areas of pond construction within Reserve "B", Falcon Falls 2nd Addition, and Reserves "C" & "D", Falcon Falls 3rd Addition and street R/W before mass grading and stockpile. Top soil stockpile to be redistributed over reserves above water surface.  
 2. Compaction of 95% standard proctor density shall be obtained in all street R/W's and within the 100-yr floodplain, 90% in all other areas.  
 3. It shall be the Contractor's responsibility to protect any existing utilities during mass grading. Any damage done to these systems by Contractor or subcontractor shall be repaired at no additional cost to the project.  
 4. Only trees within the street R/W or in areas of pond construction may be removed if necessary for grading. All other trees shall be protected from damage.  
 5. All areas disturbed by construction (except within street R/W) shall be seeded as indicated on Pond Plan.  
 6. Page 2: Area indicated by dashed heavy line is area that will have been filled with excess from Phase I mass grading project (separate project completed prior to this project) by the time this project is to commence. Exact quantities currently unknown, but is expected to be approximately 7,000 C.Y. over and above contours shown on this plan. Earthwork quantities for this project DO NOT account for this stockpile since exact quantity is unknown at time of project finalization.

Area to be graded

Install two construction entrances onto existing paved roadway per detail, sheet 32.

**Baughman** FALCON FALLS 2ND/3RD/COMM. ADD.  
**MASS GRADING PLAN**  
 STORM WATER DRAIN #275

Baughman Company, P.A. 315 Ellis St. Wilkes-Barre, PA 18702 P 316-662-7271 F 316-662-0149  
 ENGINEERING | SURVEYING | PLANNING | LANDSCAPE ARCHITECTURE

PROJECT NUMBER 468-84067	DESIGN AEG	DRAWN TMS
REVISIONS:	APPROVED	DATE 01/06
	SCALE Noted	
	SHEET	<b>7 of 39</b>

Falcon Falls 2nd/3rd/Comm. Add. 06-10-E-377