

NOTES:

1. Ponds 1 & 3: Pond bottom and sideslopes below static pool elevation shall be over-excavated 1' and a 1' clay liner shall be compacted to 95% standard proctor density. The plasticity index (P.I.) shall be at least 30. The compaction and P.I. shall be verified during construction. P.I. determination and compaction testing shall be arranged by the contractor at the request of the inspector. Cost shall be incidental to "Site Clearing & Restoration". Cost of over-excavation to install Clay Liner shall be incidental to bid item, "Excavation." Ponds 2, 4 & 5 are groundwater controlled and do not have clay liner.
2. Any excess excavation shall be stockpiled on-site at an area indicated by the Engineer out of easements and R/W. Area will be staked by Engineer. Additional area will be staked out if needed.
3. All of Reserve "B", Falcon Falls 2nd Addition, and Reserves "C" & "D", Falcon Falls 3rd Addition and areas of Pond #5 outside of Reserve "C" above the static water surface to a point 20' beyond the top of the slope shall be seeded and mulched as follows (excluding native seeding areas): (Permanent Seeding)
SEED -- Kansas Premium Fescue Blend; 8#/1000 Sq. Ft.
FERTILIZER -- 12-24-12 Ratio at 350 Lbs./Ac.
MULCH -- 2 Tons Prairie Hay / Acre

Native Seeding Areas: Areas of construction disturbing the creek sideslopes and natural vegetation around the creek including SWS Lines 3-5, north and south channel tie-in to Pond #5, any temporary creek crossing, and any natural areas adjacent to the creek disturbed by construction shall be seeded as follows

Shortgrass Prairie Mix at a rate of 10# PLS/Acre, available from Sharp Bros. Seed Company (Healy, KS), 1-800-462-8483.

Shortgrass Prairie Mix Seed Ratio
 40% Blue Grama
 25% Sharp's Improved Buffalograss-KN03
 35% Sideoats Grama

This area shall be fine graded and the surface shall be free of sticks, small stones, and other extraneous materials. Seeding areas shall be prepared for planting with common agricultural techniques (i.e., soil shall be prepared before planting with proper equipment). All seed shall be distributed with an acceptable drill intended for such operations or other equipment approved by the engineer. Seeding depth shall be 1/4". All disturbed areas shall be immediately mulched with prairie hay at 2 tons/ acres. Anchor mulch by crimping into topsoil with suitable mechanical equipment.

All other disturbed areas not in street R/W are to be seeded as follows: (Temporary seeding)
SEED -- Rye grass (PLS)--5#/1000 Sq. Ft. and
 Kansas Premium Fescue Blend; 5#/1000 Sq. Ft.

All costs associated with seeding, mulching, and fertilizing shall be included in bid item "Project Seeding." All seeding operations shall conform to City of Wichita Standard Specifications unless noted differently above.

4. Install Erosion Control Mat (Curlex II or approved equal) from 2' below the water surface to top bank.
5. Contractor to strip top 3" of soil in areas of pond construction within Reserve "B", Falcon Falls 2nd Addition, and Reserves "C" & "D", Falcon Falls 3rd Addition and street R/W before mass grading and stockpile. Top soil stockpile to be redistributed over reserves above water surface.
6. Compaction of 95% standard proctor density shall be obtained in all street R/W's and within the 100-yr floodplain, 90% in all other areas.

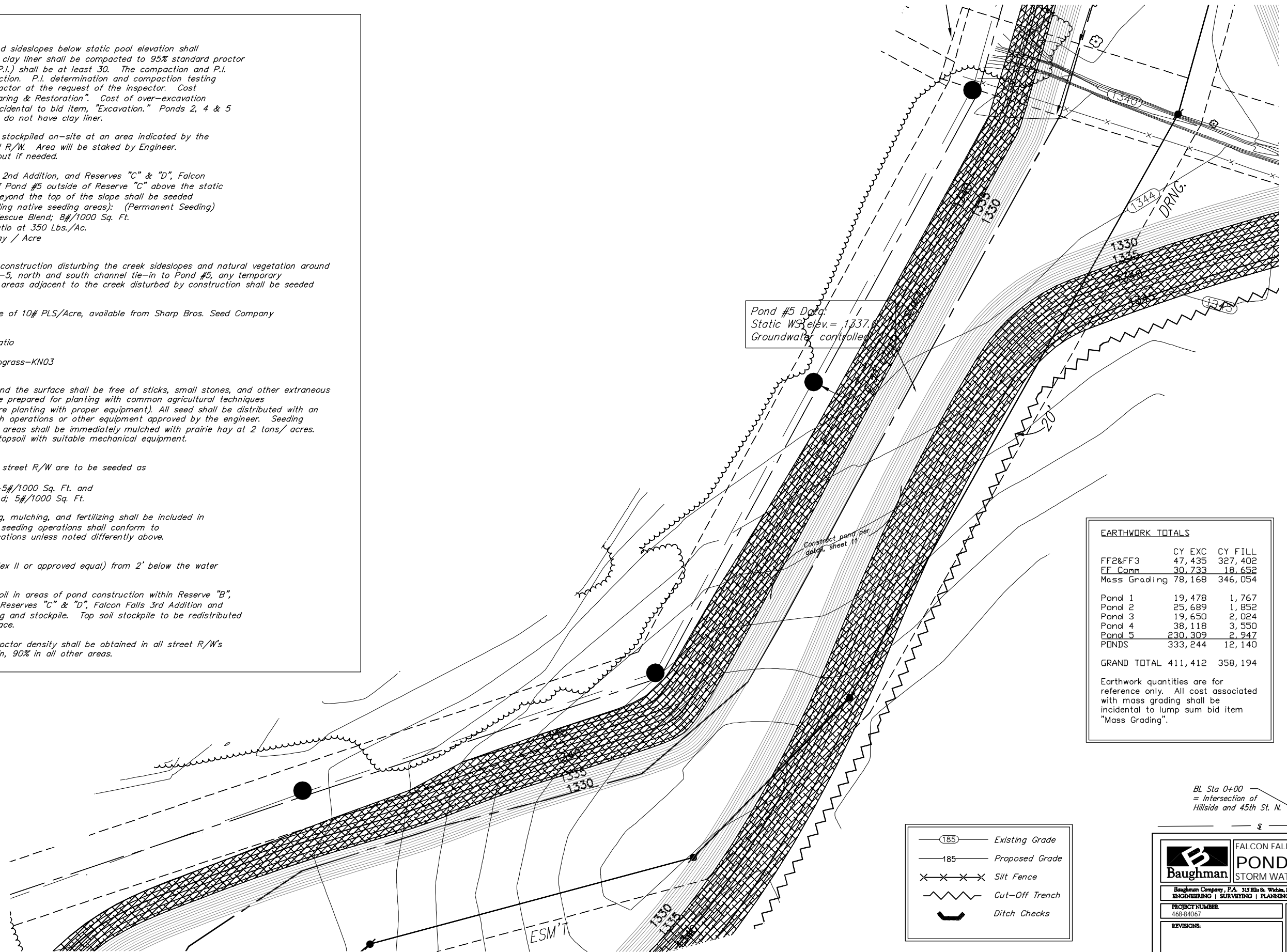

Pond #5 Data:
 Static WS Elev. = 1337.
 Groundwater controlled

Construct pond per detail, sheet 11

EARTHWORK TOTALS		
	CY EXC	CY FILL
FF2&FF3	47,435	327,402
FF Comm	30,733	18,652
Mass Grading	78,168	346,054
Pond 1	19,478	1,767
Pond 2	25,689	1,852
Pond 3	19,650	2,024
Pond 4	38,118	3,550
Pond 5	230,309	2,947
PONDS	333,244	12,140
GRAND TOTAL	411,412	358,194

Earthwork quantities are for reference only. All cost associated with mass grading shall be incidental to lump sum bid item "Mass Grading".

BL Sta 0+00
 = Intersection of Hillside and 45th St. N.

— 185 —	Existing Grade
— 185 —	Proposed Grade
× × × ×	Silt Fence
~ ~ ~ ~	Cut-Off Trench
U	Ditch Checks

Baughman FALCON FALLS 2ND/3RD/COMM. ADD.
POND #5
 STORM WATER DRAIN #275

Baughman Company, P.A. 313 W. St. Wichita, KS 67211 P 316-262-7271 F 316-262-0149
 ENGINEERING | SURVEYING | PLANNING | LANDSCAPE ARCHITECTURE

PROJECT NUMBER 468-84067	DESIGN AEG	DRAWN TMS
REVISIONS:	APPROVED	DATE 01/06
	SCALE Noted	SHEET 11 of 39

Falcon Falls 2nd/Pond 5 05-10-E-377