

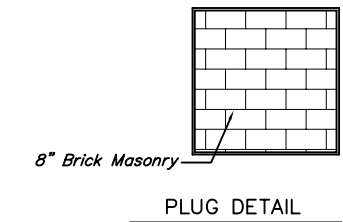

SCALE 1" = 20'

SYCAMORE POND ADDITION

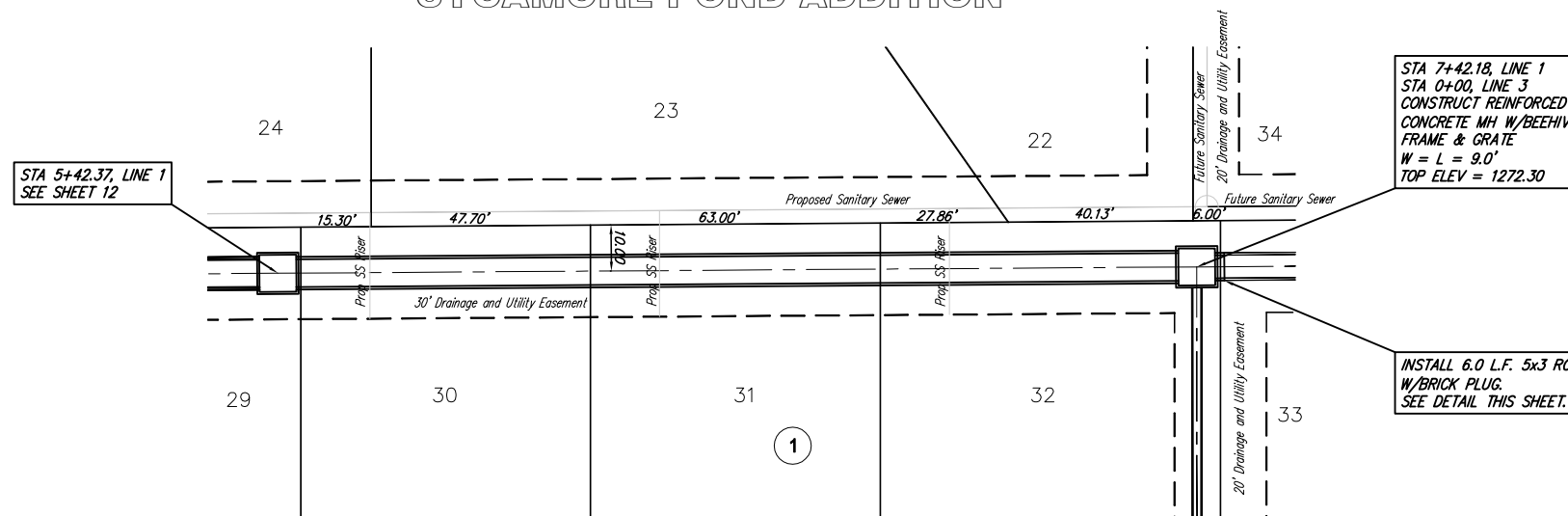

1. Mortar used in plug construction shall be in accordance with standard specifications.
2. All brick used in stack construction shall meet Grade ASTM C32 for MM and MS.
3. Pipe plugs shall be Subsidiary to the project.

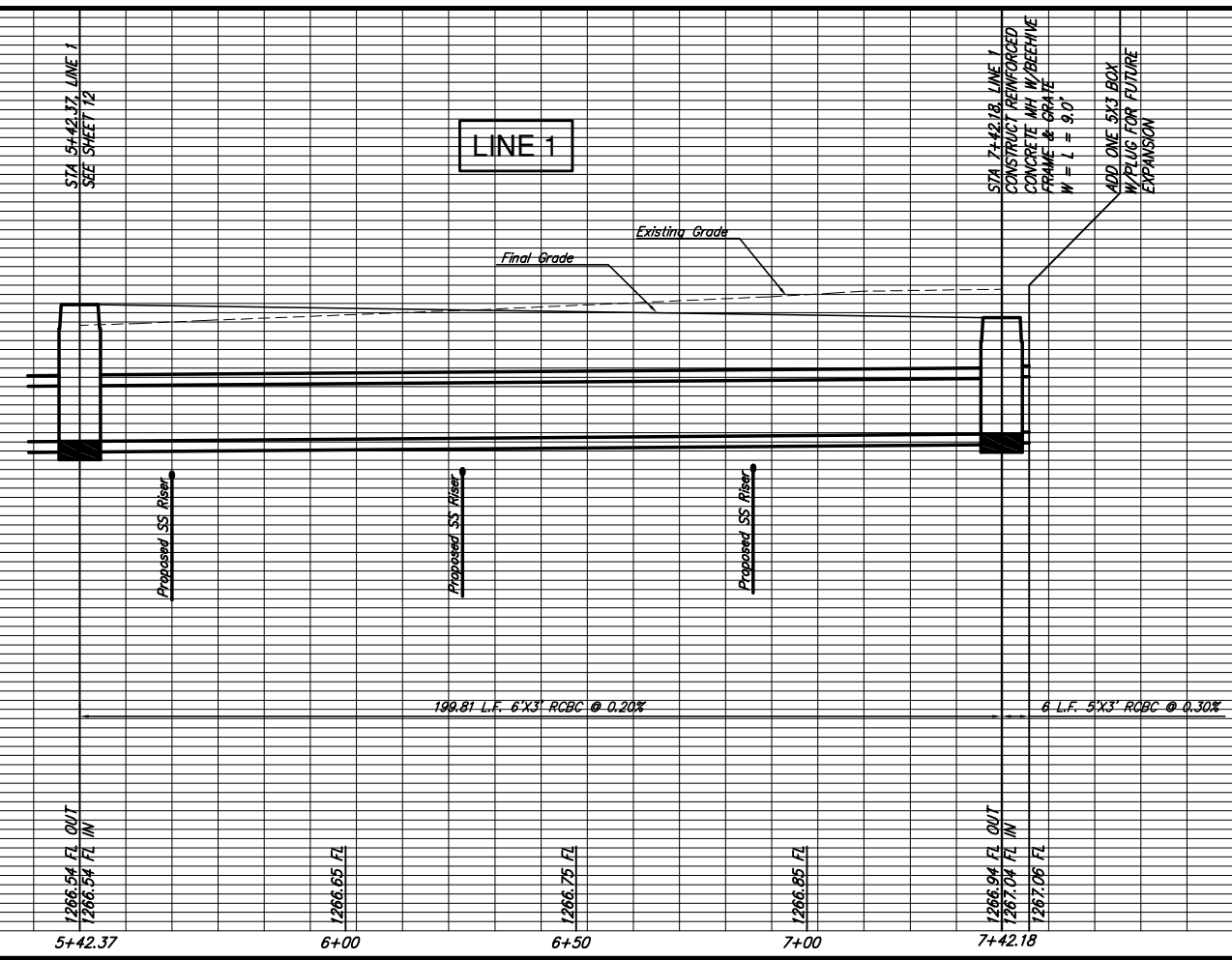

1275	DESIGN	EJG	REVIEW	DATE	June 23, 2006
1270	DRAWN	RLS	REVIEW	DATE	June 23, 2006
1265	PROJECT	468-84193	DRAWING FILE	UTILITY	SWS 1
1260	Sycamore Pond Addition SWS Line 1 WICHITA, KANSAS				

Ruggles & Bohm, P.A.
Engineering, Surveying, Land Planning

924 North Main
Wichita, Kansas 67203
www.rbkansas.com

(316) 264-8008
(316) 264-4621 fax
E-mail: info@rbkansas.com

RB JOB SHEET
2877E
13 OF 21