

BENCHMARKS:

"□" Top of curb, north return,
Northwest corner of 43rd and
Hydraulic.
Elev. = 82.33

Small Railroad Spike in West face of
Power Pole, East of 44th and
Hydraulic.
Elev. = 82.84

Railroad Spike in Light Pole,
Southwest corner of 45th and Victoria.
Elev. = 84.74

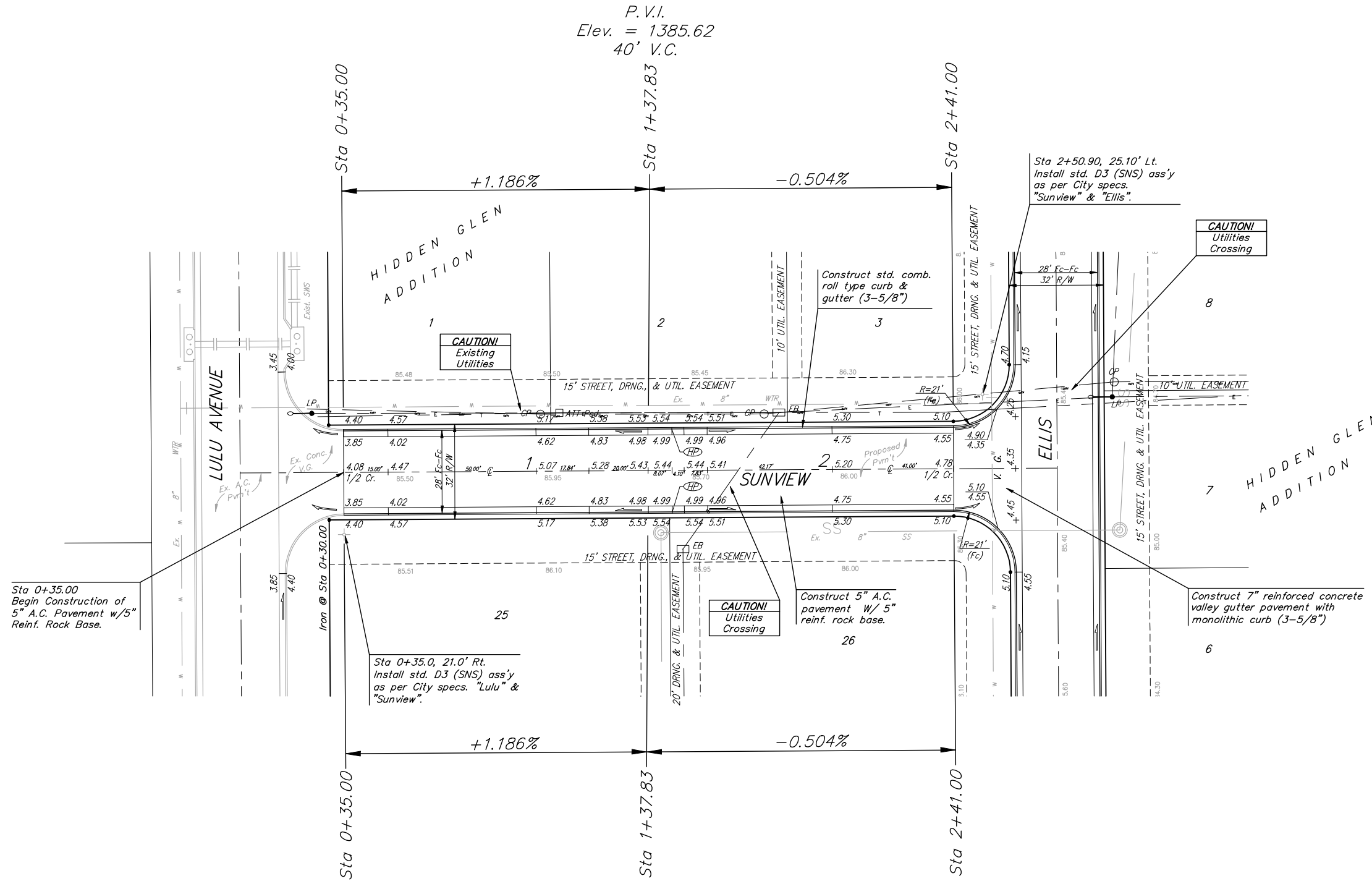
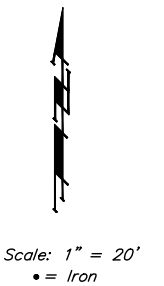

Sta 0+35.00
Begin Construction of
5" A.C. Pavement w/5"
Reinf. Rock Base.

Sta 0+35.0, 21.0' Rt.
Install std. D3 (SNS) ass'y
as per City specs. "Lulu" &
"Sunview".

Sta 2+50.90, 25.10' Lt.
Install std. D3 (SNS) ass'y
as per City specs.
"Sunview" & "Ellis".

Trees and shrubs in public right-of-way which are in
direct conflict with proposed new construction shall be
removed by the Contractor ONLY with the Developer or
Baughman Company approval. Trees and shrubs which
are not in direct conflict with proposed new construction
shall be saved and protected from damage.

NOTE: ROLL TYPE CURB & GUTTER TO
BE CONSTRUCTED ON THE
PAVEMENT SHOWN ON THIS SHEET.
TOP OF CURB ELEVATIONS ARE
GIVEN FOR FULL HEIGHT CURB.

Baughman		HIDDEN GLEN ADDITION - Ph. 2	
		Sunview	
		Street Paving	
Baughman Company, P.A. 315 Elm St. Wichita, KS 67211 P 316-262-7271 F 316-262-0149			
ENGINEERING SURVEYING PLANNING LANDSCAPE ARCHITECTURE			
PROJECT NUMBER 472-83626	DESIGN MWS	DRAWN JEB	
REVISIONS:	APPROVED	DATE 09/06	
	SCALE Noted	SHEET	
			5 OF 17
E:\eng\Hidden Glen Phs 2\wr1.dwg		06-03-E514	