

BENCHMARKS:

"□" Top of curb, north return,
Northwest corner of 43rd and
Hydraulic.
Elev. = 82.33

Small Railroad Spike in West face of
Power Pole, East of 44th and
Hydraulic.
Elev. = 82.84

Railroad Spike in Light Pole,
Southwest corner of 45th and Victoria.
Elev. = 84.74

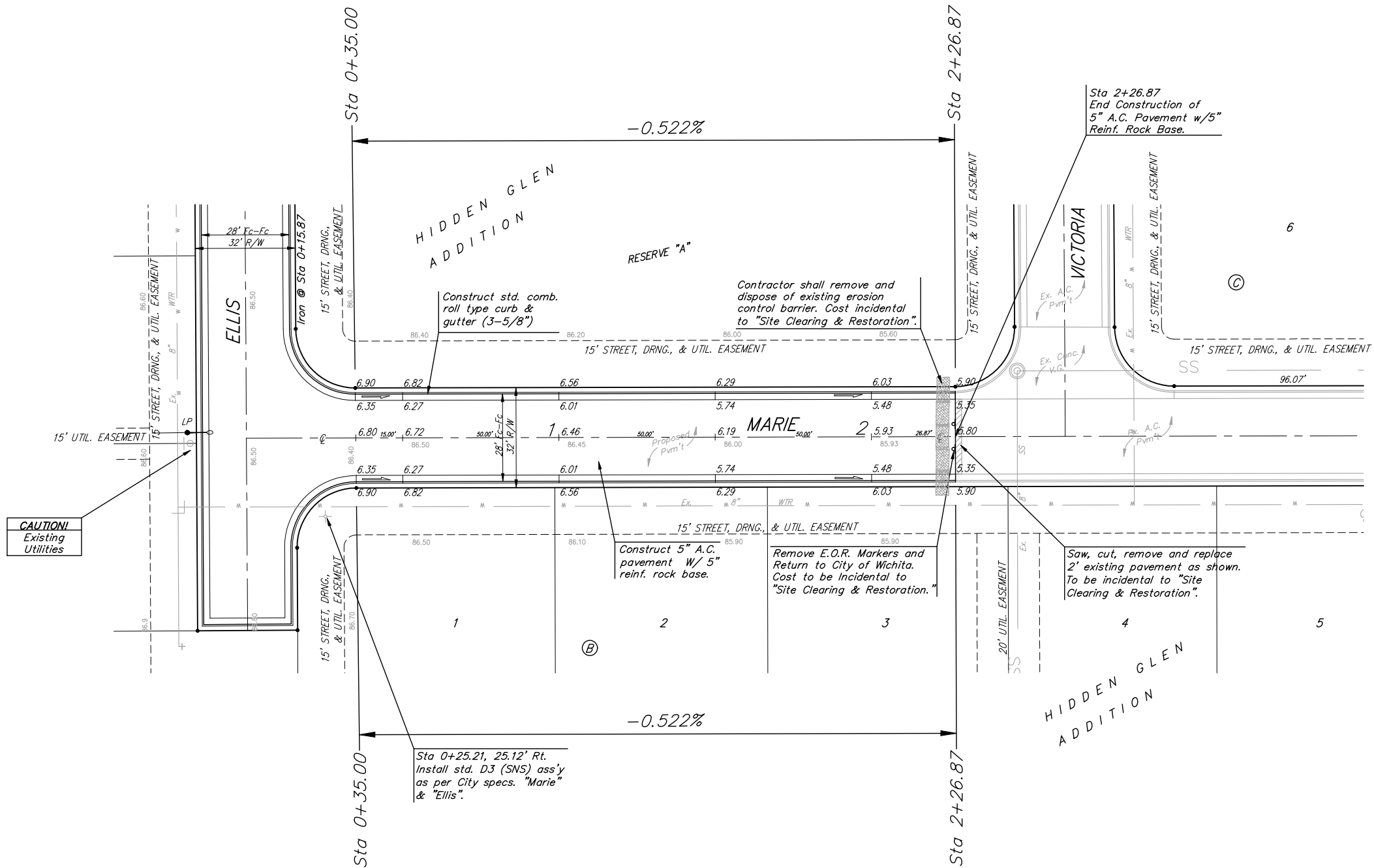
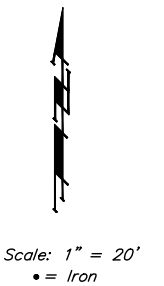

CAUTION!
Existing
Utilities

Sta 0+25.21, 25.12' Rt.
Install std. D3 (SNS) ass'y
as per City specs. "Marie"
& "Ellis".

Construct 5" A.C.
pavement w/ 5"
reinf. rock base.

Remove E.O.R. Markers and
Return to City of Wichita.
Cost to be incidental to
"Site Clearing & Restoration."

Saw, cut, remove and replace
2" existing pavement as shown.
To be incidental to "Site
Clearing & Restoration".

Construct std. comb.
roll type curb &
gutter (3-5/8")

Contractor shall remove and
dispose of existing erosion
control barrier. Cost incidental
to "Site Clearing & Restoration".

Sta 2+26.87
End Construction of
5" A.C. Pavement w/5"
Reinf. Rock Base.

Trees and shrubs in public right-of-way which are in direct conflict with proposed new construction shall be removed by the Contractor ONLY with the Developer or Baughman Company approval. Trees and shrubs which are not in direct conflict with proposed new construction shall be saved and protected from damage.

NOTE: ROLL TYPE CURB & GUTTER TO BE CONSTRUCTED ON THE PAVEMENT SHOWN ON THIS SHEET. TOP OF CURB ELEVATIONS ARE GIVEN FOR FULL HEIGHT CURB.

Baughman		HIDDEN GLEN ADDITION - Ph. 2	
		Marie Street Paving	
Baughman Company, P.A. 315 Ellis St. Wichita, KS 67211 P 316-262-7271 F 316-262-0149 ENGINEERING SURVEYING PLANNING LANDSCAPE ARCHITECTURE			
PROJECT NUMBER 472-83626	DESIGN MWS	DRAWN JEB	
REVISIONS:	APPROVED	DATE 09/06	
	SCALE Noted	SHEET	
			7 OF 17
E:\eng\Hidden Glen Phs 2\wr1.dwg		06-03-E514	