

BENCHMARKS:

BM #1: C.O.W. disc at SW corner of intersection.
 30.00'± S. of CL of 13th St. N.
 35.00'± W. of CL of 135th St. W.
 Elev. = 168.25 City Datum

BM #2: "□" Cut in Top of Curb
 10' South of end of Existing Pavement, East Curb adjacent to Lot 12, Block D, Copper Gate North Addition.
 Elev. = 174.73 City Datum

BM #3: BM Disc in top Curb Adjacent to Fire Hydrant at E. End of N. Curb Return of Kiwi & Decker.
 Elev. = 173.64 City Datum



Scale: 1" = 20'
 • = Iron

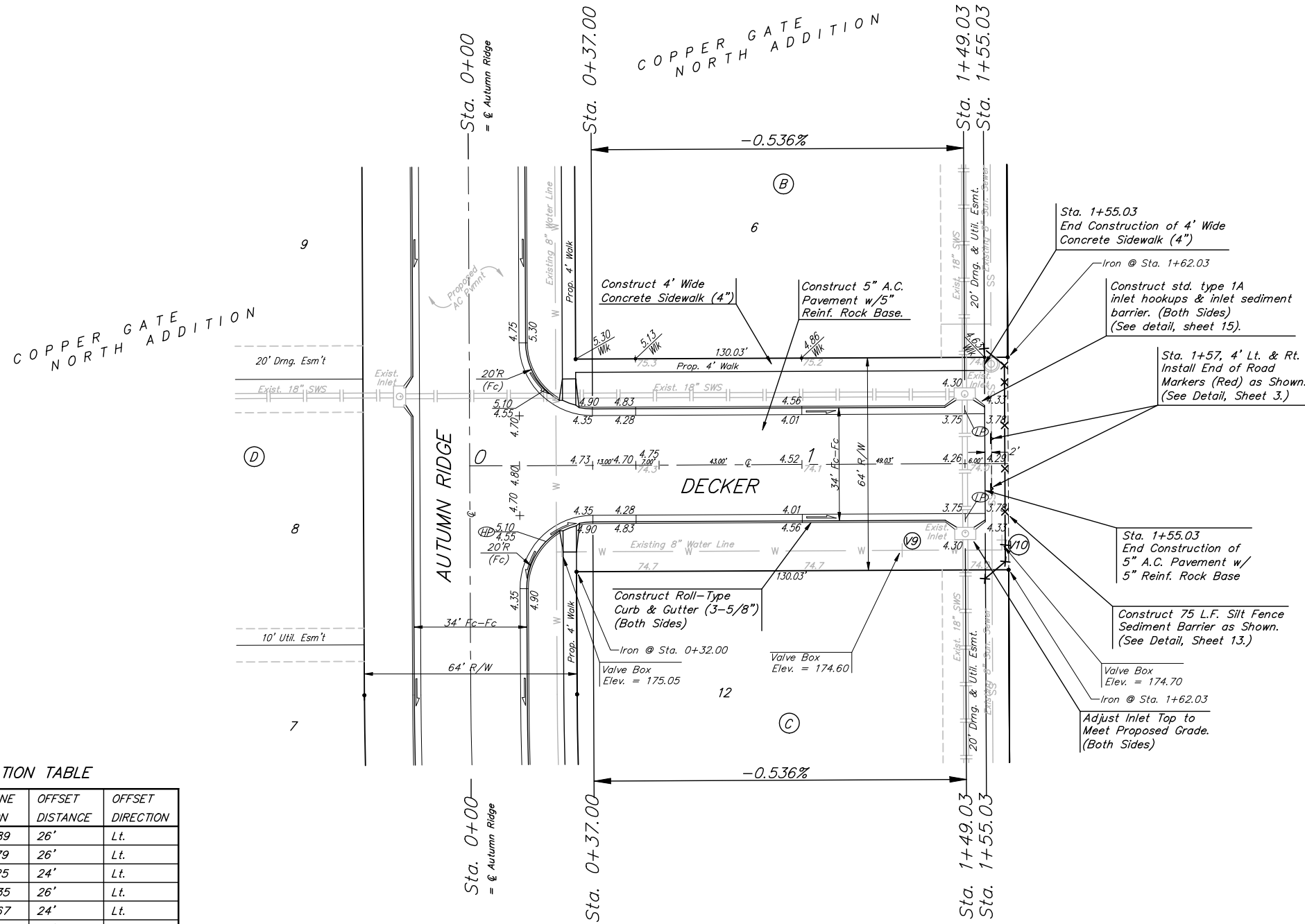

WATER VALVE LOCATION TABLE

VALVE NUMBER	STREET	BASELINE STATION	OFFSET DISTANCE	OFFSET DIRECTION
V1	Aksarben	0+22.89	26'	Lt.
V2	Autumn Ridge	1+83.79	26'	Lt.
V3	Autumn Ridge	1+95.25	24'	Lt.
V4	Autumn Ridge	5+04.35	26'	Lt.
V5	Autumn Ridge	6+72.67	24'	Lt.
V6	Autumn Ridge	13+55.74	24'	Lt.
V7	Autumn Ridge	0+02.00	26'	Lt.
V8	Autumn Ridge	0+27.00	26'	Lt.
V9	Decker	1+30.03	26'	Rt.
V10	Decker	1+60.03	26'	Rt.
V11	Kiwi	0+54.18	24.33'	Lt.
V12	Kiwi	5+71.40	26'	Lt.
V13	Kiwi	6+97.41	26'	Lt.

Paving contractor will be responsible to operate all water valves on the project, in the presence of the inspector, to ensure accessibility to the valves, and that all valves are left in the "ON" position when the project is completed.

Roll type curb & gutter to be constructed on the pavement on this sheet.
 Top of curb elevation are given for full height curb.

		Copper Gate North Addition - Phase II	
		DECKER STA. 0+00 TO STA. 1+55.03	
Baughman Company, P.A. 315 8th St. W. Wabash, IL 67211 P 3162627271 F 3162620149 ENGINEERING SURVEYING PLANNING LANDSCAPE ARCHITECTURE			
PROJECT NUMBER 472-84105	DESIGN NEW/JAK	DRAWN TMS	DATE 9/06/06
REVISIONS:	APPROVED	SCALE Noted	SHEET
			9 OF 23
Copper Gate North/Phase 2/Std			06-04-E526