

UTILITIES SHOWN REPRESENT THE BEST INFORMATION AVAILABLE FOR DESIGN. ADDITIONAL UTILITIES MAY BE PRESENT ON THIS PROJECT. THE CONTRACTOR SHALL BE RESPONSIBLE FOR DETERMINING THE EXACT LOCATION, DEPTH AND SIZE OF ALL UNDERGROUND UTILITIES PRIOR TO CONSTRUCTION. THE CONTRACTOR SHALL BE LIABLE FOR ANY DAMAGE CAUSED BY THE FAILURE TO DO SO.

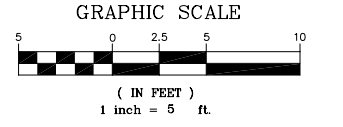

- = Proposed 5" A.C. Pavement on 5" Crushed Rock Base
- = Proposed Concrete Drives, Valley Gutters, Curb & Gutter, etc.

- UTILITY LEGEND**
- = Catv Box
  - = Guard Post/Bollard
  - = Guy Anchor
  - = Guy Pole
  - = Light Pole
  - = Mailbox
  - = Gas Meter
  - = Power Pole
  - = Sign
  - = San. Sewer Manhole
  - = Storm Sewer Manhole
  - = Telephone Riser
  - = Water Meter
  - = Water Valve
  - = Water Well
  - = Fire Hydrant
  - = Coniferous Tree
  - = Deciduous Tree
  - = Overhead Electric
  - = Gas Line
  - = Water Line

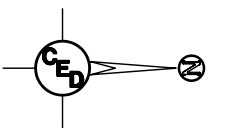
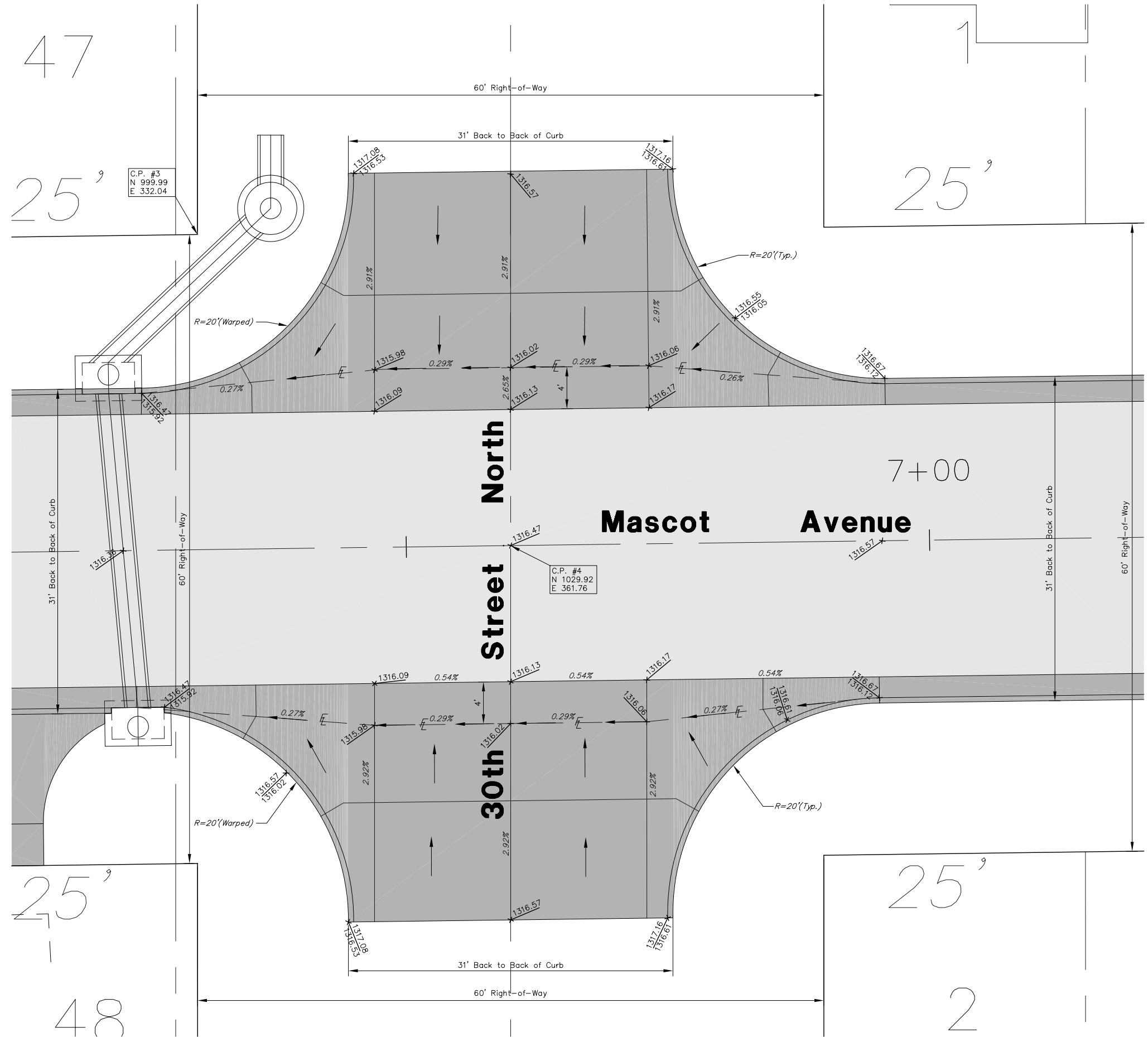

47

25'

25'

7+00

**Mascot Avenue**

**Street North**  
**30th**

25'

48

25'

2

**CURB & GUTTER STREET IMPROVEMENTS FOR MASCOT AVENUE**  
**MASCOT AVE. & 30TH ST. N. INTERSECTION PLAN**  
 WICHITA, KANSAS

PROJ. NO.: 472 84298

**CERTIFIED ENGINEERING DESIGN, P.A.**  
 810 WEST DOUGLAS, SUITE C  
 WICHITA, KANSAS 67203  
 PH.(316)262-8808 FAX.(316)262-1669

DESIGNED: HDF	SCALE: 1"=5'	SHEET
DRAWN: CKW	DATE: 3/06	7
CHECKED: HDF	CEP FILE: Mascot-Base	TOTAL 20