

BENCHMARKS:

BM #1: "□" on west end of median approx. 1020' west of intersection of Hillside and 45th St. N.
Elev. = 1348.19 MSL

BM #2: Iron at SW Corner of the SE 1/4, Section 22, Township 26-S, R-1-E.
Elev. = 1345.64 MSL

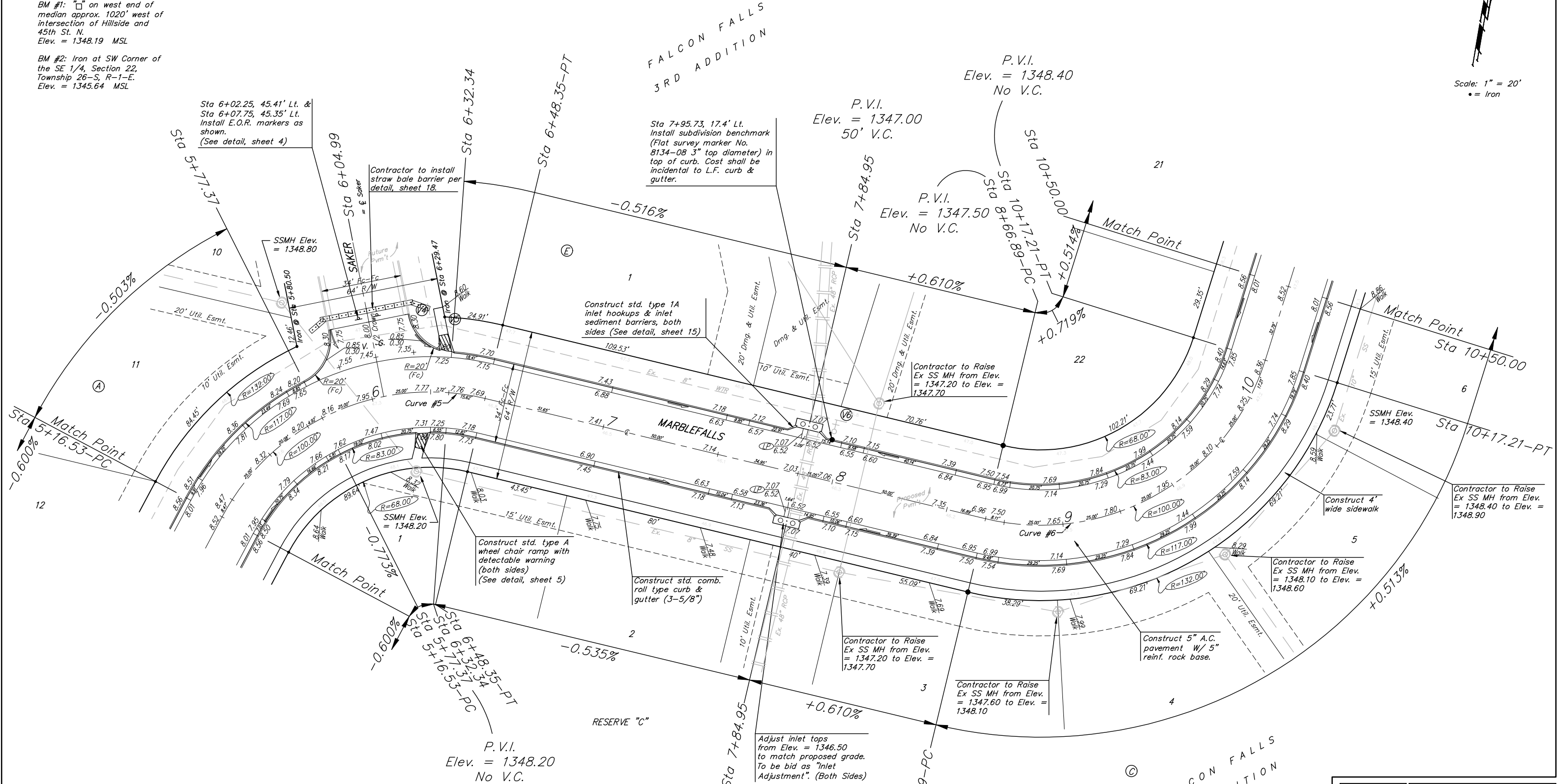

Subdivision Bench Marks		
Street & Station	Location Description	Elevation
Marblefalls 2+73.93, 37' Lt.	Adjacent to Fire Hydrant at W. End of N. Curb Return of Marblefalls & Marblefalls Ct. (Lots 4-12, Block A)	
Marblefalls 7+95.73, 17.4' Lt.	Adjacent to Fire Hydrant at the west lot line of Lot 22, Block A, Falcon Falls 3rd Addition	
Marblefalls 13+89.24, 17.4' Lt.	Adjacent to Fire Hydrant at S. End of SW Curb Return of Marblefalls & Hobby	
Mantane 1+55.41, 17.4' Rt.	Adjacent to Fire Hydrant at the west lot line of Lot 2, Block D, Falcon Falls 3rd Addition	

** See Sheet 12 for Curve Tables

Baughman		FALCON FALLS 3RD ADD. - PH. 1	
		MARBLEFALLS	
		Sta. 5+16.63 to 10+50.00	
Baughman Company, P.A. 315 8th St. W. Wash. DC 20001 P 3162627271 F 3162620149			
ENGINEERING SURVEYING PLANNING LANDSCAPE ARCHITECTURE			
PROJECT NUMBER 472-84624	DESIGN ITW	DRAWN JEB	
REVISIONS:	APPROVED ABC	DATE 08/06	
	SCALE Noted	SHEET	
			7 OF 32

NOTE: ROLL TYPE CURB & GUTTER TO BE CONSTRUCTED ON THE PAVEMENT SHOWN ON THIS SHEET. TOP OF CURB ELEVATIONS ARE GIVEN FOR FULL HEIGHT CURB.