

BENCHMARKS:

BM #1: "□" on west end of median approx. 1020' west of intersection of Hillside and 45th St. N.
Elev. = 1348.19 MSL

BM #2: Iron at SW Corner of the SE 1/4, Section 22, Township 26-S, R-1-E.
Elev. = 1345.64 MSL

P.V.I.
Elev. = 1350.80
No V.C.

P.V.I.
Elev. = 1352.50
50' V.C.

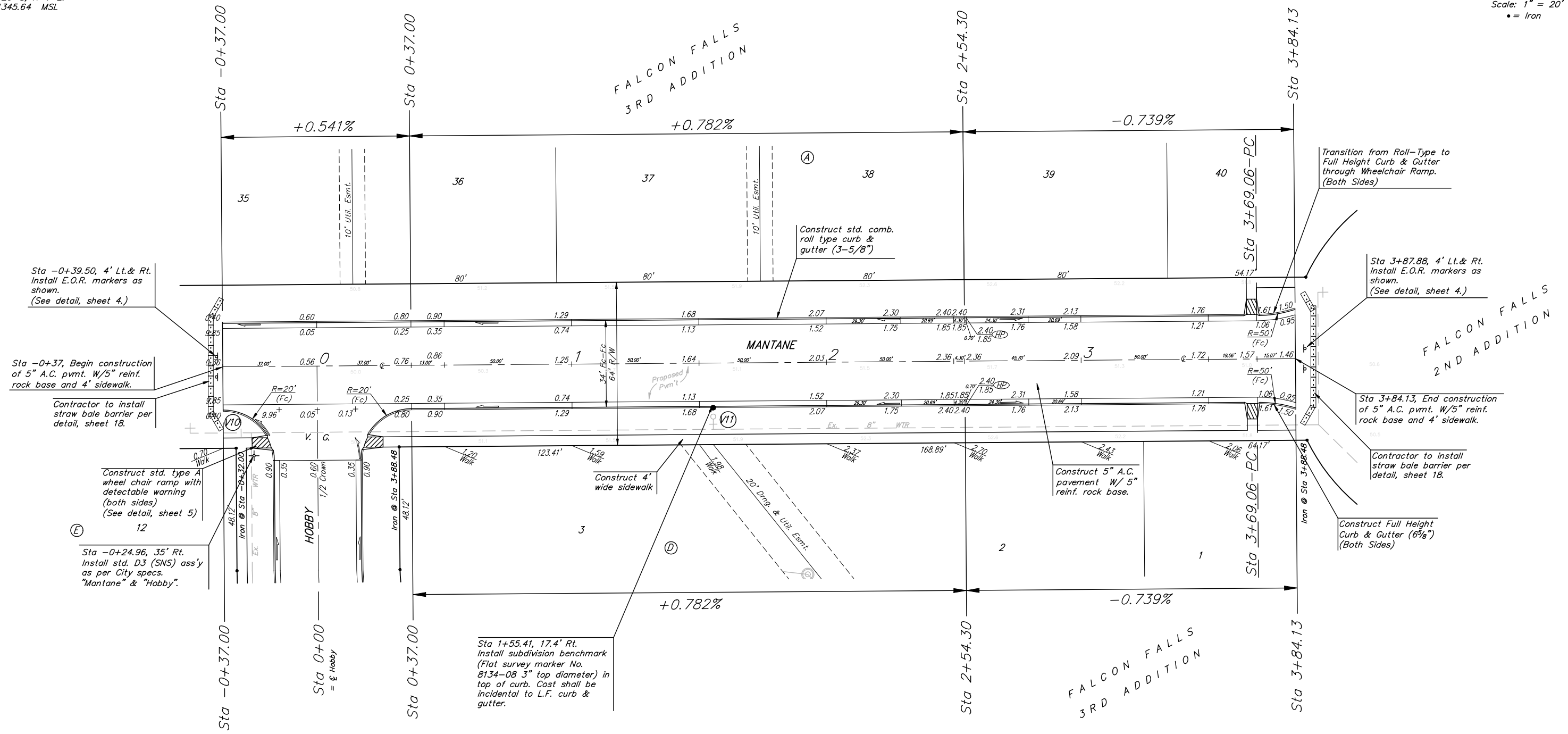
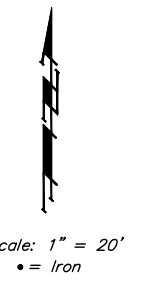

P.V.I.
Elev. = 1352.50
50' V.C.

NOTE: ROLL TYPE CURB & GUTTER TO BE CONSTRUCTED ON THE PAVEMENT SHOWN ON THIS SHEET. TOP OF CURB ELEVATIONS ARE GIVEN FOR FULL HEIGHT CURB.

		FALCON FALLS 3RD ADD. - PH. 1	
MANTANE			
Baughman Company, P.A. 315 8th St. W. Minn. 55 67211 P 3162627271 F 3162620149			
ENGINEERING SURVEYING PLANNING LANDSCAPE ARCHITECTURE			
PROJECT NUMBER 472-84624	DESIGN ITW	DRAWN JEB	
REVISIONS:	APPROVED ABC	DATE 08/06	
	SCALE Noted		
	SHEET	11 OF 32	
E:\Falcon Falls 3rd\SW & STR\Str1.dwg		05-12-B445	