

CURVE #3

Curve Data Based on Centerline
 Rad. = 207' Delta = 90°27'00" Tangent = 208.63'
 Arc = 326.78' L.C. = 293.89' Def/Ft. = 8.30375 Min.

FACE CHORD LENGTHS						
Station	Arc	8 Lt.	8 Rt.	Defl.	T. Defl.	
7+21.87	-	-	-	0°00'00"	0°00'00"	
7+25.00	3.13'	2.75'	3.51'	0°25'59"	0°25'59"	
7+50.00	25.00'	21.97'	28.00'	3°27'35"	3°3'35"	
7+75.00	25.00'	21.97'	28.00'	3°27'35"	7°21'10"	
8+00.00	25.00'	21.97'	28.00'	3°27'35"	10°48'46"	
8+25.00	25.00'	21.97'	28.00'	3°27'35"	14°16'22"	
8+50.00	25.00'	21.97'	28.00'	3°27'35"	17°43'57"	
8+75.00	25.00'	21.97'	28.00'	3°27'35"	21°11'33"	
9+00.00	25.00'	21.97'	28.00'	3°27'35"	24°39'09"	
9+25.00	25.00'	21.97'	28.00'	3°27'35"	28°06'44"	
9+50.00	25.00'	21.97'	28.00'	3°27'35"	31°34'20"	
9+75.00	25.00'	21.97'	28.00'	3°27'35"	35°01'55"	
10+00.00	25.00'	21.97'	28.00'	3°27'35"	38°29'31"	
10+25.00	25.00'	21.97'	28.00'	3°27'35"	41°57'06"	
10+48.65	23.65'	20.78'	26.49'	3°16'23"	45°15'29"	

Subdivision Bench Marks

No.	Street and Station	From CL	Description	Elevation
3	Emerald Bay, Sta. 10+48.65	17.50' Lt.	PT on the south side of Emerald Bay.	

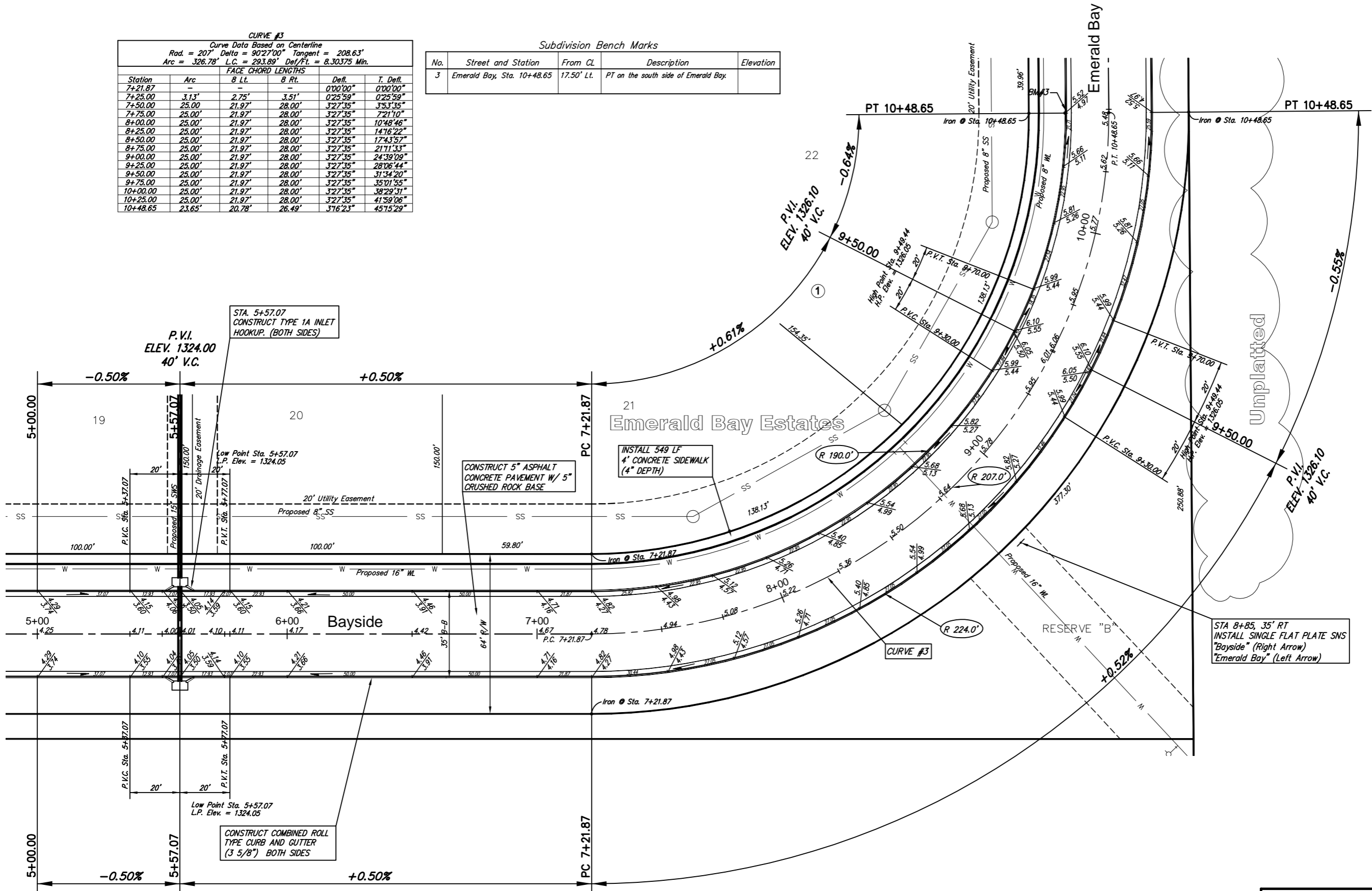

Unplatted

STA 8+85, 35' RT
 INSTALL SINGLE FLAT PLATE SNS
 "Bayside" (Right Arrow)
 "Emerald Bay" (Left Arrow)

NOTE: ROLL TYPE CURB AND GUTTER TO BE CONSTRUCTED ALONG PAVEMENT DEPICTED ON THIS SHEET

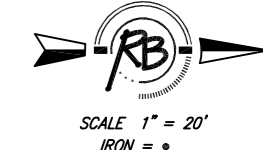

Emerald Bay Estates Addition - Phase 1, Paving Improvements
Bayside - Emerald Bay
 WICHITA, KANSAS

Ruggles & Bohm, P.A.
 Engineering, Surveying, Land Planning

924 North Main
 Wichita, Kansas 67203
 www.rbkansas.com

(316) 264-8008
 (316) 264-4621 fax
 E-mail: info@rbkansas.com

DESIGN: AML
 DRAWN: MLP
 REVIEW: []
 UTILITY: []

DRAWING FILE: paving {Bayside-Emerald}
 PROJECT NUMBER: 472-84364
 DATE: Jan. 17, 2006

SHEET: 5 OF 54