

Subdivision Bench Marks

No.	Street and Station	From CL	Description	Elevation
8	Emerald Bay, Sta. 34+97.54	17.50' Lt.	PT on the east side of Emerald Bay.	

CURVE #5
 Curve Data Based on Centerline
 Rad. = 232' Delta = 43°25'28" Tangent = 92.38'
 Arc = 167.73' L.C. = 171.65' Def/Pt. = 7.76685 Min.

Station	Arc	FACE CHORD LENGTHS		Defl.	T. Defl.
		8 Lt.	8 Rt.		
33+29.81	-	-	-	0°00'00"	0°00'00"
33+50.00	20.19'	18.88'	23.44'	2°36'49"	2°36'49"
33+75.00	25.00'	23.37'	29.02'	3°14'10"	5°50'59"
34+00.00	25.00'	23.37'	29.02'	3°14'10"	9°05'09"
34+25.00	25.00'	23.37'	29.02'	3°14'10"	12°19'19"
34+50.00	25.00'	23.37'	29.02'	3°14'10"	15°33'29"
34+75.00	25.00'	23.37'	29.02'	3°14'10"	18°47'39"
34+97.54	22.54'	21.07'	26.16'	2°53'04"	21°42'43"

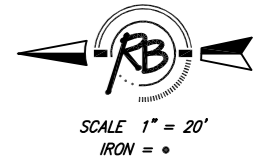
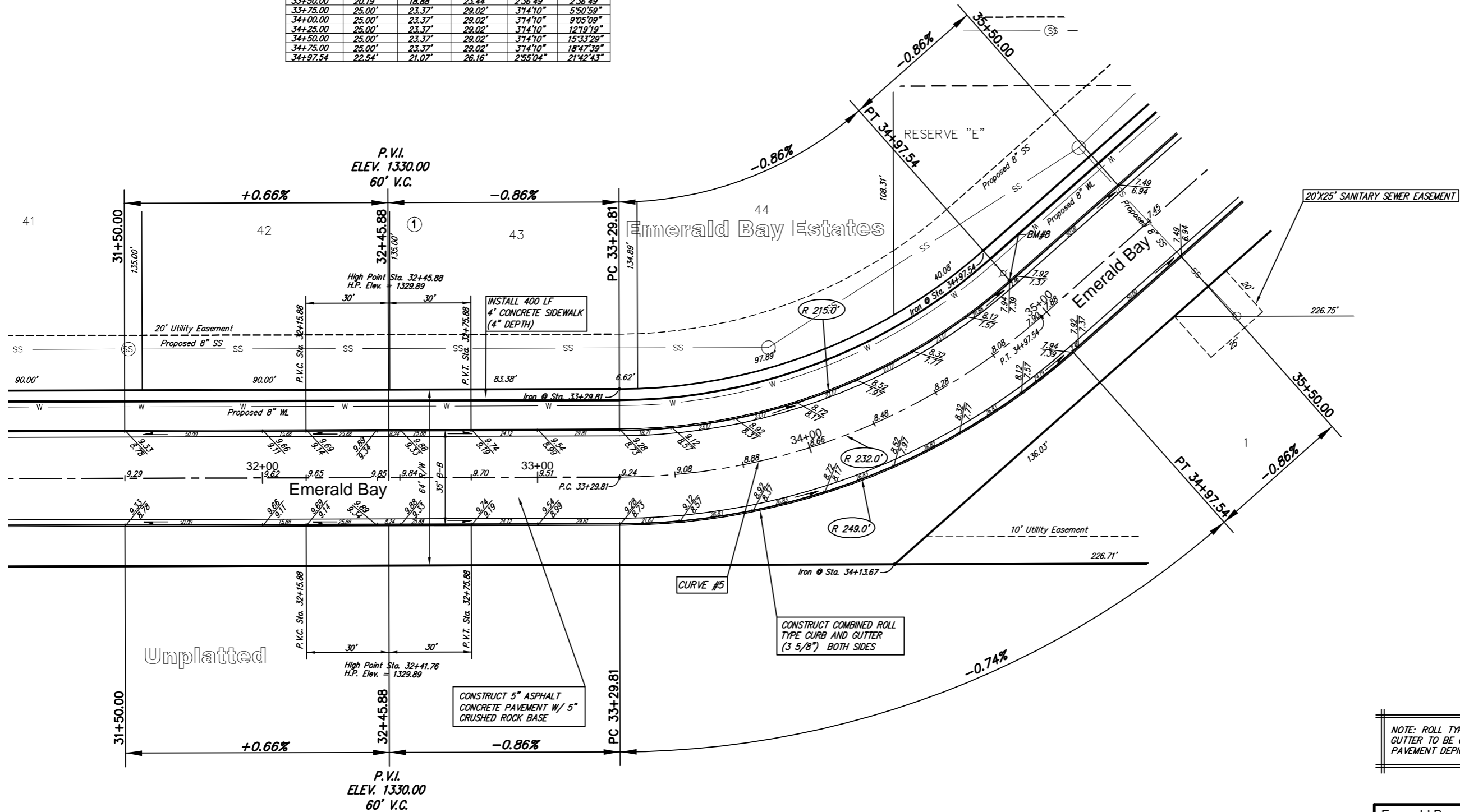

NOTE: ROLL TYPE CURB AND GUTTER TO BE CONSTRUCTED ALONG PAVEMENT DEPICTED ON THIS SHEET

Emerald Bay Estates Addition - Phase 1, Paving Improvements
Emerald Bay
 WICHITA, KANSAS

Ruggles & Bohm, P.A.
 Engineering, Surveying, Land Planning

924 North Main
 Wichita, Kansas 67203
 www.rbkansas.com

(316) 264-8008
 (316) 264-4621 fax
 E-mail: info@rbkansas.com

DESIGN: AML
 DRAWN: MLP
 REVIEW: []
 UTILITY: []

DRAWING FILE: paving {Emerald 6}
 PROJECT NUMBER: 472-84364
 DATE: Jan. 17, 2006

SHEET: 10 OF 54