

**CURVE #7**  
Curve Data Based on Centerline  
Rad. = 300' Delta = 18°47'49" Tangent = 49.66'  
Arc = 98.42' L.C. = 97.98' Def/Ft. = 5.72961 Min.

Station	Arc	FACE CHORD LENGTHS	B Lt.	B Rt.	Def.	T. Def.
40+00.00	-	-	-	-	0'00"00"	0'00"00"
40+25.00	25.00'	23.16'	26.83'	22'3"14"	2'23"14"	2'23"14"
40+50.00	25.00'	23.16'	26.83'	22'3"14"	4'46"29"	4'46"29"
40+75.00	25.00'	23.16'	26.83'	22'3"14"	7'09"43"	7'09"43"
40+98.42	23.42'	21.70'	25.13'	2'14"11"	9'23"54"	9'23"54"

**CURVE #8**  
Curve Data Based on Centerline  
Rad. = 300' Delta = 18°47'49" Tangent = 49.66'  
Arc = 98.42' L.C. = 97.98' Def/Ft. = 5.72961 Min.

Station	Arc	FACE CHORD LENGTHS	B Lt.	B Rt.	Def.	T. Def.
40+98.42	-	-	-	-	0'00"00"	0'00"00"
41+00.00	1.58'	1.70'	1.46'	0'09"03"	0'09"03"	0'09"03"
41+25.00	25.00'	26.83'	23.16'	2'23"14"	2'32'17"	2'32'17"
41+50.00	25.00'	26.83'	23.16'	2'23"14"	4'55'31"	4'55'31"
41+96.84	46.84'	50.22'	43.36'	4'28'22"	9'23'53"	9'23'53"

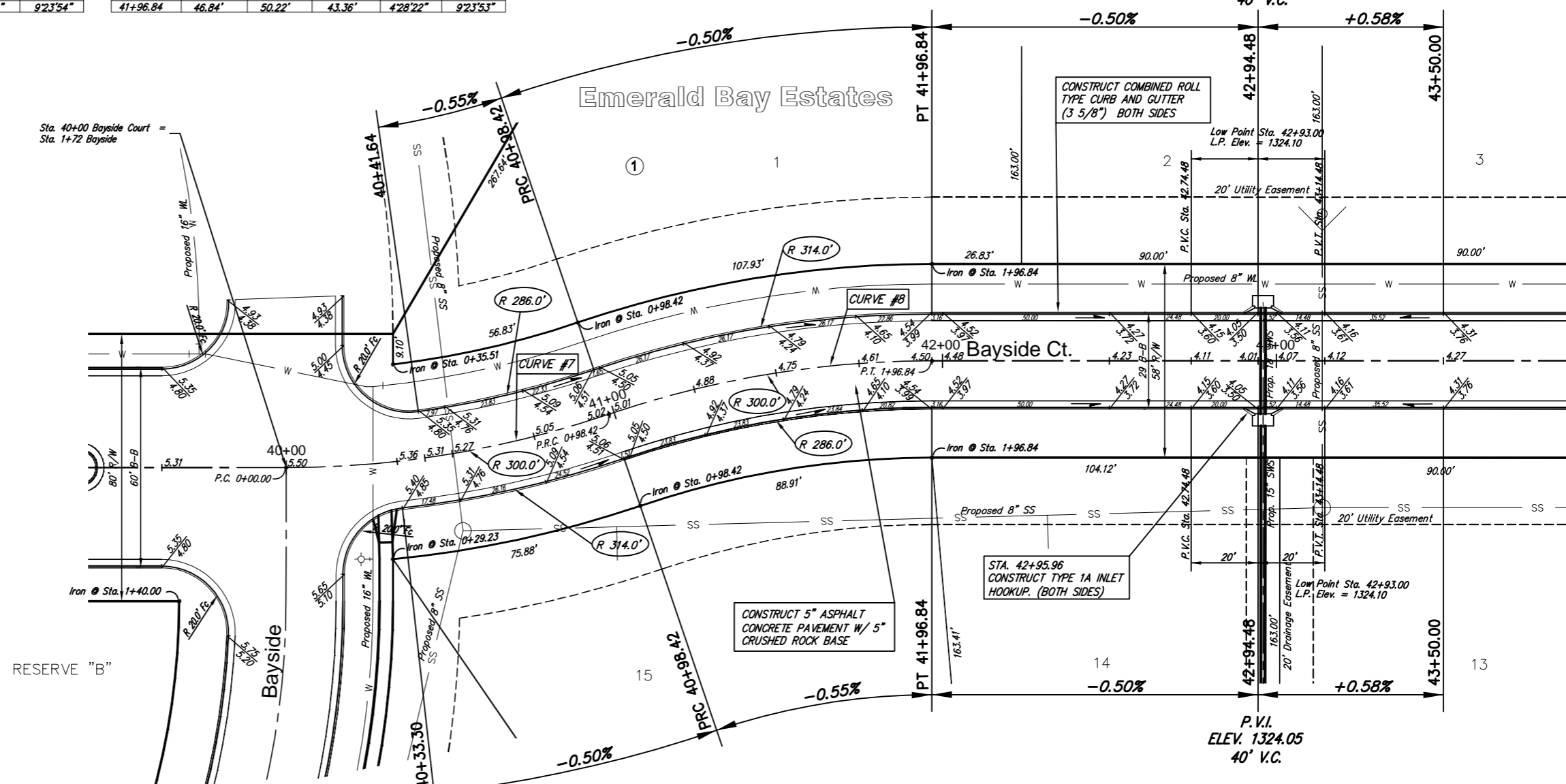

NOTE: ROLL TYPE CURB AND GUTTER TO BE CONSTRUCTED ALONG PAVEMENT DEPICTED ON THIS SHEET



**Emerald Bay Estates Addition - Phase 1, Paving Improvements**  
**Bayside Court**  
**WICHITA, KANSAS**

**Ruggles & Bohm, P.A.**  
Engineering, Surveying, Land Planning  
924 North Main  
Wichita, Kansas 67203  
www.rbkansas.com  
(316) 264-8008  
(316) 264-4621 fax  
E-mail: info@rbkansas.com

DESIGN: AML  
DRAWN: MLP  
REVIEW: [ ]  
UTILITY: [ ]  
DATE: Jan. 17, 2006

DRAWING FILE: paving {Bayside Circle 1}  
PROJECT NUMBER: 472-84364

SHEET: 12 OF 54