

Subdivision Bench Marks

No.	Street and Station	From CL	Description	Elevation
1	Triple Crown, Sta. 8+08.86	14.50' Rt.	S.E. End of Curb Return Int. of Mt. Vernon and Triple Crown.	

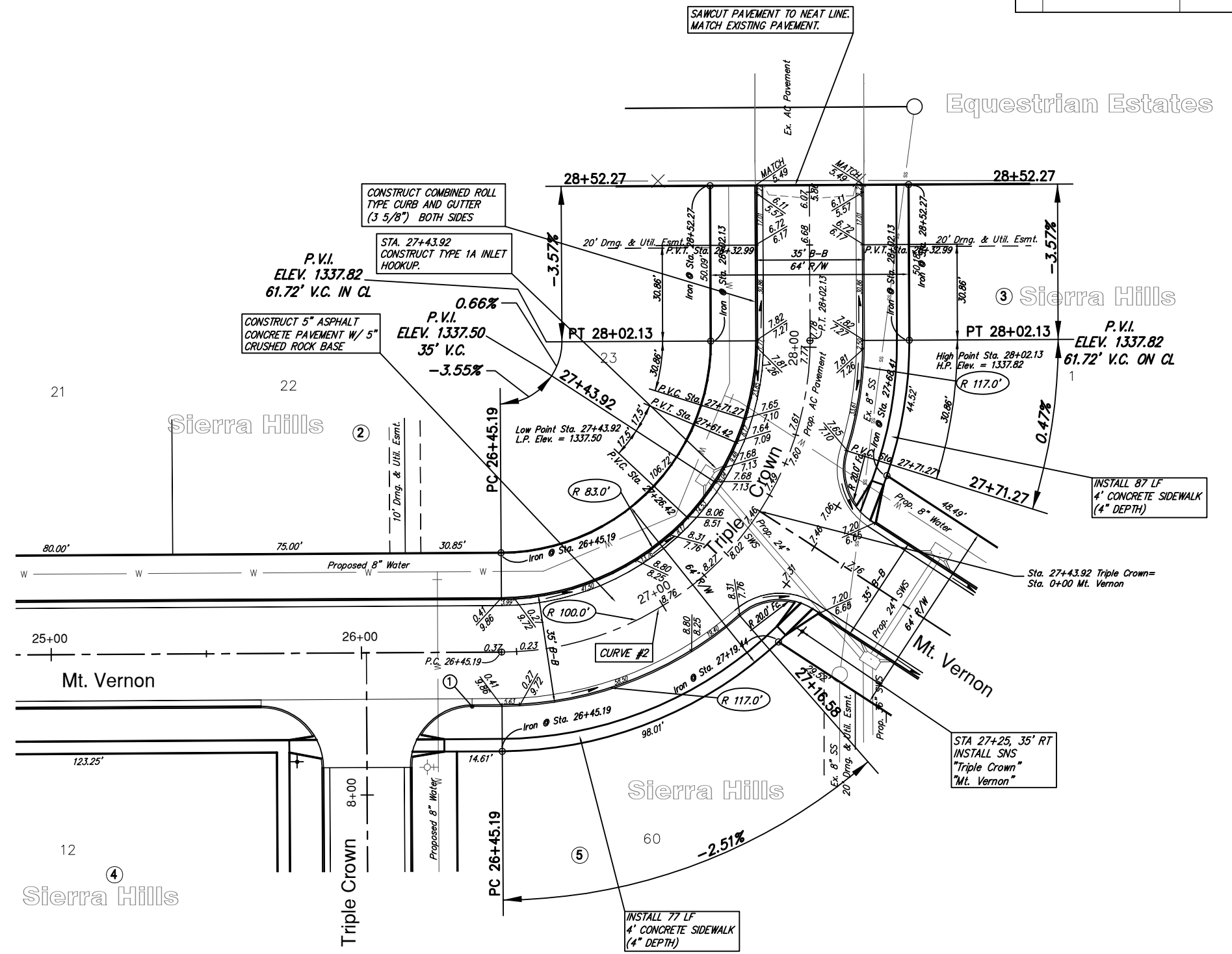

SCALE 1" = 20'
IRON = •



CURVE #2
Curve Data Based on Centerline
Rad. = 100' Delta = 89°55'25" Tangent = 99.87'
Arc = 156.95' L.C. = 141.33' Def/Ft. = 17.18833 Min.

Station	Arc	FACE CHORD LENGTHS		Def.	T. Def.
		B Lt.	B Rt.		
26+45.19	-	-	-	0'00"00"	0'00"00"
26+50.00	4.81'	3.61'	6.01'	1'22"40"	1'22"40"
26+75.00	25.00'	18.70'	31.17'	7'09"42"	8'32"22"
27+00.00	25.00'	18.70'	31.17'	7'09"42"	15'42"04"
27+25.00	25.00'	18.70'	31.17'	7'09"42"	22'51"46"
27+50.00	25.00'	18.70'	31.17'	7'09"42"	30'01"28"
27+75.00	25.00'	18.70'	31.17'	7'09"42"	37'11"10"
28+02.13	27.13'	20.28'	33.81'	7'46"19"	44'57"29"

NOTE: ROLL TYPE CURB AND GUTTER TO BE CONSTRUCTED ALONG PAVEMENT DEPICTED ON THIS SHEET

**Sierra Hills Phase 2
Mt. Vernon/Triple Crown
WICHITA, KANSAS**

Ruggles & Bohm, P.A.
Engineering, Surveying, Land Planning

924 North Main (316) 264-8008
Wichita, Kansas 67203 (316) 264-4621 fax
www.rbkansas.com E-mail: info@rbkansas.com

DESIGN: KWL
DRAWN: MLP
REVIEW: [blank]
UTILITY: [blank]

PROJECT NUMBER: 472-84423
DATE: July 27, 2006

SHEET 6 OF 33