

Subdivision Bench Marks

No.	Street and Station	From CL	Description	Elevation
2	Mt. Vernon Ct., Sta. 6+22.37	17.50' Lt.	S.E. End of Curb Return Int. of Mt. Vernon and Mt. Vernon Ct.	

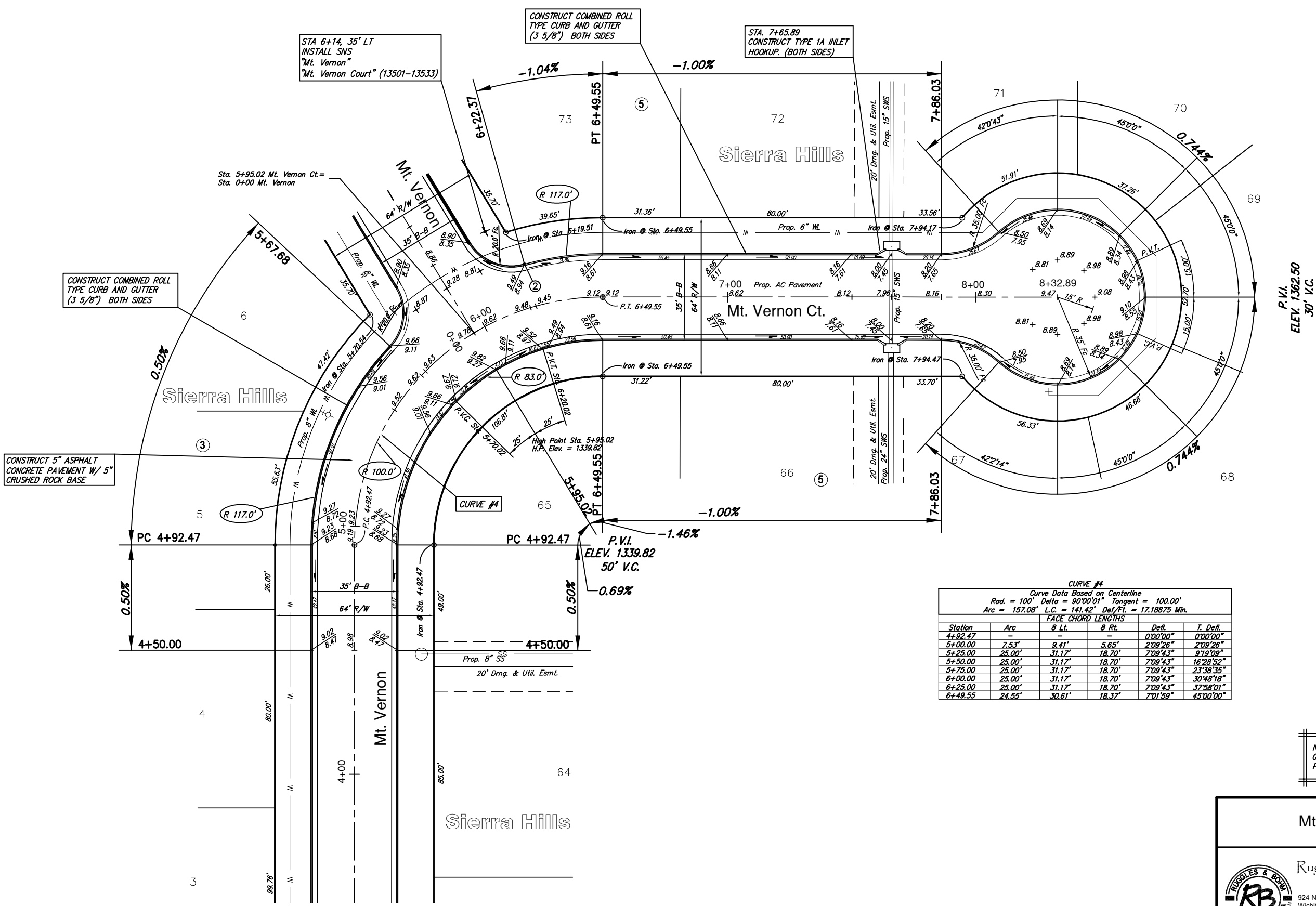
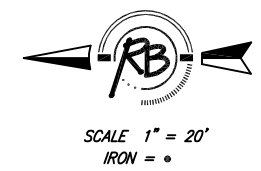

CURVE #4
Curve Data Based on Centerline
Rad. = 100' Delta = 90°00'01" Tangent = 100.00'
Arc = 157.08' L.C. = 141.42' Def./F.L. = 17.18875 Min.

Station	Arc	FACE CHORD LENGTHS		Defl.	T. Defl.
		B Lt.	B Rt.		
4+92.47	-	-	-	0°00'00"	0°00'00"
5+00.00	7.53'	9.41'	5.65'	2°09'26"	2°09'26"
5+25.00	25.00'	31.17'	18.70'	7°09'43"	9°19'09"
5+50.00	25.00'	31.17'	18.70'	7°09'43"	16°28'52"
5+75.00	25.00'	31.17'	18.70'	7°09'43"	23°38'35"
6+00.00	25.00'	31.17'	18.70'	7°09'43"	30°48'18"
6+25.00	25.00'	31.17'	18.70'	7°09'43"	37°58'01"
6+49.55	24.55'	30.61'	18.37'	7°01'59"	45°00'00"

NOTE: ROLL TYPE CURB AND GUTTER TO BE CONSTRUCTED ALONG PAVEMENT DEPICTED ON THIS SHEET

Sierra Hills Phase 2
Mt. Vernon/Mt. Vernon Ct.
WICHITA, KANSAS

Ruggles & Bohm, P.A.
Engineering, Surveying, Land Planning

924 North Main
Wichita, Kansas 67203
www.rbkansas.com

DESIGN: KWL
DRAWN: MLP
REVIEW: [blank]
UTILITY: [blank]

PROJECT NUMBER: 472-84423
DATE: July 27, 2006

SHEET: 8 OF 33