



**CURVE #5**  
Curve Data Based on Centerline  
Rad. = 100.00' Delta = 31°14'20" Tangent = 27.96'  
Arc = 54.52' L.C. = 53.85' Def./Ft. = 17.18941 Min.

Station	Arc	FACE CHORD LENGTHS		Defl.	T. Defl.
		B Lt.	B Rt.		
0+63.76	-	-	-	0°00'00"	0°00'00"
0+75.00	11.24'	14.04'	8.43'	3°13'12"	3°13'12"
1+00.00	25.00'	31.17'	18.70'	7°09'44"	10°22'56"
1+18.28	18.28'	22.82'	13.69'	5°14'13"	15°37'09"



SCALE 1" = 20'  
IRON = ◦

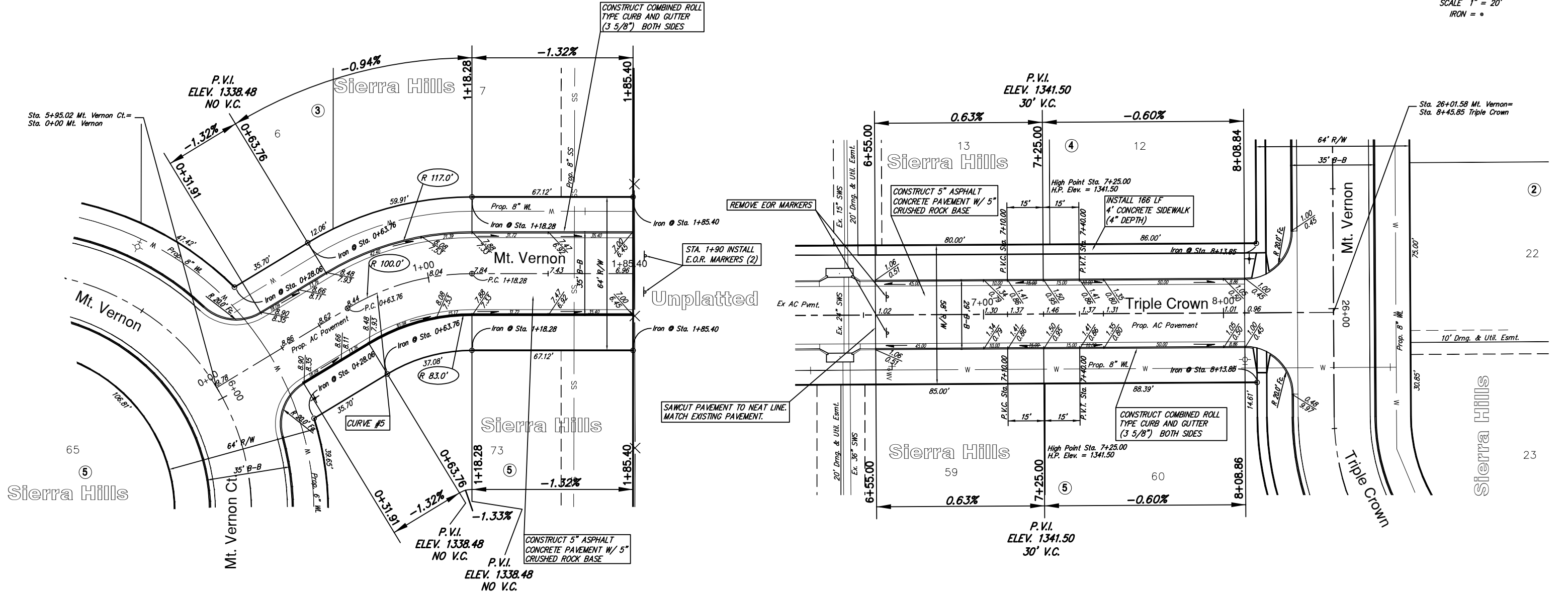

NOTE: ROLL TYPE CURB AND GUTTER TO BE CONSTRUCTED ALONG PAVEMENT DEPICTED ON THIS SHEET

Sierra Hills Phase 2  
Mt. Vernon/Mt. Vernon Ct.  
WICHITA, KANSAS

**Ruggles & Bohm, P.A.**  
Engineering, Surveying, Land Planning

924 North Main  
Wichita, Kansas 67203  
www.rbkansas.com

DESIGN: KWL  
DRAWN: MLP  
REVIEW: [blank]  
UTILITY: [blank]

PROJECT NUMBER: 472-84423  
DATE: July 27, 2006

SHEET 9 OF 33