

GENERAL NOTES

- 1. ALL ELEVATIONS SHOWN ARE BASED ON CITY OF WICHITA DATUM. (USGS-1187.4 = CITY DATUM)
2. CONTRACTOR WILL BE REQUIRED TO PROVIDE A MINIMUM ADVANCE NOTICE OF SEVENTY-TWO (72) HOURS (EXCLUDING WEEKENDS AND HOLIDAYS) TO UTILITY COMPANIES PRIOR TO STARTING ANY EXCAVATION AS FOLLOWS:
KANSAS ONE CALL 1-800-344-7233 OR 687-2470 (LOCAL WICHITA)
THE CONTRACTOR MUST NOTIFY THE FOLLOWING IN CASE OF AN EMERGENCY:
COX COMMUNICATIONS 316-262-0661
AT&T 1-800-870-8390
KANSAS GAS SERVICE 1-800-482-4950
WESTAR ENERGY 316-383-8600
CITY OF WICHITA WATER & SEWER DEPARTMENT 316-268-4555
THE CONTRACTOR SHALL NOTIFY PIPELINE COMPANIES AT LEAST 24 HOURS IN ADVANCE OF ANY WORK BEING PERFORMED ACROSS AND/OR ADJACENT TO PIPELINES.
3. CONTRACTOR SHALL NOT CAUSE ANY INCONVENIENCE TO THE PUBLIC, ADJACENT PROPERTY OWNERS, PEDESTRIANS, ETC. DURING THE CONSTRUCTION OF THIS PROJECT. THE CONTRACTOR SHALL NOT DISRUPT ACCESS TO ADJACENT PROPERTIES AT ANY TIME DURING CONSTRUCTION.
4. THE CONTRACTOR SHALL CONTACT THE ENGINEER FOR CLARIFICATION IF A DISCREPANCY OR INCONSISTENCY IS IDENTIFIED ON THE PLANS AND/OR SPECIFICATIONS.
5. CONTRACTOR IS RESPONSIBLE FOR THE DESIGN AND IMPLEMENTATION OF ALL REQUIRED/NECESSARY SHEETING, SHORING, AND SPECIAL EXCAVATION MEASURES REQUIRED ON THE PROJECT TO MEET OSHA, FEDERAL, STATE AND LOCAL REGULATIONS.
6. COST OF EXCAVATION, HAULING AND DUMPING OF EXCESS EXCAVATION SHALL BE SUBSIDIARY TO OTHER ITEMS OF WORK.
7. THE CONTRACTOR SHALL NOTIFY THE INSPECTOR FOR THIS PROJECT 48 HOURS PRIOR TO BEGINNING CONSTRUCTION. THE CONTRACTOR SHALL NOT START WORK ON THE PROJECT UNTIL THE PROJECT INSPECTOR ASSIGNED TO THE PROJECT IS PRESENT ON SITE. ANY WORK DONE WITHOUT INSPECTION WILL BE REQUIRED TO BE UNCOVERED FOR INSPECTION.
8. THE CONTRACTOR MUST EXAMINE THE CONSTRUCTION SITE PRIOR TO BIDDING AND BE SATISFIED AS TO THE WORK SHOWN FOR COMPLETION. AFTER BIDS HAVE BEEN RECEIVED, THE CONTRACTOR SHALL NOT ASSERT THAT THERE WAS A MISUNDERSTANDING OF THE QUANTITIES OF WORK OR OF THE NATURE OF THE WORK TO BE COMPLETED.
9. EXISTING UTILITIES AND THEIR LOCATION, AS SHOWN ON THE PLANS, REPRESENT THE BEST INFORMATION AVAILABLE FOR DESIGN. LOCATION INFORMATION HAS BEEN OBTAINED FROM THE VARIOUS UTILITY COMPANIES AND IS EITHER FROM COMPANY RECORD DRAWINGS OR COMPANY PROVIDED FIELD LOCATIONS. THE PLAN LOCATIONS ARE NOT GUARANTEED. ADDITIONAL EXISTING UTILITIES MAY ALSO BE ENCOUNTERED. THE CONTRACTOR WILL BE REQUIRED TO WORK AROUND EXISTING UTILITIES WHICH ARE ENCOUNTERED ON THIS PROJECT. THE CONTRACTOR SHALL EXERCISE EXTREME CAUTION DURING TRENCHING OPERATIONS TO AVOID DAMAGING THESE LINES. ANY LINES DAMAGED SHALL BE REPLACED OR REPAIRED IMMEDIATELY AS DIRECTED BY THE ENGINEER AT THE CONTRACTOR'S EXPENSE.
10. THE CONTRACTOR SHALL CONTAIN HIS OPERATIONS TO PERMIT TRAFFIC THROUGH AND ACROSS CONSTRUCTION AT EXISTING ROADWAYS AT ALL TIMES. THE CONTRACTOR SHALL ERECT WARNING SIGNS, FLASHING LIGHTS, AND BARRICADES IN COMPLIANCE WITH THE MANUAL ON UNIFORM TRAFFIC CONTROL DEVICES TO ENSURE SAFETY AS DIRECTED IN THE GENERAL CONDITIONS. THE CONTRACTOR SHALL LIMIT THE EXTENT OF TRENCH TO REMAIN OPEN OVERNIGHT AND WEEKENDS TO LESS THAN 50 FEET.
11. ALL LAWN/TURF AREAS DISTURBED BY CONSTRUCTION OF THE PROPOSED IMPROVEMENTS SHALL BE RESTORED WITH THE SAME GRASS/SOIL AS EXISTING. RESTORATION OF DISTURBED AREAS SHALL INCLUDE, BUT NOT BE LIMITED TO, TOP SOIL PREPARATION, SEEDING, MULCH, AND/OR RESEEDING. ALL SEEDING/SODDING WORK SHALL BE IN ACCORDANCE WITH THE CITY OF WICHITA STANDARD SPECIFICATIONS AND THE CITY OF WICHITA ADMINISTRATIVE REGULATION NO. AR78 WHICH GOVERNS CLEANUP AND RESTORATION OR REPLACEMENT FOLLOWING CONSTRUCTION. ALL COSTS FOR THIS WORK SHALL BE SUBSIDIARY TO THE LUMP SUM PRICE BID FOR 'SITE RESTORATION'.
12. CUTS MADE TO PAVED SURFACES ON PUBLIC PROPERTY WILL BE REPAIRED BY THE CITY'S CONTRACTOR AND CHARGED AGAINST THE OWNER/APPLICANT. UNIT REPAIR PRICES ARE AVAILABLE FROM THE CITY AT 268-4418. A SURCHARGE MAY BE APPLICABLE. CALL 268-4418 FOR DETAILS. REPAIR COSTS TO BE PAID PRIOR TO RELEASE OF WATER SERVICE IF WATER SERVICE IS AFFECTED.
13. ALL WATER MAINS AND APPURTENANCES SHALL BE INSTALLED IN ACCORDANCE WITH CITY OF WICHITA, KANSAS STANDARD SPECIFICATIONS FOR WATER MAIN INSTALLATIONS NO. 14533.
14. THE WATER MAIN SHALL BE CONSTRUCTED ON THE ALIGNMENT SHOWN BY THE PLANS. TREES AND SHRUBS IN PUBLIC RIGHT-OF-WAY WHICH ARE IN DIRECT CONFLICT WITH PROPOSED NEW CONSTRUCTION SHALL BE REMOVED BY THE CONTRACTOR WITH THE ENGINEER'S APPROVAL. TREES AND SHRUBS WHICH ARE NOT IN DIRECT CONFLICT WITH PROPOSED NEW CONSTRUCTION SHALL BE SAVED AND PROTECTED FROM DAMAGE. THE COST FOR ANY NECESSARY TREE TRIMMING, CLEARING AND/OR GRUBBING SHALL BE INCLUDED IN THE PRICE BID FOR THE INSTALLED WATER MAIN PIPE.
15. OPENING AND CLOSING WATER VALVES SHALL BE DONE SLOWLY TO PREVENT DAMAGE TO THE WATER DISTRIBUTION SYSTEM FROM WATER HAMMER. ALL VALVES CLOSED BY THE CONTRACTOR MUST BE REOPENED AS NEW CONSTRUCTION PERMITS. PROJECT INSPECTOR MUST ASCERTAIN THAT ANY VALVE CLOSED BY THE CONTRACTOR IS REOPENED. CONTRACTOR WILL BE PERMITTED TO OPERATE WATER VALVES ONLY WHEN THE PROJECT INSPECTOR ASSIGNED TO THE PROJECT IS PRESENT.
16. NO SERVICES WILL BE INSTALLED AS PART OF THIS PROJECT.
17. THE WATER DEPARTMENT SHALL FIELD LOCATE WATER VALVES ONE TIME DURING CONSTRUCTION WHEN REQUESTED BY THE CONTRACTOR. IT SHALL BE THE CONTRACTOR'S RESPONSIBILITY TO PRESERVE SUCH FIELD LOCATIONS DURING THE CONSTRUCTION PROCESS. WATER VALVES, WATER VALVE BOXES OR FIRE HYDRANTS DAMAGED DURING CONSTRUCTION SHALL BE REPAIRED BY THE CONTRACTOR AT HIS OWN EXPENSE.

WATER LINE IMPROVEMENTS TO SERVE WEBB ROAD BUSINESS PARK

LOT 1, ANDEELS WEBB ROAD ADDITION & A PORTION OF LOT 1, HIGGINS TURNPIKE ADDITION WICHITA, KANSAS

PRIVATE PROJECT NO.: 1343 PPW (607853) CITY OF WICHITA, KANSAS JAMES L. ARMOUR, P.E., CITY ENGINEER SEPTEMBER 2007

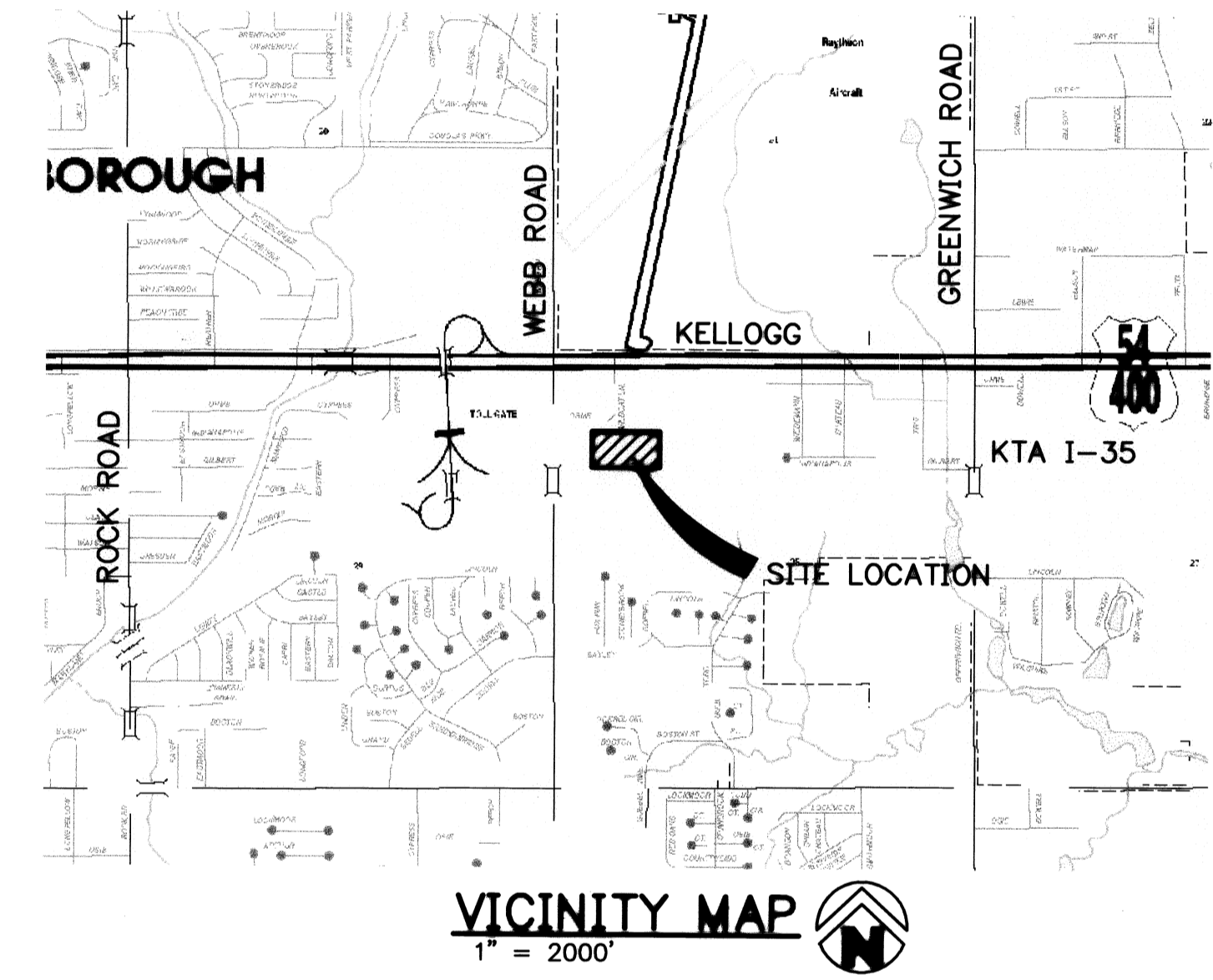

- LEGEND
#4 Baughman Rebar Found
O = 3/4" Iron Pipe Found
□ = 1/2" Iron Pipe Found
x = Chiseled Cross Found
△ = #6 Rebar Found
⊙ = #4 Baughman Rebar Set
○-FH = Fire Hydrant
● SSMH = Sanitary Sewer Manhole
● SWSMH = Stormwater Sewer Manhole
○ T = Tree
● WM = Water Meter

SHEET INDEX table with columns SHEET NO. and SHEET TITLE. Lists sheets from C0.01 to C25.01, including Cover Sheet, Demolition Plan, Site Plan, Grading Plan, Utility Plan, Erosion Control Notes, Erosion Detail Sheets, Detail Sheet, STD Drive Entrance Detail, and Water/Waterline details.

** = NOT INCLUDED IN THIS SET

ENGINEER'S NOTICE TO CONTRACTOR
THE EXISTENCE AND LOCATION OF ANY UNDERGROUND UTILITY PIPES OR STRUCTURES SHOWN ON THESE DRAWINGS ARE OBTAINED BY A SEARCH OF THE AVAILABLE RECORDS. TO THE BEST OF OUR KNOWLEDGE THERE ARE NO EXISTING UTILITIES EXCEPT AS SHOWN ON THESE DRAWINGS AND WE ASSUME NO RESPONSIBILITY AS TO THE ACCURACY OF THEIR DEPICTED LOCATION ON THESE DRAWINGS. THE CONTRACTOR IS REQUIRED TO TAKE DUE PRECAUTIONARY MEASURES TO PROTECT THE UTILITY LINES SHOWN, AND ALL OTHER LINES NOT OF RECORD OR NOT SHOWN ON THESE DRAWINGS BY VERIFICATION OF THEIR LOCATION IN THE FIELD PRIOR TO THE INITIATION OF THE ACTUAL PORTION OF THEIR WORK.

HORIZONTAL CONTROL POINTS table with columns C.P. NO., N, E, and description of control points.

SAFETY NOTICE TO CONTRACTOR
IN ACCORDANCE WITH GENERALLY ACCEPTED CONSTRUCTION PRACTICES, THE CONTRACTOR WILL BE SOLELY AND COMPLETELY RESPONSIBLE FOR CONDITIONS OF THE JOB SITE, INCLUDING SAFETY OF ALL PERSONS AND PROPERTY DURING PERFORMANCE OF THE WORK. THIS REQUIREMENT WILL APPLY CONTINUOUSLY AND NOT BE LIMITED TO NORMAL WORKING HOURS.
THE DUTY OF THE ENGINEER TO CONDUCT CONSTRUCTION REVIEW OF THE CONTRACTOR'S PERFORMANCE IS NOT INTENDED TO INCLUDE REVIEW OF THE ADEQUACY OF THE CONTRACTOR'S SAFETY MEASURES, IN, OR NEAR THE CONSTRUCTION SITE.

OWNER - DEVELOPER:
ALCON & ASSOCIATES
ATTN: CHARLES R. CARO
2420 NORTH WOODLAWN, BLDG 300
WICHITA, KANSAS 67220
PHONE: 316-881-0529

OWNERSHIP OF DOCUMENTS
THIS DOCUMENT, AND THE IDEAS AND DESIGNS INCORPORATED HEREIN, AS AN INSTRUMENT OF PROFESSIONAL SERVICES, IS THE PROPERTY OF CRAFTON, TULL, SPARKS & ASSOCIATES, INC., AND IS NOT TO BE USED, IN WHOLE OR PART, FOR ANY OTHER PROJECT WITH OUT THE WRITTEN AUTHORIZATION OF CRAFTON, TULL, SPARKS & ASSOCIATES, INC.

LEGAL DESCRIPTION
LOT 1, ANDEELS WEBB ROAD ADDITION & A PORTION OF LOT 1, HIGGINS TURNPIKE ADDITION

SURVEY DISCLAIMER
TOPOGRAPHIC SURVEY DATA WAS PROVIDED BY THE OWNER TO CRAFTON, TULL, SPARKS & ASSOCIATES, INC. THE ORIGINAL SURVEY WAS PREPARED BY BAUGHMAN CO. AND DATED NOVEMBER 8, 2002. THE ENGINEER MAKES NO GUARANTEES AS TO THE ACCURACY OF THE ELEVATIONS SHOWN.

BENCHMARK:
BM #1
SITE BENCHMARK:
1" x 1" CHISELED ON TOP OF CURB
ELEV = 181.79 (CITY DATUM)



KS: 1-800-344-7233 WICHITA: 316-687-2470

APPROVED AS NOTED BY CITY ENGINEER OF WICHITA, BY WICHITA WATER & SEWER DEPARTMENT & BY WICHITA FIRE DEPARTMENT. Includes signatures and dates for Water Mains (Public Works), Water Mains (W & S), and Fire Protection Line. Includes a NOTE TO CONTRACTORS section with PUBLIC PROPERTY and PRIVATE PROPERTY instructions regarding inspection and testing.

As Built Plans:
CONTRACTOR: McCullough Excavation
INSPECTOR: Larry Gann, K E Miller Engineering
.PDF by: NWS, 11-21-07

Crafton Tull Sparks logo and contact information: 8200 E. 34th Street North, Bldg. 1600, Suite 1603, Wichita, KS 67226. Website: www.craftontullsparks.com

WEBB ROAD BUSINESS PARK ORME STREET & WILDCAT LANE WICHITA, KANSAS ISSUED FOR CONSTRUCTION

Project metadata including Date (08/17/07), Sheet Number (C10.01), Job Number (073006-00), and Contact Person (J. MOHLER).