

SHEET NO.	TOTAL SHEETS
2	17

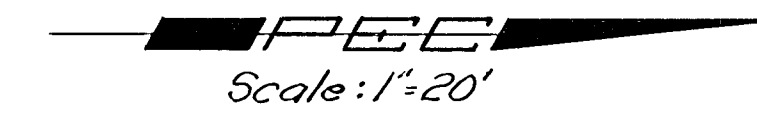

P.O.T. Sta. 10+00
 1. 40d Spike & Wshr. @ P.O.T.
 2. 'X' cut in top curb 26.25' SW
 3. 'X' cut in top curb 28.30' SE
 4. 40d Spike in Power Pole 19.14' ENE

P.O.T. Sta. 13+76.58
 1. 40d Spike & Wshr. @ P.O.T.
 2. 'X' cut in top curb 65.23' NNW
 3. RR Spike in E. Side Power Pole 68.00' NNE (BM#2)
 4. 3-60d Spikes in Power Pole 68.21' SSE

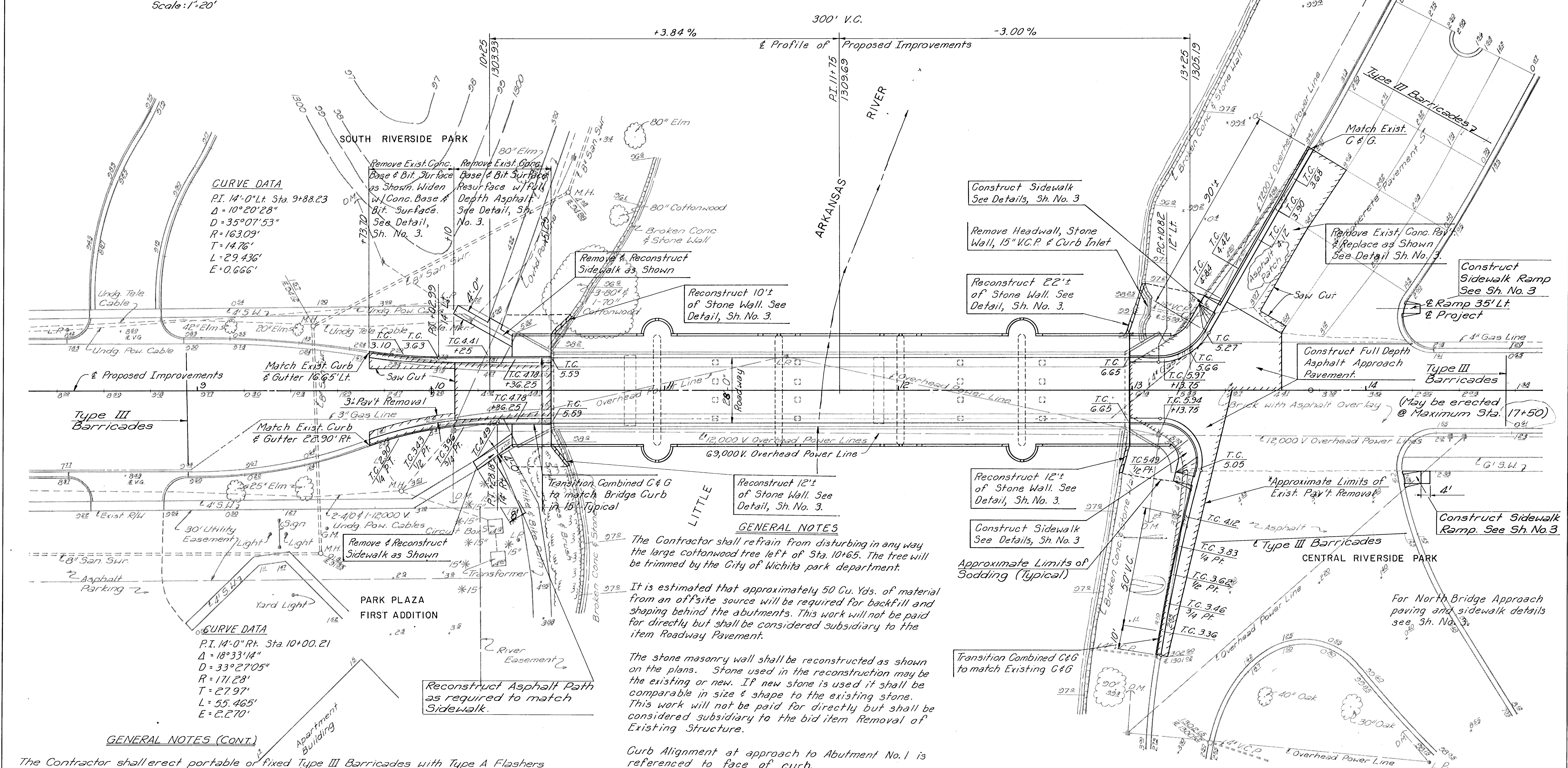

CURVE DATA
 P.I. 14'-0" Lt. Sta. 9+88.23
 $\Delta = 10^\circ 20' 28''$
 $D = 35^\circ 07' 53''$
 $R = 163.09'$
 $T = 14.76'$
 $L = 29.436'$
 $E = 0.666'$

CURVE DATA
 P.I. 14'-0" Rt. Sta. 10+00.21
 $\Delta = 18^\circ 33' 14''$
 $D = 33^\circ 27' 05''$
 $R = 171.28'$
 $T = 27.97'$
 $L = 55.465'$
 $E = 2.270'$

300' V.C.
 +3.84% -3.00%
 Profile of Proposed Improvements

GENERAL NOTES

- The Contractor shall refrain from disturbing in any way the large cottonwood tree left of Sta. 10+65. The tree will be trimmed by the City of Wichita park department.
- It is estimated that approximately 50 Cu. Yds. of material from an offsite source will be required for backfill and shaping behind the abutments. This work will not be paid for directly but shall be considered subsidiary to the item Roadway Pavement.
- The stone masonry wall shall be reconstructed as shown on the plans. Stone used in the reconstruction may be the existing or new. If new stone is used it shall be comparable in size & shape to the existing stone. This work will not be paid for directly but shall be considered subsidiary to the bid item Removal of Existing Structure.
- Curb Alignment at approach to Abutment No. 1 is referenced to face of curb.
- Curb Alignment at approach to Abutment No. 2 is referenced to back of curb.
- All rubble resulting from demolition of the existing structure may be disposed of on West Bank of Big Arkansas River between Central Avenue and 13th Street. Contractor to coordinate rubble disposal with Wichita-Valley Center Flood Control Office.

GENERAL NOTES (CONT.)

- The Contractor shall erect portable or fixed Type III Barricades with Type A Flashers @ the approximate locations shown on the plans.
- The Contractor's work area shall be confined to the existing street proper except @ the Bridge Site unless otherwise authorized by the Engineer.
- After the river banks outside the bridge wings have been satisfactorily graded & shaped the areas which have had existing vegetation removed shall be resodded with Bermuda. It is estimated that approximately 145 Sq. Yds. of sod will be required. All sodded areas shall be kept thoroughly watered by the Contractor for 60 days after laying. All sod shall be moist & growing when accepted. This work will not be paid for directly but shall be considered incidental to the bid item "Roadway Pavement".

BM#1 Chris. 0' @ S.E. End SE Wingwall
 Nims St. Bridge @ Little Arkansas River
 El. 1305.646

BM#2 RR Spike in E. Side of N. Pole of
 Dbl. Transformer & Power Pole Sta.
 14+42' Rt. (Ground Level) Elev. 1302.025

CITY OF WICHITA KANSAS
 R.W. LINN, P.E. CITY ENGINEER

PLAN
 WOODMAN BRIDGE
 OVER THE LITTLE ARKANSAS RIVER
 CITY OF WICHITA PROJECT NO. DAKB 576042

PROFESSIONAL ENGINEERING CONSULTANTS, P.A.
 ENGINEERS
 WICHITA, KANSAS

Designed by	Checked by
Drawn by	Date
	Job No.