

PI #5 Baseline Sta. No. 2 Sta. 36+58.76, Nail and Shiner in Centerline of Hoover Street
 1. Three Nails and Shiners in Fence Post 86.92 NW
 2. Three Nails and Shiners in Power Pole 34.26 SW
 3. Three Nails and Shiners in Corner Post 50.98 E
 4. Chiseled "M" on N end of R/P 44.08 NE
 5. 5/8" Rebar with Cap 25.00 W

PI #11 Baseline No. 2 Sta. 36+65.58 = East 1/4 corner Section 10, T28S, R1W, 1" Iron Pipe in Thimble, in Centerline of Hoover, 1/2 mile South of 31st Street South
 1. Three Nails and Shiners in Corner Post 52.55' E
 2. Three Nails and Shiners in Fence Post 42.70' NW
 3. Three Nails and Shiners in High L. Pole 31.60' SW

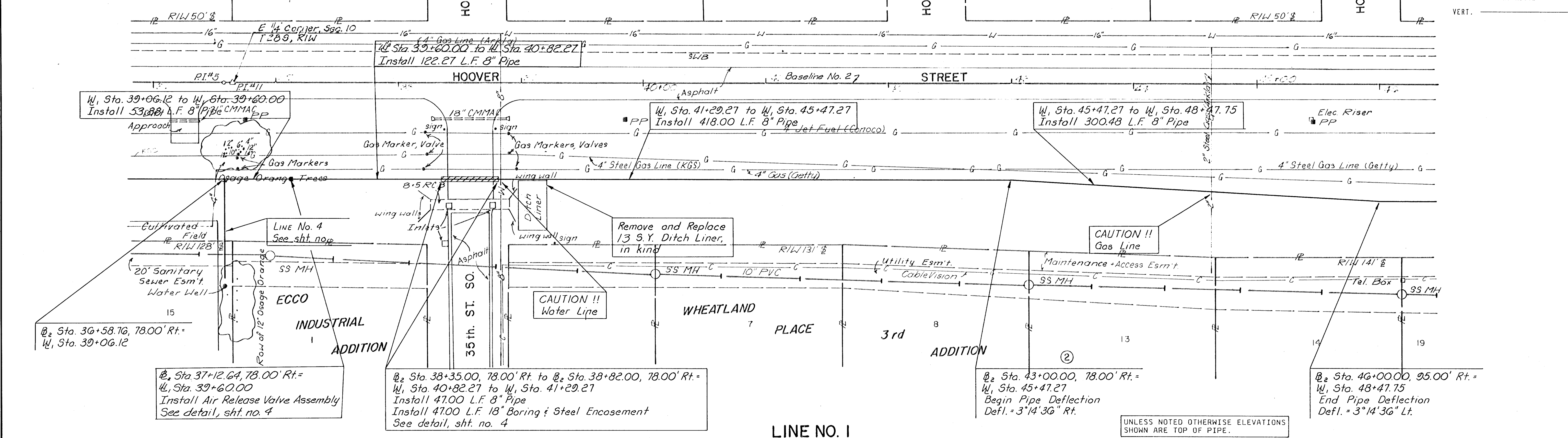
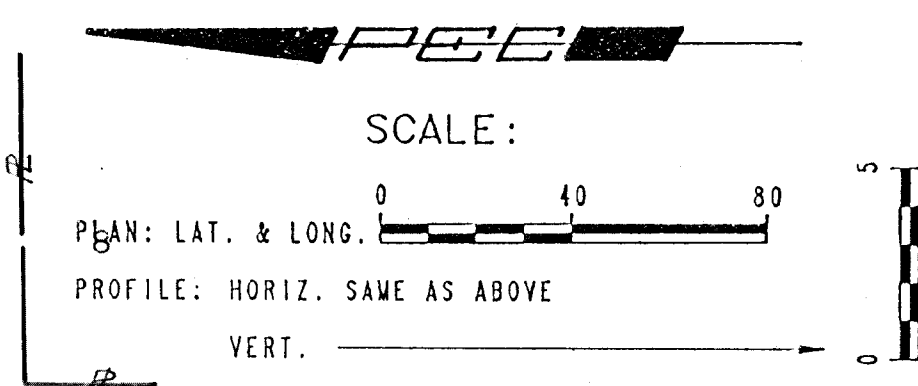

DATE	
BY	
PLAN	
SURVEYED	
PLOTTED	
CHECKED	
NOTE BOOK	
RT. OF WAY CHECKED	
NO.	

DATE	
BY	
PROFILE	
SURVEYED	
PLOTTED	
CHECKED	
NOTE BOOK	
RT. OF WAY CHECKED	
NO.	

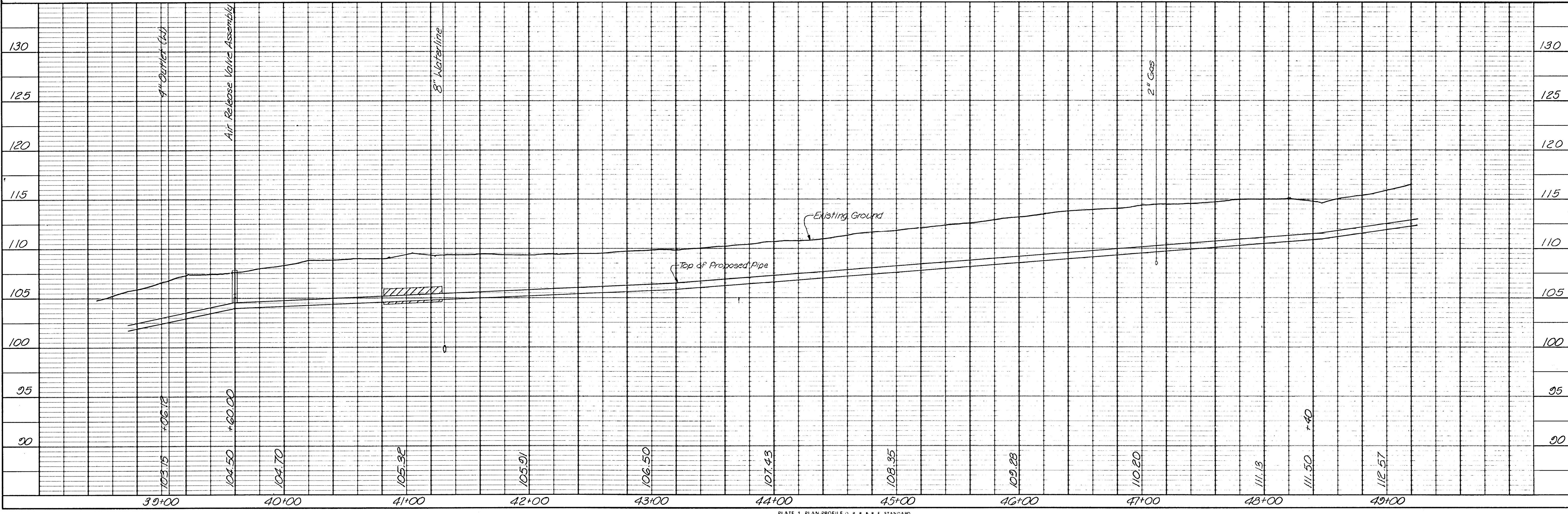

CESSNA AIRCRAFT COMPANY
 WICHITA, KANSAS
LINE NO. 1
 W Sta. 39+06.12 to W Sta. 48+47.75
 WITHDRAWAL WATERLINE IMPROVEMENTS

PROFESSIONAL ENGINEERING CONSULTANTS, P.A.
 ENGINEERS
 WICHITA, KANSAS
 Job No. 34-87042
 Drawn by MKK, TJS, GM
 Date August 12, 88

Sh. 11 of 20