

PI #7
 Baseline #2 Sta. 62+35.66 = Centerline of Hoover and MacArthur = SW
 Corner, Section 11, T28S, R1W, 1/2" Iron Pipe in Thimble

- Three Nails and Shiners in Telephone Pole 62.40 NE
- Three Nails and Shiners in Telephone Pole 61.90 NW
- Three Nails and Shiners in High Line Pole 56.00 SW

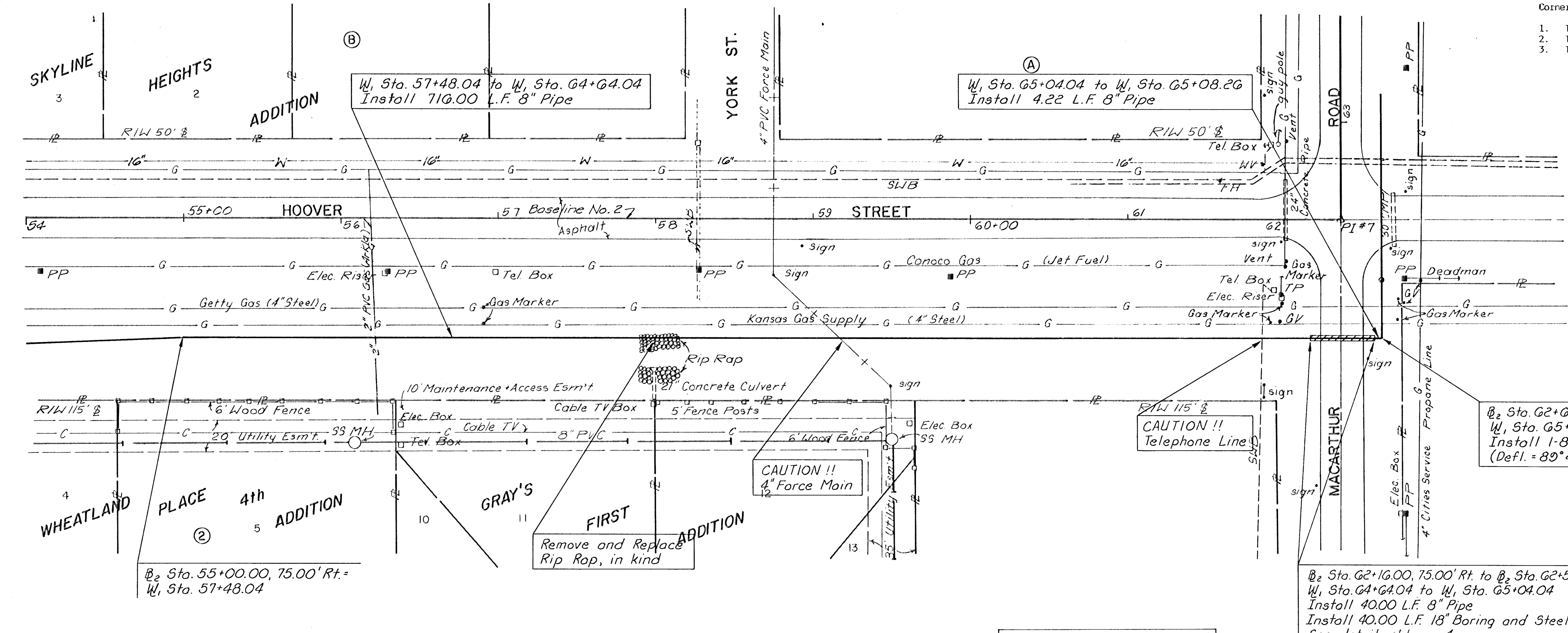
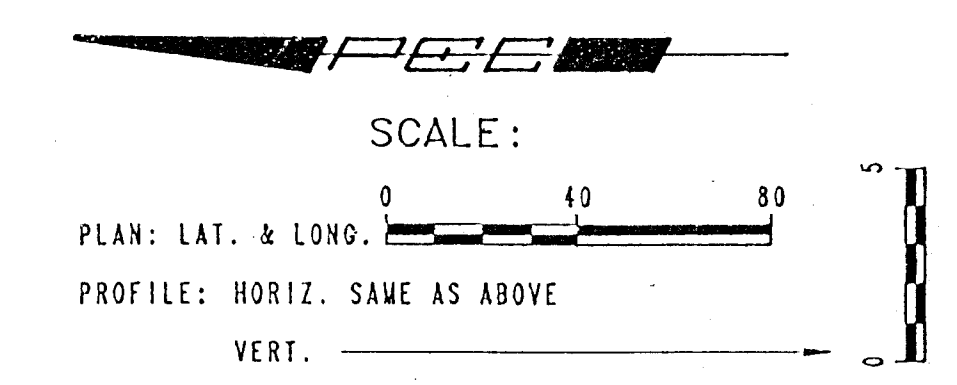

LINE NO. 1

UNLESS NOTED OTHERWISE ELEVATIONS SHOWN ARE TOP OF PIPE.

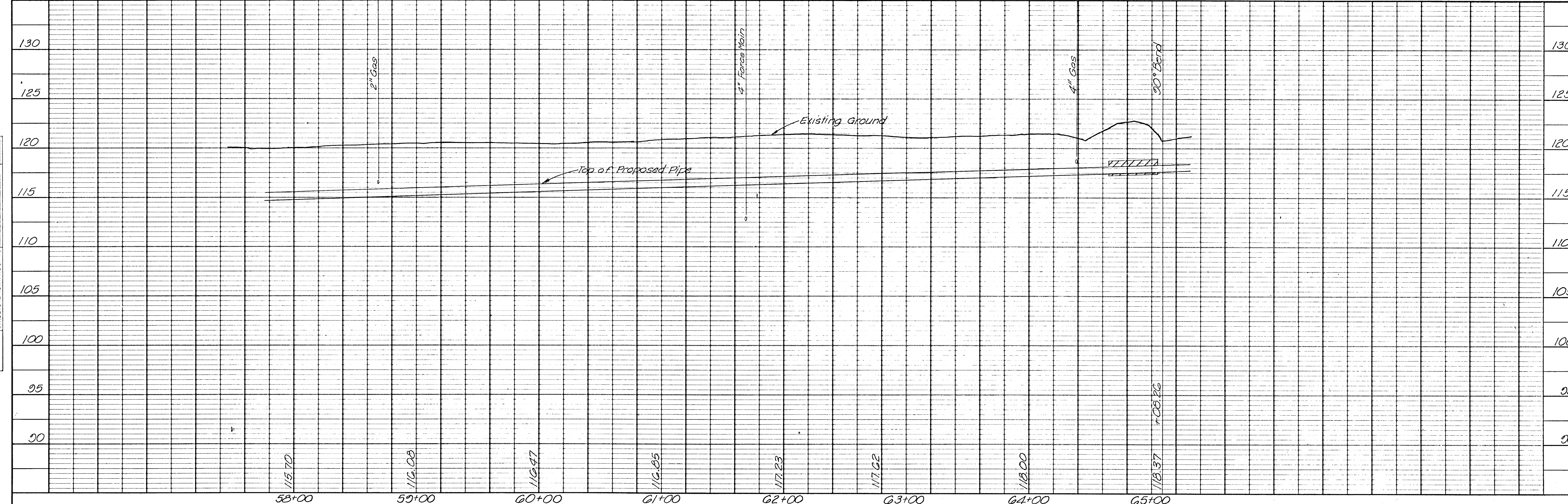

DATE	
BY	
PLANNED	
NOTED	
STRUCTURE	
NO.	

DATE	
BY	
PLANNED	
NOTED	
STRUCTURE	
NO.	

CESSNA AIRCRAFT COMPANY
 WICHITA, KANSAS

LINE NO. 1

W Sta. 57+48.04 to W Sta. 65+08.26

WITHDRAWAL WATERLINE IMPROVEMENTS

PROFESSIONAL ENGINEERING CONSULTANTS, P.A.
 ENGINEERS
 WICHITA, KANSAS

Job No. 84-87642
 Date August, 1988
 Designed by MDS, CRY
 Drawn by MCK, T.S.G.M

Sht. 13 of 20