

PUB. ROAD DIV. NO.	STATE	PROJECT NO.	FISCAL YEAR	SHEET NO.	TOTAL SHEETS
5	KANSAS	35W-271-35W-1(23)46	1970	15	229

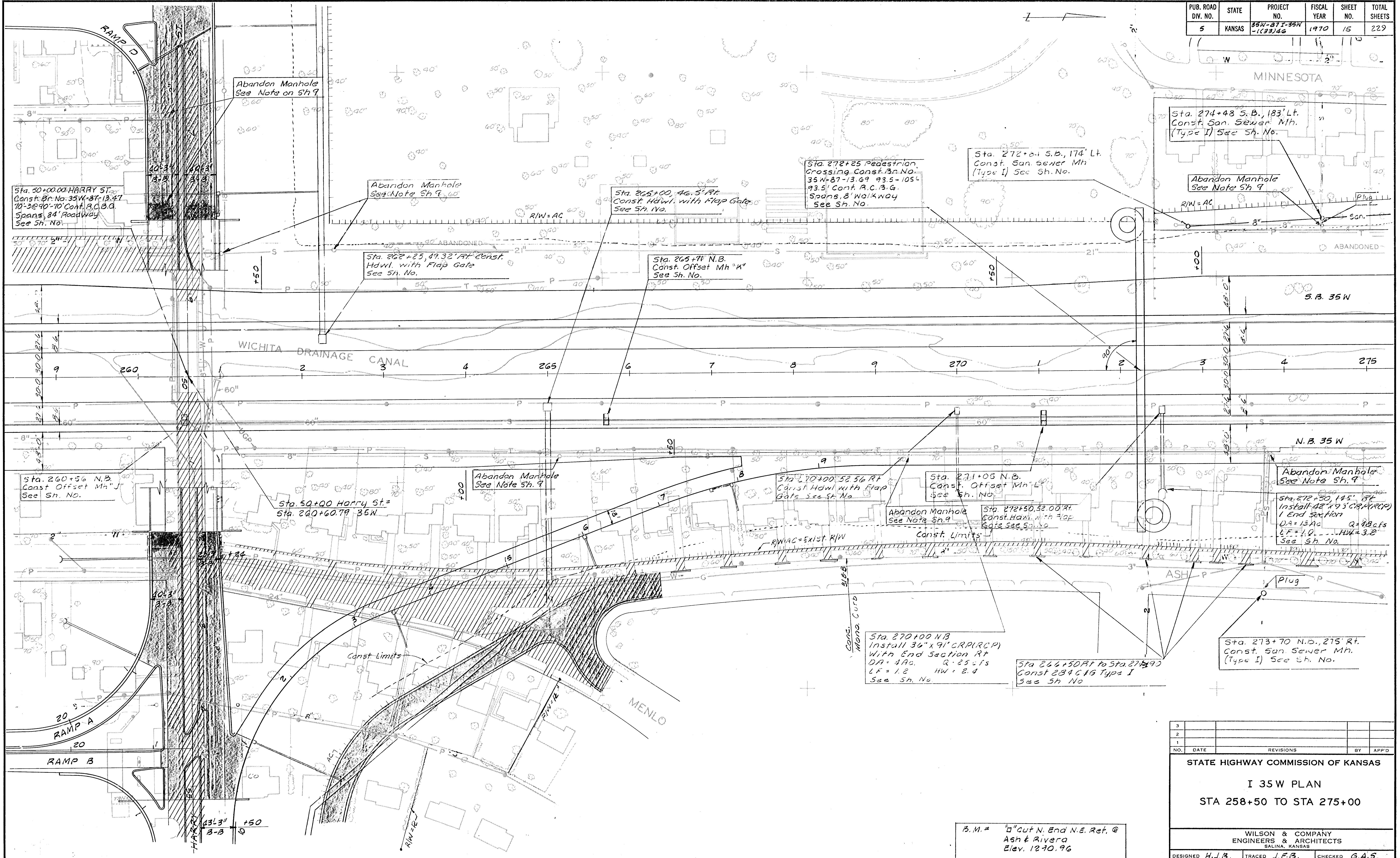

Sta. 50+00.00 HARRY ST  
Const. Br. No. 35W-87-13.47  
10'-3" x 90'-10" Cont. R.C.B.G.  
Spans 84' Roadway  
See Sh. No.

Abandon Manhole  
See Note on Sh. 9

Abandon Manhole  
See Note Sh. 9

Sta. 265+00.46.5' RT  
Const. Hdwl. with Flap Gate  
See Sh. No.

Sta. 272+25 Pedestrian  
Crossing Const. Br. No.  
35W-87-13.69 93.5-105-  
93.5' Cont. R.C.B.G.  
Spans 8' Walkway  
See Sh. No.

Sta. 272+04 S.B., 174' Lt.  
Const. San. Sewer Mh  
(Type I) See Sh. No.

Sta. 274+48 S.B., 183' Lt.  
Const. San. Sewer Mh.  
(Type I) See Sh. No.

Abandon Manhole  
See Note Sh. 9

Sta. 262+25.49.32' RT Const.  
Hdwl. with Flap Gate  
See Sh. No.

Sta. 265+71 N.B.  
Const. Offset Mh "K"  
See Sh. No.

Sta. 260+56 N.B.  
Const. Offset Mh "J"  
See Sh. No.

Sta. 50+00 Harry St =  
Sta. 260+60.79 35W

Abandon Manhole  
See Note Sh. 9

Sta. 270+00.52.56 RT  
Const. Hdwl. with Flap  
Gate See Sh. No.

Sta. 271+05 N.B.  
Const. Offset Mh "L"  
See Sh. No.

Abandon Manhole  
See Note Sh. 9

Sta. 272+50.52.00 RT  
Const. Hdwl. with Flap  
Gate See Sh. No.

Abandon Manhole  
See Note Sh. 9

Sta. 272+30, 195' 18"  
Install 42" x 93" CRP (RCP)  
1 End Section  
D=4' 13.40 Q=48 cfs  
LF=1.0 HW=3.2  
See Sh. No.

Sta. 270+00 NB  
Install 36" x 91" CRP (RCP)  
With End Section RT  
DA=4Ac. Q=25 cfs  
LF=1.2 HW=2.4  
See Sh. No.

Sta. 274+50 RT to Sta. 275+00  
Const. 28" C 4" G Type I  
See Sh. No.

Sta. 273+70 N.B., 275' RT.  
Const. San. Sewer Mh.  
(Type I) See Sh. No.

B.M. # 11 Cut N. End N.E. Ret. @  
Ash & Rivera  
Elev. 1270.96

NO.	DATE	REVISIONS	BY	APP'D
3				
2				
1				

STATE HIGHWAY COMMISSION OF KANSAS

I 35W PLAN

STA 258+50 TO STA 275+00

WILSON & COMPANY  
ENGINEERS & ARCHITECTS  
SALINA, KANSAS

DESIGNED H.J.B. TRACED J.F.B. CHECKED G.A.S.