

PUB. ROAD DIV. NO.	STATE	PROJECT NO.	FISCAL YEAR	SHEET NO.	TOTAL SHEETS
5	KANSAS	35 W. 87.35 W. 11351.48	1970	53	229

ALIGNMENT DATA			COORDINATES		
NO.	ROAD	STA.	DESCRIPTION	NORTH	EAST
1	35W	287+28.14	INTERSECTION - STA. 50+00 LINCOLN	17,111.65	99,363.98
2	LINCOLN	51+51.20	STA. 21+88.87 RAMP AB	17,118.02	99,806.14
3	RAMP A	22+53.47	P.T. A-1, 46.25' RT. STA. 62+69.80 LINC	17,369.17	99,624.42
4	RAMP A	19+83.47	P.C. A-1, 22.25' LT. STA. 19+83.47 RP AB	17,212.32	99,788.94
5	RAMP AB	18+08.08	P.T. AB-1	17,037.27	99,810.60
6	RAMP B	16+89.23	22.25' RT. POINT NO. 7	16,912.92	99,792.63
7	RAMP AB	16+89.23	P.C. AB-1	16,926.22	99,774.69
8	RAMP A	16+89.23	P.T. A-2, 22.25' LT. POINT NO. 7	16,939.62	99,756.86
9	RAMP A	12+92.12	P.C. A-2, 114' RT. STA. 283+50.36W	17,033.76	99,470.13
10	RAMP B	13+22.10	P.T. B-2	16,618.62	99,573.04
11	RAMP B	10+00	P.C. B-2=114' RT. STA. 276+34.15 36W	16,317.93	99,474.21
12	RAMP C	10+00	P.C. C-2=114' LT. STA. 276+34.15 36W	16,316.63	99,246.20
13	RAMP C	13+22.10	P.T. C-2	16,616.18	99,143.96
14	RAMP CD	16+89.23	P.O. CD-1	16,921.46	98,938.82
15	RAMP C	16+89.23	22.25' LT. POINT NO. 14	16,907.96	98,921.14
16	RAMP D	16+89.23	P.T. D-2, 22.25' RT. POINT NO. 14	16,934.97	98,966.60
17	RAMP D	12+92.12	P.C. D-2, 114' LT. STA. 283+50.36W	17,032.47	99,242.14
18	RAMP CD	18+01.93	P.T. CD-1	17,028.96	98,901.61
19	RAMP C	19+75.59	P.C. C-1, 22.25' LT. STA. 19+75.59 RP CD	17,199.28	98,876.91
20	RAMP C	22+29.59	P.T. C-1, 46.25' RT. STA. 43+60.78 LINC	17,366.13	98,715.19
21	LINCOLN	45+42.18	STA. 21+80.99 RAMP CD	17,404.98	98,896.21

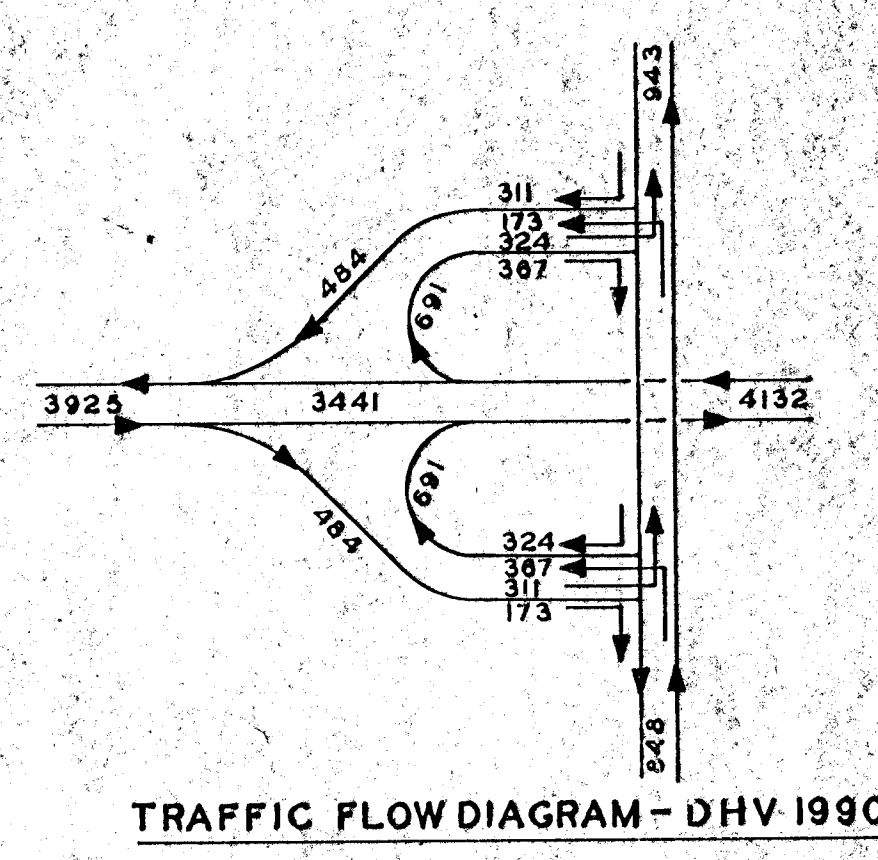
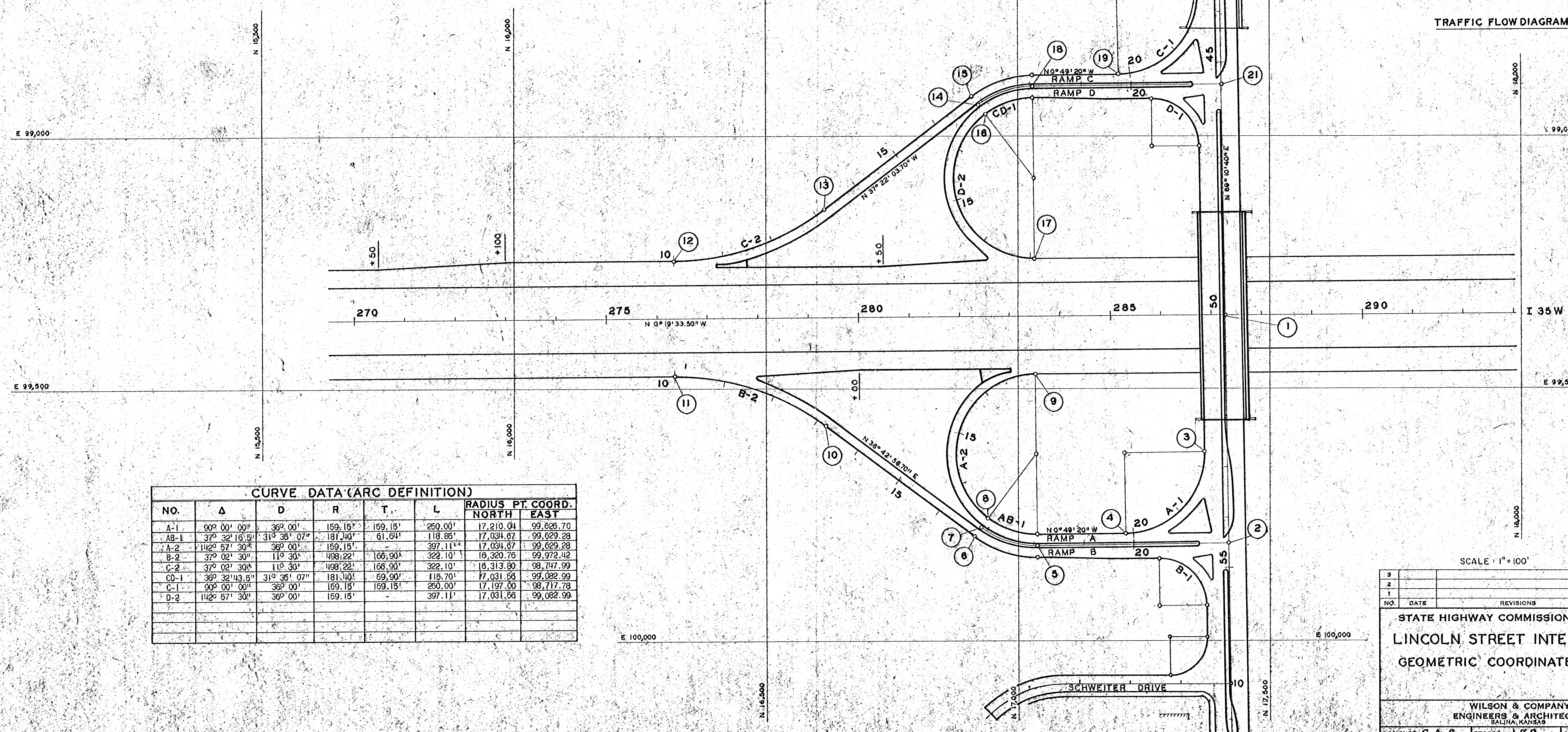

CURVE DATA (ARC DEFINITION)							
NO.	Δ	D	R	T	L	RADIUS PT. COORD.	
						NORTH	EAST
A-1	90° 00' 00"	36° 00'	159.15'	159.15'	250.00'	17,210.04	99,626.70
AB-1	37° 32' 16.5"	31° 35' 07"	181.40'	61.64'	118.86'	17,034.67	99,629.28
A-2	142° 57' 30"	36° 00'	159.15'	397.11'	17,034.67	99,629.28	
B-2	37° 02' 30"	11° 30'	498.22'	166.90'	322.10'	16,320.76	99,972.42
C-2	37° 02' 30"	11° 30'	498.22'	166.90'	322.10'	16,313.30	98,747.99
CD-1	36° 32' 43.5"	31° 35' 07"	181.40'	69.90'	115.70'	17,031.66	99,082.99
C-1	90° 00' 00"	36° 00'	159.15'	159.15'	250.00'	17,197.00	98,717.78
D-2	142° 57' 30"	36° 00'	159.15'	397.11'	17,031.66	99,082.99	

SCALE: 1" = 100'

3			
2			
1			

NO.	DATE	REVISIONS	BY	APPRO.

STATE HIGHWAY COMMISSION OF KANSAS
 LINCOLN STREET INTERCHANGE
 GEOMETRIC COORDINATE LAYOUT

WILSON & COMPANY
 ENGINEERS & ARCHITECTS
 SALINA, KANSAS

DESIGNED G. A. S. TRACED J. F. B. CHECKED H. J. B.