

CURVE TABLES-C1					
$\Delta = 50^{\circ}03'33''$ $R = 100.00'$ $T = 46.69'$ $L = 87.37'$ $LC = 84.62'$					
CURVE DATA BASED ON CENTERLINE $\Delta/2 = 25^{\circ}01'46''$					
		CHORD LENGTH			TOTAL DEFLECTION
STATION	ARC	8'Off LtCb	8'Off RtCb	DEFLECTION	
10+86.00	-	-	-	00'00"00"	00'00"00"
11+00.00	14.00'	17.07'	10.91'	04'00"39"	04'00"39"
11+25.00	25.00'	30.42'	19.45'	07'09"43"	11'10"22"
11+50.00	25.00'	30.42'	19.45'	07'09"43"	18'20"05"
11+73.37	23.37'	28.45'	18.19'	06'41"42"	25'01"47"
					Def/Ft = 17.18873 Min.

SUBDIVISION BENCH MARKS				
NO.	STREET AND STATION	FROM CL	DESCRIPTION	ELEVATIONS
1	SHADE CT STA. 10+74.44	14.0' RT.	END OF RETURN	

NOTE: CONTRACTOR SHALL INSTALL SUBDIVISION BENCH MARKS ("FLAT SURVEY MARKERS NO. 8134-08 3" TOP DIAMETER" PROVIDED BY KANSAS BLUE PRINT CO., INC.) COSTS TO BE CONSIDERED SUBSIDIARY TO CONSTRUCTION OF COMBINED CURB AND GUTTER.

MKEC
ENGINEERING
CONSULTANTS, INC.
411 N. WEBB ROAD
WICHITA, KS. 67206
316-684-9600

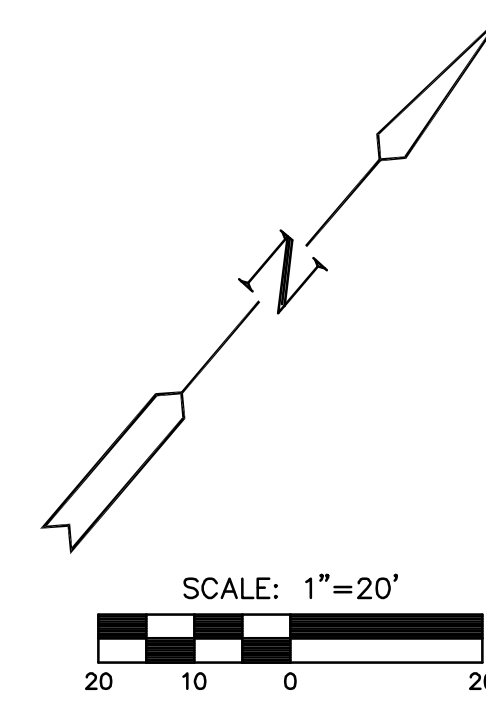
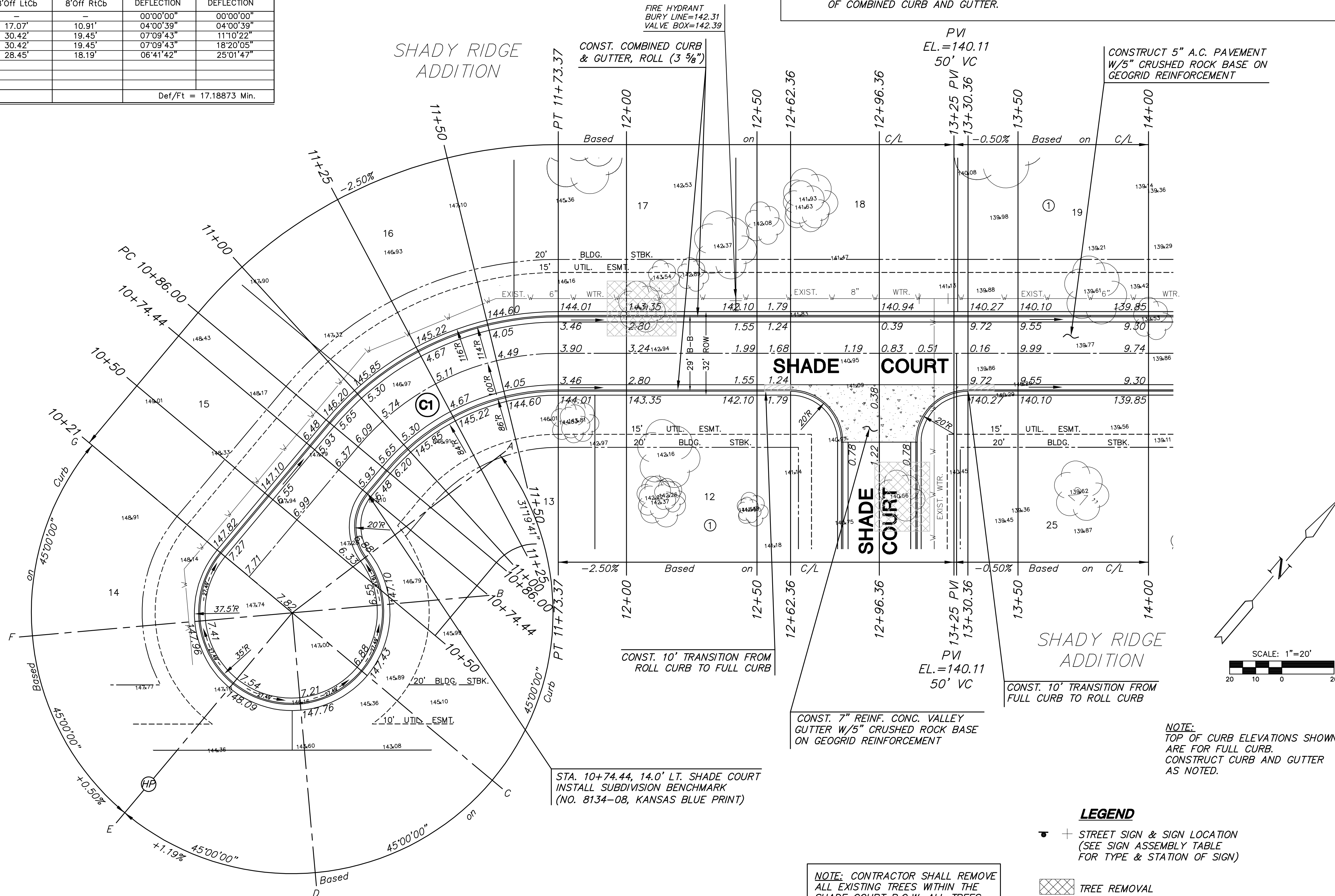

PAVING & INCIDENTAL DRAINAGE
SHADY RIDGE ADDITION
PHASE 2

SHADE COURT PAVING PLANS
SHEET TITLE
472-84052
PROJECT NUMBER

SRS
DESIGN BY
JWC
DRAWN BY
DFL
CHECKED BY

ISSUED
November 2007
REVISED

SHEET NO.
7 of 22

- LEGEND**
- + STREET SIGN & SIGN LOCATION (SEE SIGN ASSEMBLY TABLE FOR TYPE & STATION OF SIGN)
 - [Cross-hatch] TREE REMOVAL
 - [Stippled] REINFORCED CONCRETE PAVEMENT

NOTE: CONTRACTOR SHALL REMOVE ALL EXISTING TREES WITHIN THE SHADE COURT R.O.W. ALL TREES OUTSIDE OF THE R.O.W. SHALL REMAIN, UNLESS REMOVAL IS REQ'D BY CONSTRUCTION.

NOTE: TOP OF CURB ELEVATIONS SHOWN ARE FOR FULL CURB. CONSTRUCT CURB AND GUTTER AS NOTED.

PLOTTED: Monday, November 19, 2007 @ 09:56AM

G:\CIVIL\040071\DWG\PAVING\PH2\040071_E2.DWG