

POINT TABLE			
POINT NUMBER	NORTHING	EASTING	DESCRIPTION
1200	19859.7203	16987.0773	Iron
1201	19854.0576	16699.9965	Iron
1202	19852.4405	16618.0124	Iron
1203	19846.7650	16330.2862	Iron
1204	19046.8753	16312.2620	Iron
1205	18995.3615	16894.9532	Iron
1206	19114.8952	16905.5208	Iron
1207	19142.1068	16597.7213	Iron
1208	19205.8636	16603.2960	Iron
1209	19309.1642	16448.2053	Iron
1210	19307.7224	16512.1890	Iron
1211	19563.7526	16453.9420	Iron
1212	19562.3108	16517.9258	Iron
1213	19613.1649	16533.1675	Iron
1214	19658.8416	16602.3500	Iron
1215	19722.0630	16592.3977	Iron
1216	19727.2987	16625.6576	Iron
1217	19665.0867	16642.0223	Iron
1218	19532.2761	16718.7248	Iron
1219	19574.0791	16767.1862	Iron
1220	19515.1733	16817.9987	Iron
1221	19366.4721	16861.7481	Iron
1222	19408.2750	16910.2097	Iron
1223	19177.6339	16922.6122	Iron
1224	19171.9978	16986.3635	Iron
1225	19107.2337	16992.1828	Iron
1226	19092.0706	17163.6987	Iron
1227	19156.9390	17156.6992	Iron
1228	19248.3543	17168.1392	Iron
1229	19411.7465	17065.6918	Iron
1230	19549.6359	16946.7478	Iron
1231	19593.5540	16908.8638	Iron
1232	19755.1942	16813.5957	Iron
1233	19793.8395	16701.1843	Iron
1234	18987.7000	16981.6152	Iron
1235	18972.5368	17153.1311	Iron
1236	18969.0143	17192.9757	Iron
1237	18952.6075	17378.5584	Iron
1238	19088.5481	17203.5433	Iron
1239	19084.5852	17248.3685	Iron
1240	19148.3366	17254.0045	Iron
1241	19755.7398	16859.7047	Iron
1242	19520.7471	16637.0196	Iron
1243	19323.7427	16632.5805	Iron
1244	19743.8440	16702.1704	Iron
1245	19620.1060	16939.6450	Iron
1246	19575.7628	16977.0361	Iron
1247	19434.0312	17099.2944	Iron
1248	19260.8475	17184.9701	Iron
1249	19240.3105	17187.3408	Iron
1250	19244.9184	17421.1679	Iron
1251	19471.2552	16855.8827	Iron
6200	18955.6951	16546.6673	End Section
6201	19154.0966	16595.9559	INLET TYPE 1A
6202	19193.9906	16605.3975	INLET TYPE 1A
6203	19323.0755	16637.5667	SHALLOW TYPE P MH W/ BEEHIVE FRAME & GRATE
6204	19478.5907	16641.0710	SHALLOW TYPE P MH W/ BEEHIVE FRAME & GRATE
6205	19481.6693	16504.4457	INLET TYPE 1A
6206	19482.5857	16463.7760	INLET TYPE 1A
6207	19485.5517	16332.1494	SHALLOW TYPE P MH W/ BEEHIVE FRAME & GRATE

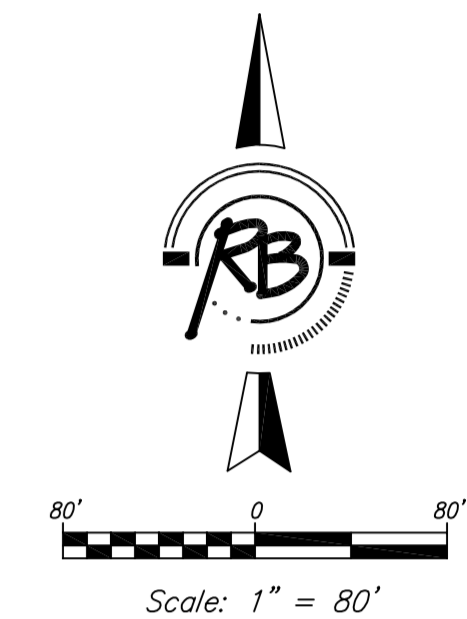

Southwest Passage
Addition Bubble Map
WICHITA, KANSAS

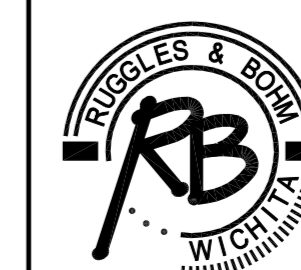

Ruggles & Bohm, P.A.
Engineering, Surveying, Land Planning

924 North Main (316) 264-8008
Wichita, Kansas 67203 (316) 264-4621 fax
www.rbkansas.com E-mail: info@rbkansas.com

DRAWING FILE
PAVING/SWD {KEY MAP}

PROJECT NUMBER
472-84447

DESIGN KWL
DRAWN JDM
REVIEW
UTILITY
DATE Nov. 28, 2007
SHEET 35 OF 36