

BENCHMARKS:
 BM #1: "I" Cut on Top of Curb at West Line of Lot 7, Block A, Auburn Hills 5th Addition. Elev. = 207.73 (City Datum)
 BM #2: Disc in Back of Curb, North of Front Corner Common to Lots 23 and 24, Block D, Auburn Hills 12th Addition. Elev. = 191.84 (City Datum)

P.V.I.
 Elev. = 210.08
 No V.C.

P.V.I.
 Elev. = 208.50
 No V.C.

P.V.I.
 Elev. = 205.00
 No V.C.

Scale: 1" = 20'
 • = Iron

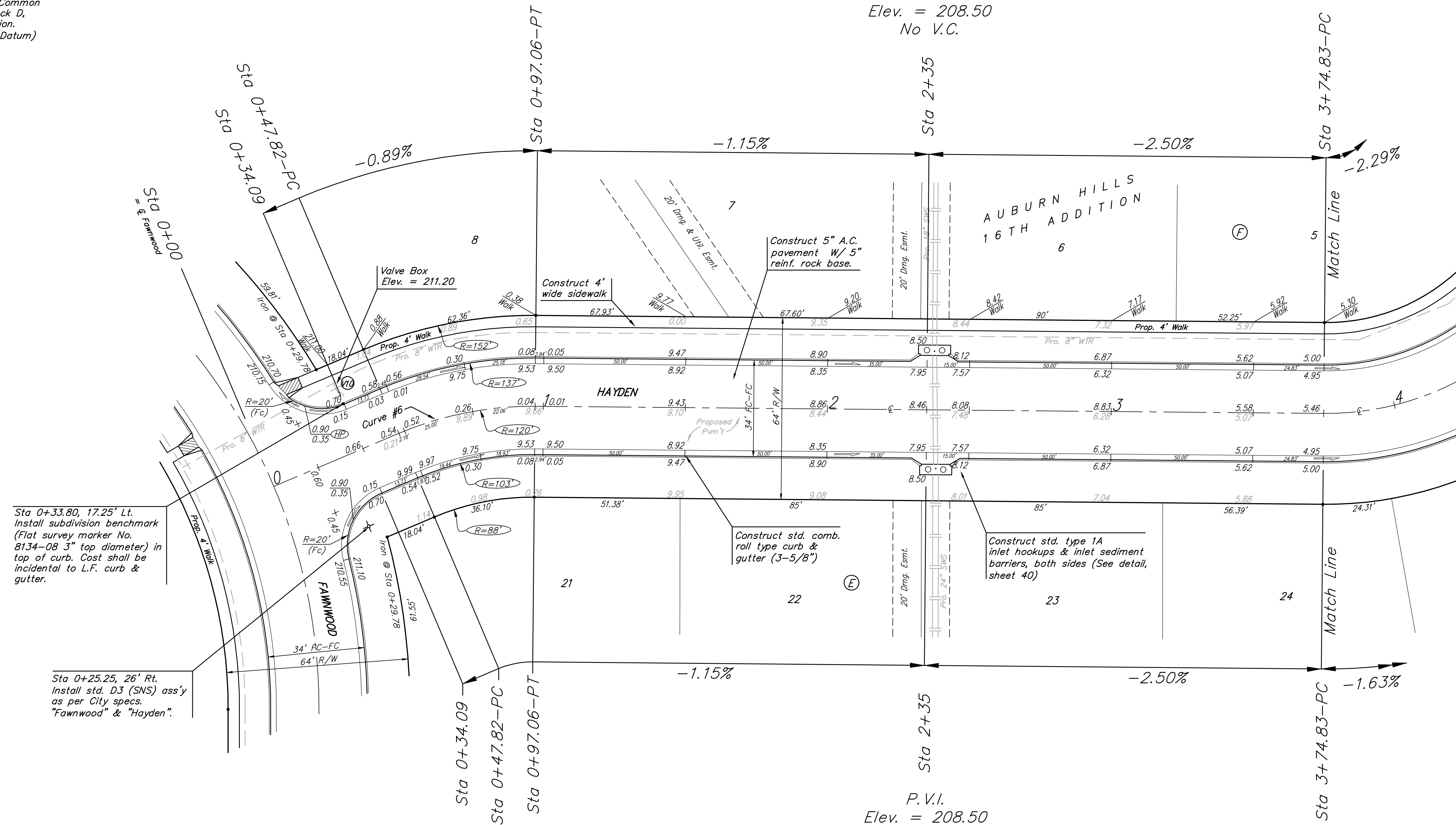

Sta 0+33.80, 17.25' Lt. Install subdivision benchmark (Flat survey marker No. 8134-08 3" top diameter) in top of curb. Cost shall be incidental to L.F. curb & gutter.

Sta 0+25.25, 26' Rt. Install std. D3 (SNS) ass'y as per City specs. "Fawnwood" & "Hayden".

Construct 5" A.C. pavement w/ 5" reinf. rock base.

Construct std. comb. roll type curb & gutter (3-5/8")

Construct std. type 1A inlet hookups & inlet sediment barriers, both sides (See detail, sheet 40)

Trees and shrubs in public right-of-way which are in direct conflict with proposed new construction shall be removed by the Contractor ONLY with the Developer or Baughman Company approval. Trees and shrubs which are not in direct conflict with proposed new construction shall be saved and protected from damage.

NOTE: ROLL TYPE CURB & GUTTER TO BE CONSTRUCTED ON THE PAVEMENT SHOWN ON THIS SHEET. TOP OF CURB ELEVATIONS ARE GIVEN FOR FULL HEIGHT CURB.

Curve #6
 Curve Data Based on Centerline
 Rad. = 120' Delta = 23°30'25" Tangent = 24.97'
 Arc = 49.24' L.C. = 48.89' Def./Ft. = 14.32186 Min.

Station	Arc	Face Chord Lengths		Defl.	Total Defl.
		8' Left	8' Right		
0+47.82	-	-	-	0'00"00"	0'00"00"
0+50.00	2.18'	2.63'	1.73'	0'31"13"	0'31"13"
0+75.00	25.00'	30.15'	19.75'	5'58"03"	6'29"16"
0+97.06	22.06'	26.61'	17.44'	5'15"56"	11'45"12"

WATER VALVE LOCATION TABLE

VALVE NUMBER	BASELINE STATION	OFFSET DISTANCE	OFFSET DIRECTION
V10	0+33.26	25.22'	Lt.

Paving contractor will be responsible to operate all water valves on the project, in the presence of the inspector, to ensure accessibility to the valves, and that all valves are left in the "ON" position when the project is completed.

Baughman HAYDEN
 Auburn Hills 16th Add. - PH. III
 Sta 0+00 to Sta 3+74.83

ENGINEERING | SURVEYING | PLANNING | LANDSCAPE ARCHITECTURE

PROJECT NUMBER: 47284292
 DESIGN: AEG
 DRAWN: JRW
 APPROVED: AEG
 DATE: 12-05-07
 SCALE: Noted
 SHEET: 10 OF 52

AuburnHills16th\Phase3\Str1 07-09-E928