

- Index of Sheets:
 1 Cover Sheet
 2 Plan and Profile
 3 Plan and Profile
 4. Fire Hydrant Details
 5. Water Vault Details

FIRE LINE TO SERVE TRIUMPH AEROSPACE SYSTEMS

LOT 22, COMOTARA INDUSTRIAL PARK 5TH
 9413 E. 34th St. North
 1305 PPW-607853

CITY OF WICHITA, KANSAS
 Jim Armour, P.E., City Engineer

GENERAL NOTES

- Contractor will be required to provide notice to utility companies a minimum of twenty-four (24) hours prior to any excavation, as follows:

Kansas One-Call 687-2470

The Contractor must notify the following in case of an emergency:

Cox Communications 262-4270
 or 263-2061
 Westar Energy/
 Kansas Gas & Electric Company 1-888-482-4950
 Southwestern Bell Telephone Company 1-571-2611
 City of Wichita Water Department 268-4908
 City of Wichita Sewer Department 268-4071
 Aquila Natural Gas 942-8811
 or 1-800-303-0357

- Exist. utilities and their locations, as shown on the plans, represent the best information obtainable for design. Location information has been obtained from the various utility companies and is either from company record drawings or company-provided field locations. The Contractor will be required to work around existing utilities which do not conflict with proposed construction.

- The Contractor to verify utility locations prior to construction of this project.

- Utility service and installation shall be coordinated with the respective utility owners. Contacts are:

Kansas Gas Service	Jim Coe	832-3126
Westar Energy	Miles Capps	261-6251
Aquila Networks	Calvin Briggs	942-8811
Wichita Water	Paul Bryant	268-4555
Southwestern Bell	Jim Taben	268-2759
Cox Communications	Brian Ring	262-4270

- All lawn/turf areas disturbed by construction of proposed improvements shall be restored with seed. All seeding work shall be in accordance with the City of Wichita standard specifications and the City of Wichita administrative regulation No. AR78 which governs cleanup and replacement following construction. All costs for this work shall be subsidiary to the lump sum price bid for "Site Restoration."

- Traffic affected by the construction of this project shall be handled in accordance with the latest edition of the Manual on Uniform Traffic Control Devices.

- All commercial signs to be moved by others prior to construction.

- Properties within the project may have underground irrigation systems (lawn sprinklers) which conflict with new construction. Contractor shall remove such components as needed during construction of the project. The irrigation system shall be reinstalled in like kind before project completion. Any irrigation system modifications required because of project improvements shall be coordinated with the property owner. Portions of underground irrigation systems not in conflict with new construction shall be protected from damage and shall remain in place. All work related to underground irrigations/sprinklers shall be subsidiary to Site Restoration.

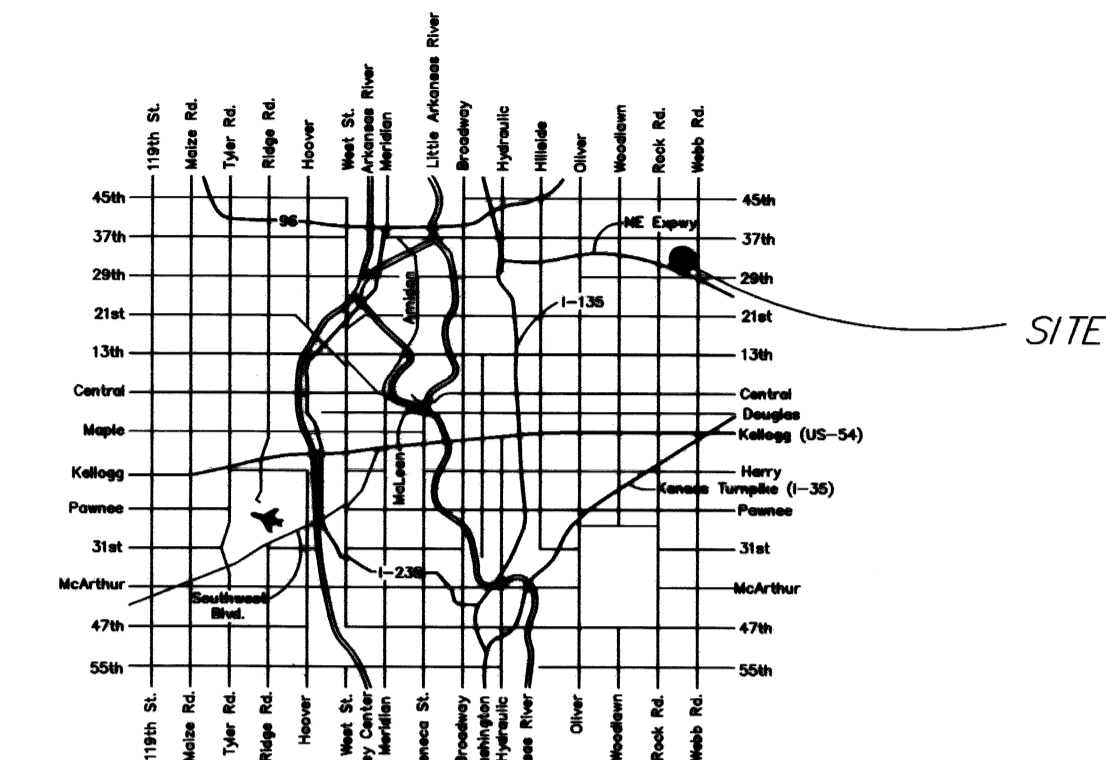
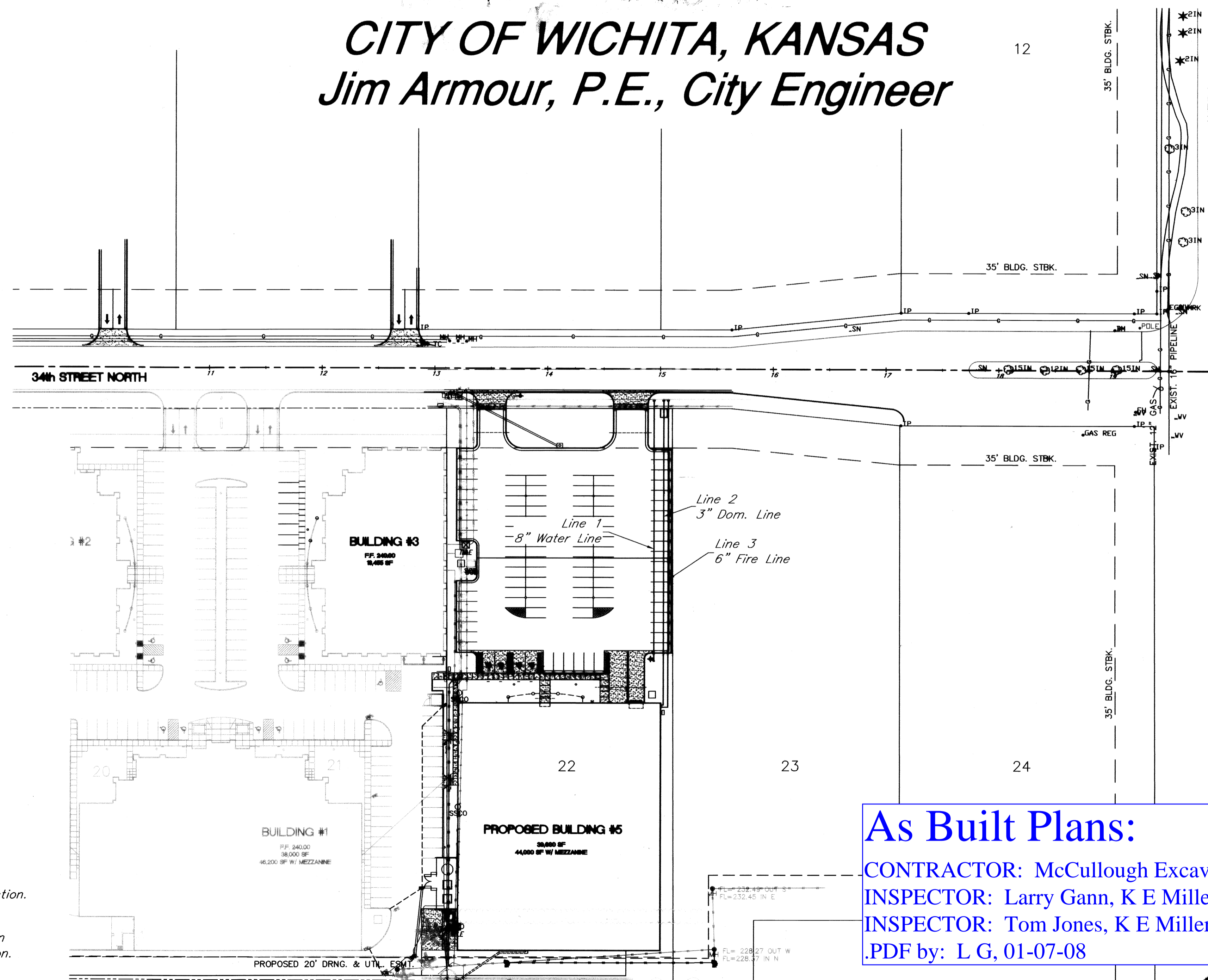

City of Wichita

Benchmark:
 City disc at the NW corner of 34th St. and Webb Rd.
 Elev. = 244.18
 "□" Cut on back of curb between inlets
 N of 34th St.
 Elev. = 232.82

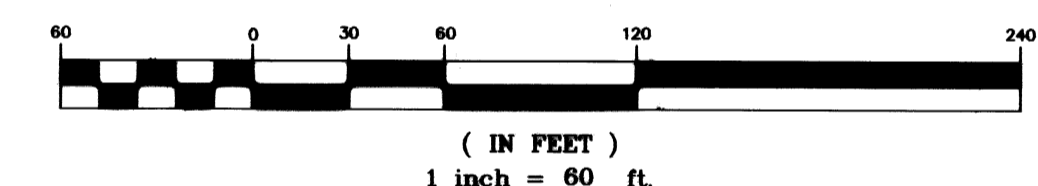

APPROVED AS NOTED
 BY CITY ENGINEER OF WICHITA,
 BY WICHITA WATER & SEWER DEPARTMENT,
 & BY WICHITA FIRE DEPARTMENT

Public Works: [Signature] 6/14/07
 Water & Sewer: [Signature] 6/12/07
 Fire: WFD/PCT 6-12-07

NOTE TO CONTRACTORS
 Public Property:
 Inspection and testing for the waterline is to be provided by a Licensed Consulting Engineering Firm under contract with the Owner/Developer. Said inspection to be in accordance with the City of Wichita standard construction engineering practices and certified by a Professional Engineer Licensed in the state of Kansas. No work shall be performed in dedicated easements or public right-of-way by the Contractor without such inspection nor shall any work be commenced without written authorization by the City Engineer. All Construction and Materials shall comply with the City or Wichita Specifications and Standards (on file and available in the City Engineer's Office).

Private Property:
 Installation and testing for the fire protection line is to be performed by a City of Wichita licensed fire protection contractor in accordance with the fire codes as adopted by the City of Wichita. All material and construction practices for the fire protection line shall comply with the fire codes as adopted by the City of Wichita (available from the City of Wichita Fire Department). The Contractor shall not commence work without notification and approval of the Wichita Fire Department. Inspection of the fire protection line is to be provided by a Licensed Engineering Firm under contract with the Owner/Developer and the Fire Department. The contractor shall not start work until the project inspector is assigned to the project and present on the site. Any work done without inspection will be required to be uncovered for inspection.

As Built Plans:
 CONTRACTOR: McCullough Excavation
 INSPECTOR: Larry Gann, K E Miller Engineering
 INSPECTOR: Tom Jones, K E Miller Engineering
 .PDF by: L G, 01-07-08

MAY, 2007



516 S. Market,
 Wichita, KS 67202 316/264-0242