

Δ=90°00'00" L=14.92' R=9.50' T=9.5'

CURVE TABLE BASED ON CL RADIUS						
STATION	CL ARC	CHORD LENGTH		8' RT. DEFLECTION	TOTAL DEFLECTION	
		8' LT. CL	8' RT. CL		8' RT. DEFLECTION	DEFLECTION
0+51.40 P.C.						
0+64.15	23.60'	43.23'	22.19'	00.00'	34°40'17"	34°40'17"
0+66.32 P.T.	2.57'	5.00'	2.56'	00.00'	3°46'8"	38°26'25"
DEFLECTION/FOOT = 3.016085791 DEGREES		180.965147 MINUTES				

RECORD DRAWING  
1/9/2008 MLT

Δ=55°47'47" L=9.25' R=9.50' T=5.03'

CURVE TABLE BASED ON CL RADIUS						
STATION	CL ARC	CHORD LENGTH		8' RT. DEFLECTION	TOTAL DEFLECTION	
		8' LT. CL	8' RT. CL		8' RT. DEFLECTION	DEFLECTION
1+42.63 P.C.						
1+50.00	7.37'	21.18'	7.19'	00.00'	22°13'29"	22°13'29"
1+51.88 P.T.	1.88'	5.54'	1.88'	00.00'	5°40'25"	27°53'54"
DEFLECTION/FOOT = 3.015567343 DEGREES		180.934040568 MINUTES				

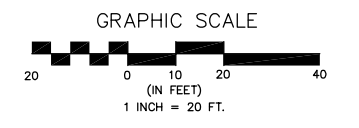

Δ=90°00'00" L=14.92' R=9.50' T=9.50'

CURVE TABLE BASED ON CL RADIUS						
STATION	CL ARC	CHORD LENGTH		8' RT. DEFLECTION	TOTAL DEFLECTION	
		8' LT. CL	8' RT. CL		8' RT. DEFLECTION	DEFLECTION
1+17.72 P.C.						
1+25.00	7.28'	20.94'	7.10'	00.00'	21°57'12"	21°57'12"
1+32.64 P.T.	7.64'	21.92'	7.44'	00.00'	23°2'48"	45°0'0"
DEFLECTION/FOOT = 3.015567343 DEGREES		180.934040568 MINUTES				

Δ=68°39'37" L=36.55' R=30.50' T=20.83'

CURVE TABLE BASED ON CL RADIUS						
STATION	CL ARC	CHORD LENGTH		8' RT. DEFLECTION	TOTAL DEFLECTION	
		8' LT. CL	8' RT. CL		8' RT. DEFLECTION	DEFLECTION
4+34.98 P.C.						
4+41.20	6.22'	2.44'	6.21'	9.98'	5°50'32"	5°50'32"
4+50.00	8.80'	3.45'	8.77'	14.09'	8°15'56"	14°6'28"
4+66.76	16.76'	6.51'	16.55'	26.59'	15°44'32"	29°51'1"
4+71.53 P.T.	4.77'	1.87'	4.76'	7.65'	4°28'48"	34°19'48"
DEFLECTION/FOOT = 0.939275074 DEGREES		56.356504439 MINUTES				

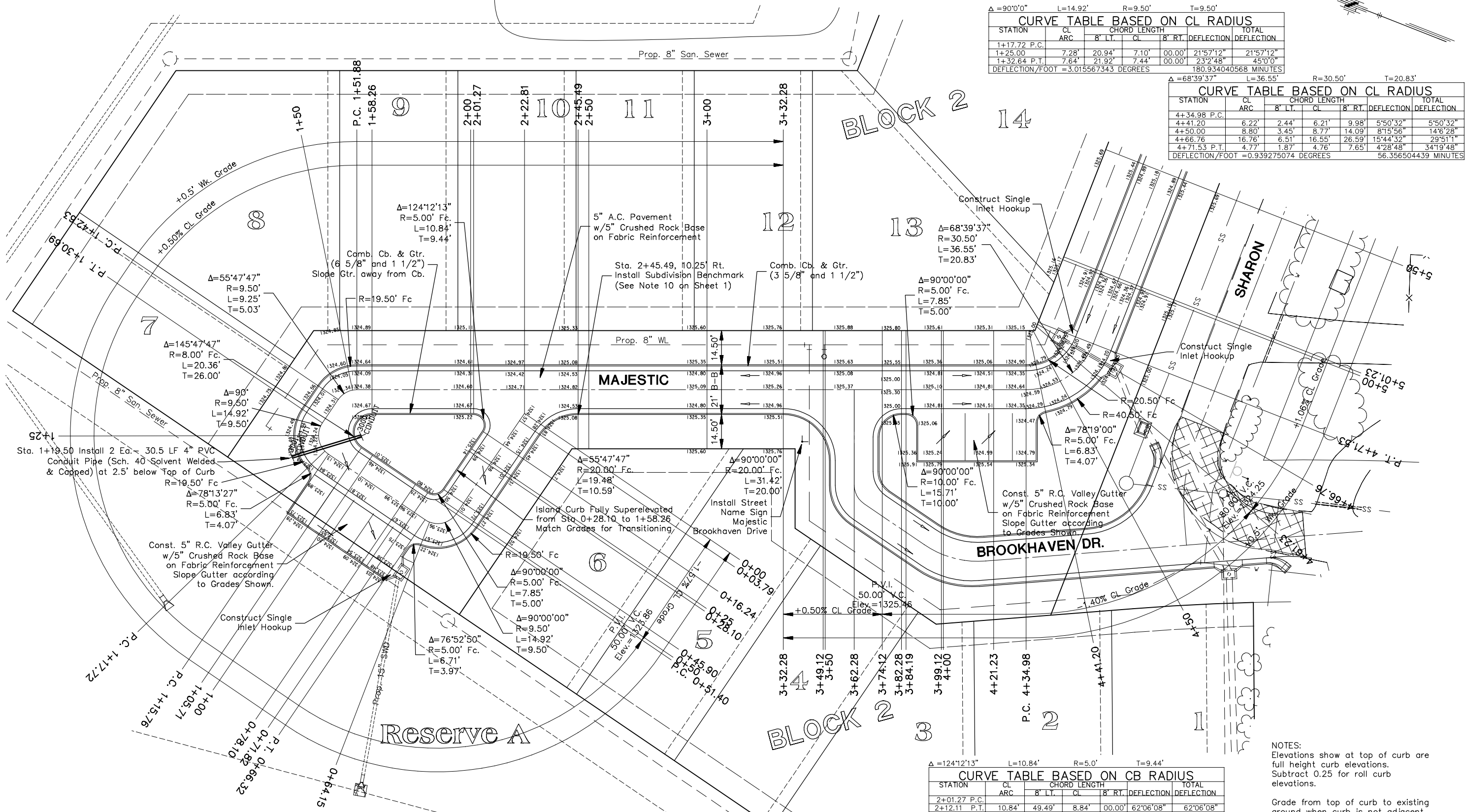

Δ=145°47'47" L=20.36' R=8.00' T=26.00'

CURVE TABLE BASED ON CB RADIUS						
STATION	CL ARC	CHORD LENGTH		8' RT. DEFLECTION	TOTAL DEFLECTION	
		8' LT. CL	8' RT. CL		8' RT. DEFLECTION	DEFLECTION
1+05.71 P.C.						
1+25.00	19.29'	68.19'	14.95'	00.00'	69°4'38"	69°4'38"
1+26.07 P.T.	1.07'	4.86'	1.07'	00.00'	3°49'16"	72°53'54"
DEFLECTION/FOOT = 3.580986220 DEGREES		214.859173174 MINUTES				

Δ=76°52'50" L=26.17' R=19.50' T=15.48'

CURVE TABLE BASED ON CB RADIUS						
STATION	CL ARC	CHORD LENGTH		8' RT. DEFLECTION	TOTAL DEFLECTION	
		8' LT. CL	8' RT. CL		8' RT. DEFLECTION	DEFLECTION
0+51.40 P.C.						
0+75.00	23.60'	31.86'	22.19'	00.00'	34°40'17"	34°40'17"
0+77.57 P.T.	2.57'	3.68'	2.56'	00.00'	3°46'8"	38°26'25"
DEFLECTION/FOOT = 1.469122552 DEGREES		88.147353097 MINUTES				

Δ=90°00'00" L=7.85' R=5.00' T=5.00'

CURVE TABLE BASED ON CB RADIUS						
STATION	CL ARC	CHORD LENGTH		8' RT. DEFLECTION	TOTAL DEFLECTION	
		8' LT. CL	8' RT. CL		8' RT. DEFLECTION	DEFLECTION
0+45.90 P.C.						
0+50.00	4.10'	26.71'	3.99'	00.00'	23°29'29"	23°29'29"
0+53.75 P.T.	3.75'	24.57'	3.67'	00.00'	21°30'31"	45°0'0"
DEFLECTION/FOOT = 5.729577951 DEGREES		343.774677078 MINUTES				

Δ=124°12'13" L=10.84' R=5.00' T=9.44'

CURVE TABLE BASED ON CB RADIUS						
STATION	CL ARC	CHORD LENGTH		8' RT. DEFLECTION	TOTAL DEFLECTION	
		8' LT. CL	8' RT. CL		8' RT. DEFLECTION	DEFLECTION
2+01.27 P.C.						
2+12.11 P.T.	10.84'	49.49'	8.84'	00.00'	62°06'08"	62°06'08"
DEFLECTION/FOOT = 5.728948851 DEGREES		343.73693106 MINUTES				

NOTES:  
Elevations show at top of curb are full height curb elevations. Subtract 0.25 for roll curb elevations.  
Grade from top of curb to existing ground when curb is not adjacent to proposed lots. Ensure that grades do not cause water to pond in these areas.

No.	Street and Station	From CL	Description	Elevation
1	Majestic, 2+45.49	10.25' (W)	Top of Curb (W), at End of Return	1324.83

Reserve A

Reserve A

Revision  
Approved  
By  
Date  
No.

TERRADYNE WEST ADDITION  
STREET IMPROVEMENTS  
MAJESTIC  
CITY OF WICHITA, KANSAS  
JAMES L. ARMOUR, P.E. - CITY ENGINEER  
Private Project # 179PPP O.C.A. # 607679

POE & ASSOCIATES, INC.  
CONSULTING ENGINEERS  
5940 E. Central, Suite 200, Wichita, KS 67208-4242  
Phone 316.685-1111 FAX 316.685-4444

**FINAL**

Designed By: J. Dickman  
Drawn By: M. Tucker  
Poe Job No.: 1809B  
Date: April 2007

Sheet  
3 of 94