

$\Delta = 23'3''34"$ L=36.02' R=89.50' T=18.26'

STATION	CL ARC	CHORD LENGTH			DEFLECTION	TOTAL DEFLECTION
		8' LT.	CL	8' RT.		
6+52.52 P.C.						
6+75.00	22.48'	17.79'	22.42'	27.06'	7'11'44"	7'11'44"
6+88.54 P.T.	13.54'	10.73'	13.53'	16.32'	4'20'3"	11'31'47"
DEFLECTION/FOOT = 0.320088154 DEGREES					19.205289222 MINUTES	

RECORD DRAWING

1/9/2008 MLT

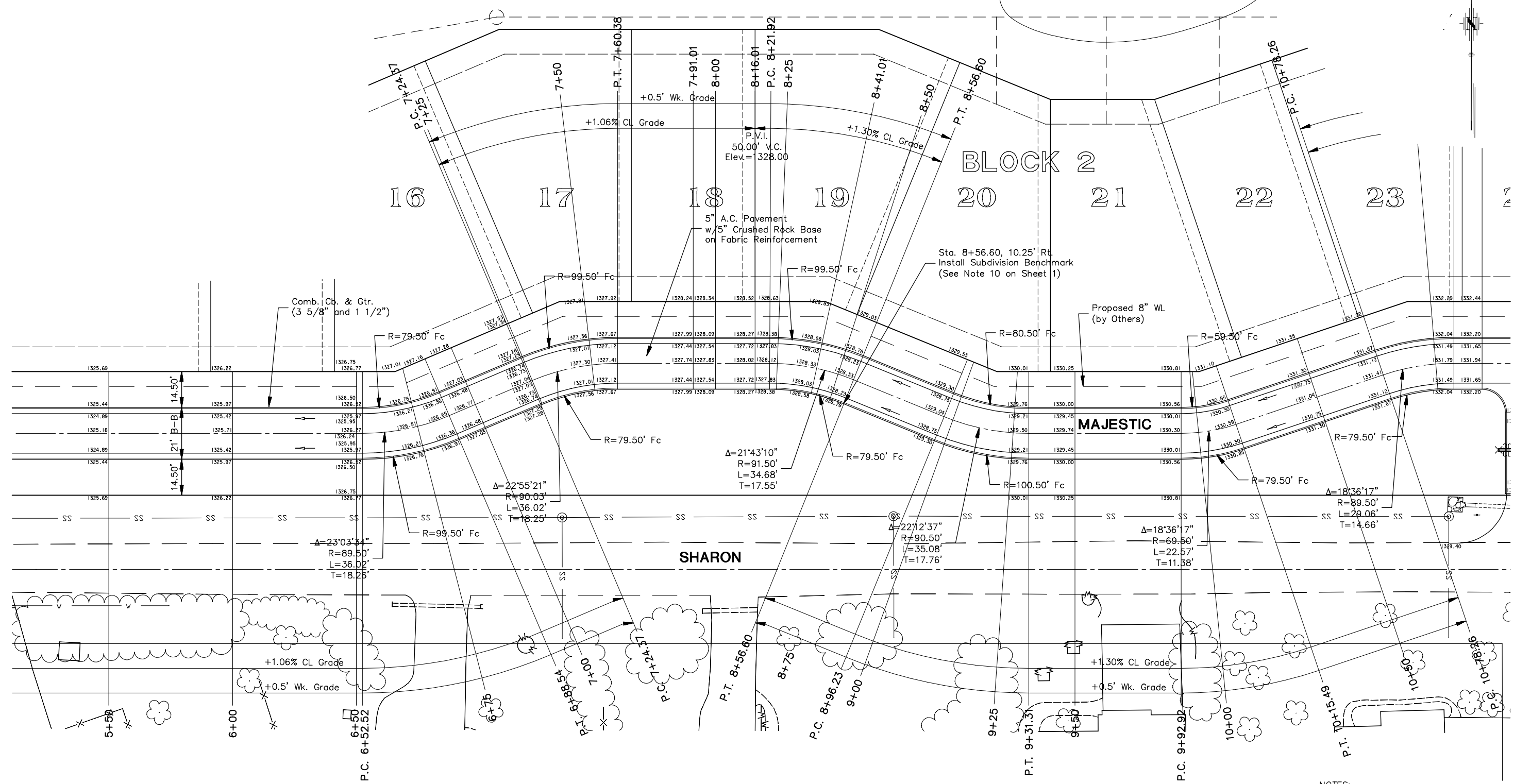
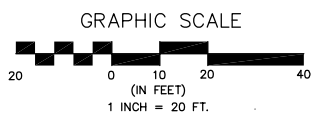

$\Delta = 22'55'21"$ L=36.02' R=90.03' T=18.25'

STATION	CL ARC	CHORD LENGTH			DEFLECTION	TOTAL DEFLECTION
		8' LT.	CL	8' RT.		
7+24.37 P.C.						
7+25.00	00.63'	00.76'	00.63'	00.50'	0'12'2"	0'12'2"
7+25.00	00.00'	00.00'	00.00'	00.00'	0'0'0"	0'12'2"
7+50.00	25.00'	30.04'	24.92'	19.80'	7'57'18"	8'9'20"
7+60.39 P.T.	10.39'	12.52'	10.38'	8.25'	3'18'20"	11'27'41"
DEFLECTION/FOOT = 0.318203818 DEGREES					19.092229095 MINUTES	

$\Delta = 21'43'10"$ L=34.69' R=91.50' T=17.55'

STATION	CL ARC	CHORD LENGTH			DEFLECTION	TOTAL DEFLECTION
		8' LT.	CL	8' RT.		
8+21.92 P.C.						
8+25.00	3.08'	3.70'	3.08'	2.46'	0'57'52"	0'57'52"
8+25.00	00.00'	00.00'	00.00'	00.00'	0'0'0"	0'57'52"
8+41.01	16.01'	19.22'	15.99'	12.76'	5'0'45"	5'58'37"
8+50.00	8.99'	10.80'	8.99'	7.17'	2'48'53"	8'47'30"
8+56.61 P.T.	6.61'	7.94'	6.60'	5.27'	2'4'5"	10'51'35"
DEFLECTION/FOOT = 0.313091691 DEGREES					18.785501480 MINUTES	

$\Delta = 22'12'37"$ L=35.08' R=90.50' T=17.76'

STATION	CL ARC	CHORD LENGTH			DEFLECTION	TOTAL DEFLECTION
		8' LT.	CL	8' RT.		
8+96.23 P.C.						
9+00.00	3.77'	3.00'	3.77'	4.54'	1'11'36"	1'11'36"
9+00.00	00.00'	00.00'	00.00'	00.00'	0'0'0"	1'11'36"
9+25.00	25.00'	19.83'	24.92'	30.01'	7'54'50"	9'6'26"
9+31.31 P.T.	6.31'	5.02'	6.31'	7.60'	1'59'53"	11'6'19"
DEFLECTION/FOOT = 0.316551268 DEGREES					18.993076082 MINUTES	

$\Delta = 18'36'17"$ L=22.57' R=69.50' T=11.38'

STATION	CL ARC	CHORD LENGTH			DEFLECTION	TOTAL DEFLECTION
		8' LT.	CL	8' RT.		
9+92.92 P.C.						
10+00.00	7.08'	5.19'	7.08'	8.96'	2'55'6"	2'55'6"
10+15.49 P.T.	15.49'	11.34'	15.46'	19.57'	6'23'2"	9'18'8"
DEFLECTION/FOOT = 0.412199853 DEGREES					24.731991157 MINUTES	

NOTES:
Elevations show at top of curb are full height curb elevations. Subtract 0.25 for roll curb elevations.
Grade from top of curb to existing ground when curb is not adjacent to proposed lots. Ensure that grades do not cause water to pond in these areas.

No.	Street and Station	From Cl	Description	Elevation
2	Majestic, 8+56.60	10.25' (S)	Top of Curb (S), at P.T. of Curve	1328.53

POE & ASSOCIATES, INC.
CONSULTING ENGINEERS
5940 E. Central, Suite 200 ■ Wichita, KS 67208-4242
Phone 316/685-1111 ■ FAX 316/685-4444

TERRADYNE WEST ADDITION
STREET IMPROVEMENTS
MAJESTIC
CITY OF WICHITA, KANSAS
JAMES L. ARMOUR, P.E. - CITY ENGINEER
Private Project # 179PPP O.C.A. # 607879

DESIGNED BY: J. Dickman
DRAWN BY: M. Tucker
POE JOB NO.: 1809B
DATE: April 2007

4 of 94