

PLAN VIEW

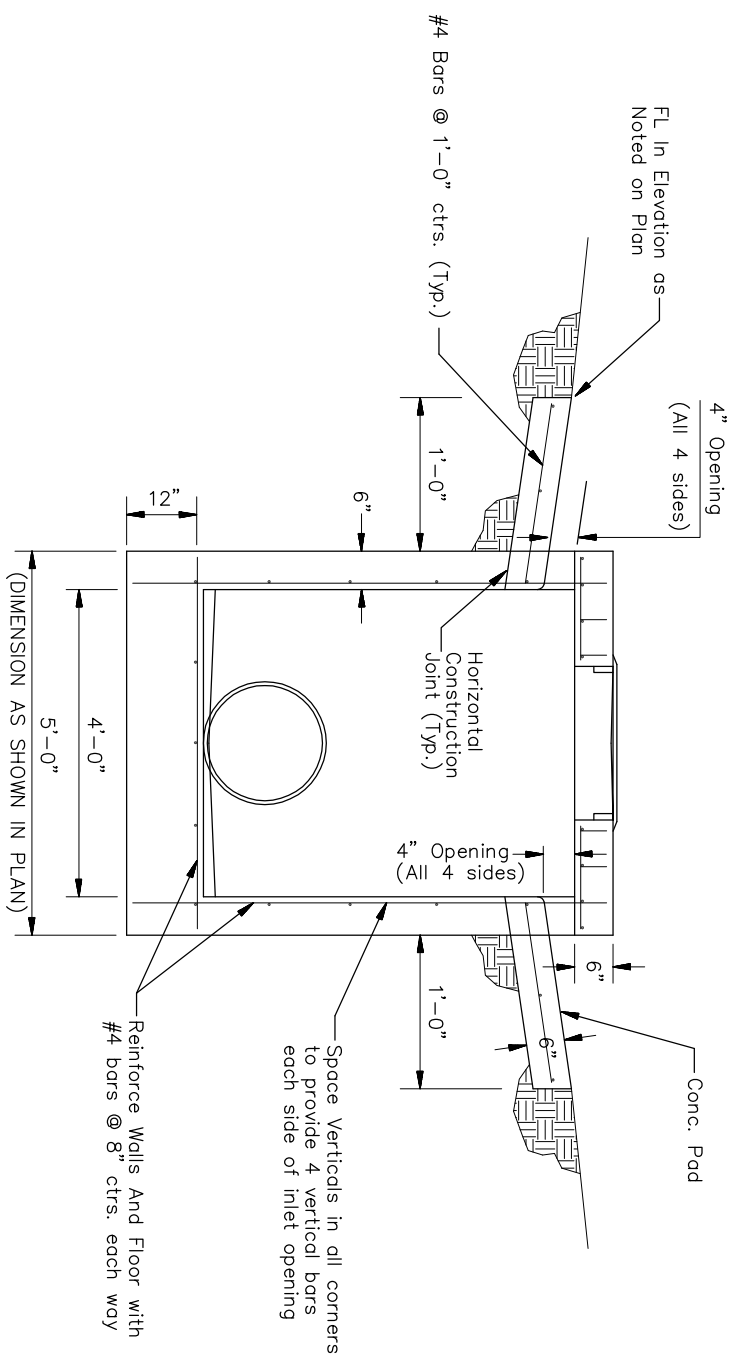

SECTION "A-A"

Shape All Inlet Openings w/ Radius Edging Tool

Space Verticals in all corners to provide 4 vertical bars each side of inlet opening

Conc. Pad

Reinforce Walls And Floor with #4 bars @ 8" ctrs. each way

Horizontal Construction Joint (Typ.)

4" Opening (All 4 sides)

4" Opening (All 4 sides)

1'-0"

6"

6"

1'-0"

12"

4'-0"

5'-0"

(DIMENSION AS SHOWN IN PLAN)

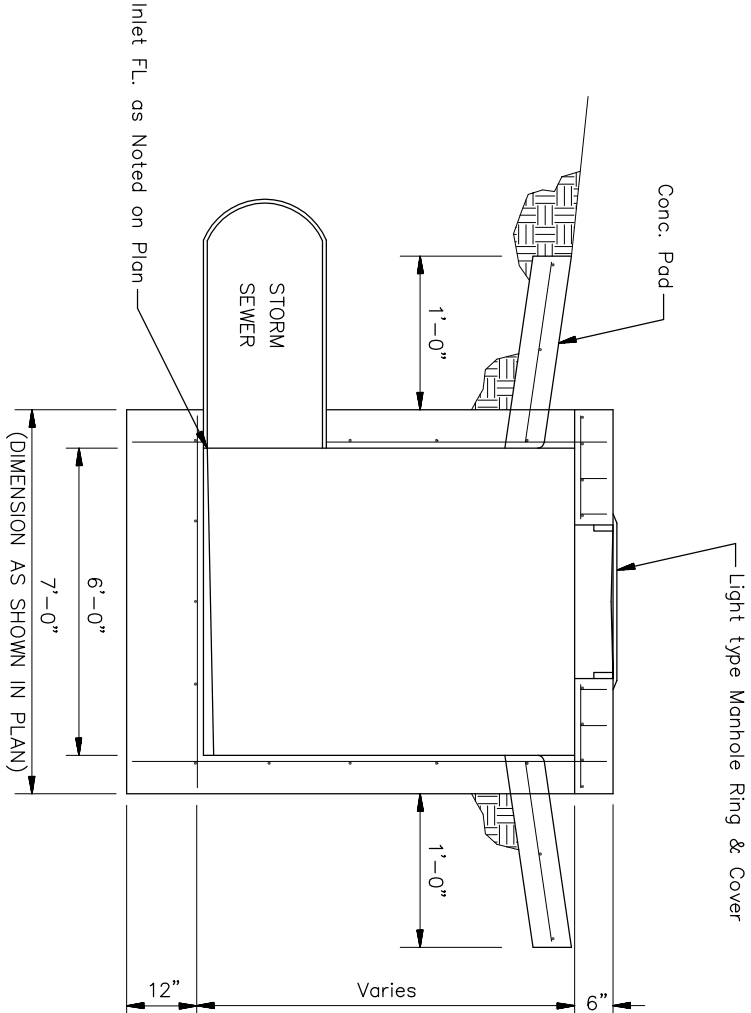

SECTION "B-B"

Inlet FL. as Noted on Plan

Light type Manhole Ring & Cover

Conc. Pad

1'-0"

6'-0"

7'-0"

12"

6"

Varies

1'-0"

(DIMENSION AS SHOWN IN PLAN)

NOT TO SCALE

RECORD DRAWING
1/9/2008
MLT

FINAL	
Designed By:	J. Ubert / J. Dickman
Drawn By:	M. Tucker
Poe Job No.:	1809
Date:	April 2007



POE & ASSOCIATES, INC.
CONSULTING ENGINEERS
5940 E. Central, Suite 200 ■ Wichita, KS 67208-4242
Phone 316/685-4114 ■ FAX 316/685-4444

TERRADYNE WEST ADDITION
STREET & STORM SEWER IMPROVEMENTS
DROP INLET/HAY BALE SEDIMENT BARRIER
CITY OF WICHITA, KANSAS
JAMES L. ARMOUR, P.E. - CITY ENGINEER
Private Project # 179PPP OCA# 607879

No.	Date	By	Approved	Revision
1	1/9/08	MLT	JPD	Moved Curb Inlet South to New Location