

FHWA REGION NO.	STATE	PROJECT NO.	YEAR	SHEET NO.	TOTAL SHEETS
7	KANSAS	87 ER-164(1)	1974	10	28

DAK 574005

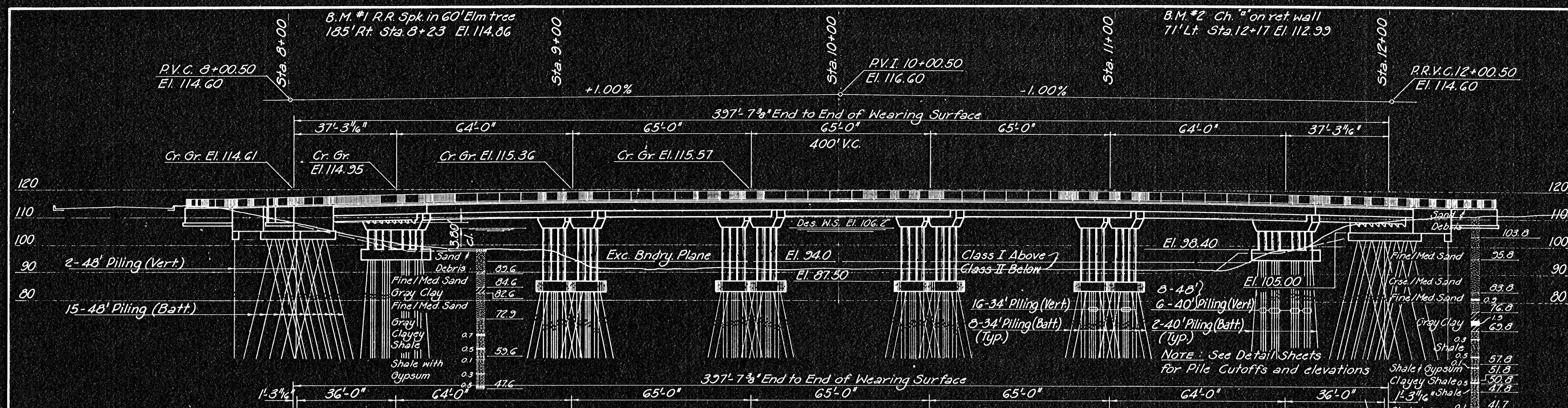

DRAINAGE DATA
 River Mile = 774.19
 Big Arkansas River design discharge = 25,500 cfs. (Corps of Engineers)
 Waterway provided below design water surface 4,783 Sq. Ft.

GEOLOGICAL DATA:
LEGEND:
 Penetration
 50 Blows = 1.0'
 (140 lb. hammer
 30 in. drop)

ELEVATION

36' R.C. Girder Span,
 64'-3" @ 65'-64' Cont.
 Prestressed Concrete
 Beam Spans,
 36' R.C. Girder Span,
 2-27' Roadways,
 6' Median,
 Skew 17° Left
 Sidewalk Lt. & Rt.

Storm Sewer and
 Outfall structure
 by others

SCALE 1"=20'

15' Access Easement

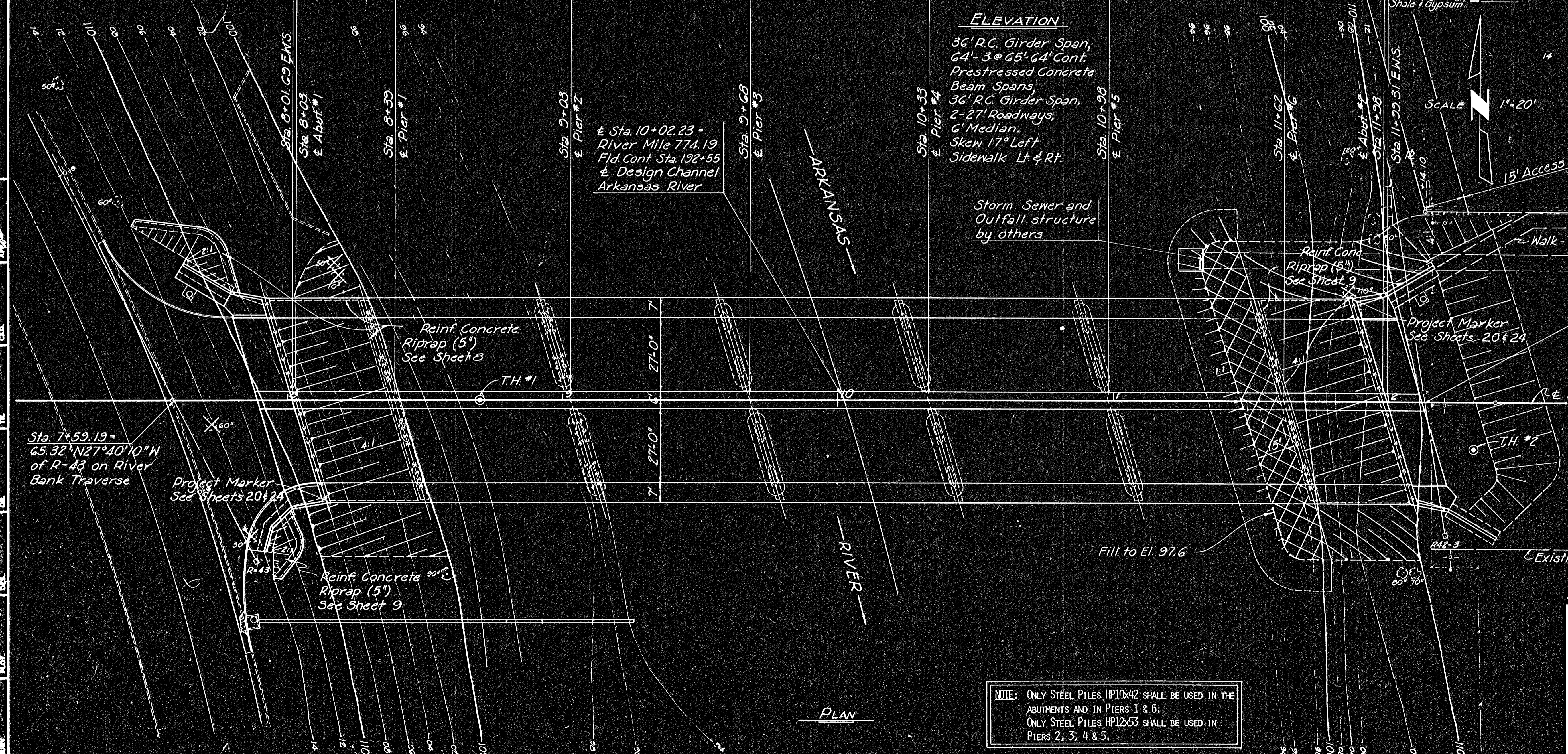

NOTE: ONLY STEEL PILES HP10x42 SHALL BE USED IN THE ABUTMENTS AND IN PIERS 1 & 6.
 ONLY STEEL PILES HP12x53 SHALL BE USED IN PIERS 2, 3, 4 & 5.

Rev. 12/17/74

CITY OF WICHITA, KANSAS R.W. LINN, P. E., CITY ENGINEER	
FIRST STREET BRIDGE OVER THE ARKANSAS RIVER	
CONSTRUCTION LAYOUT	
DELAMATER, FREUND & SCHERER, P.A. CONSULTING ENGINEERS WICHITA, KANSAS	
SCALE 1"=20'	DATE June, 1974