

Gosson Livingston

Architecture
420 South Emporia
Wichita, KS 67202
Tel: (316) 265-9367
Fax: (316) 265-5646
Email: architect@gl.com

© 2007 Gosson Livingston Associates, Inc.

The drawing and all information herein is the exclusive property of Gosson Livingston Associates, Inc. and is not to be copied or used in any way without the express written consent of Gosson Livingston Associates, Inc. All drawings, specifications, ideas, designs and arrangements appearing herein constitute the original and unpublished work of:
Gosson Livingston Associates, Inc.



Johnson & Associates, Inc.
100 E. California Ave. - Third Floor
Oklahoma City, OK 73104
(405) 235-8075 FAX (405) 235-8078
Certificate of Authorization #E-1128 EXP. DATE: 12-31-2008



WATERWALK

PUBLIC IMPROVEMENTS PHASE 2 PACKAGE 3

GRAPHIC SCALE

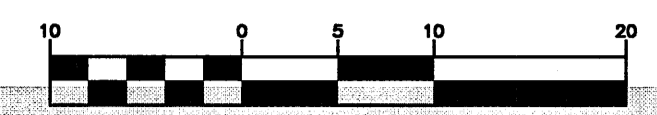

(IN FEET)
1 inch = 10 ft.

WATER WALK PLACE
515 S. MAIN
(UNDER CONSTRUCTION)
F. FLR. 1298.50

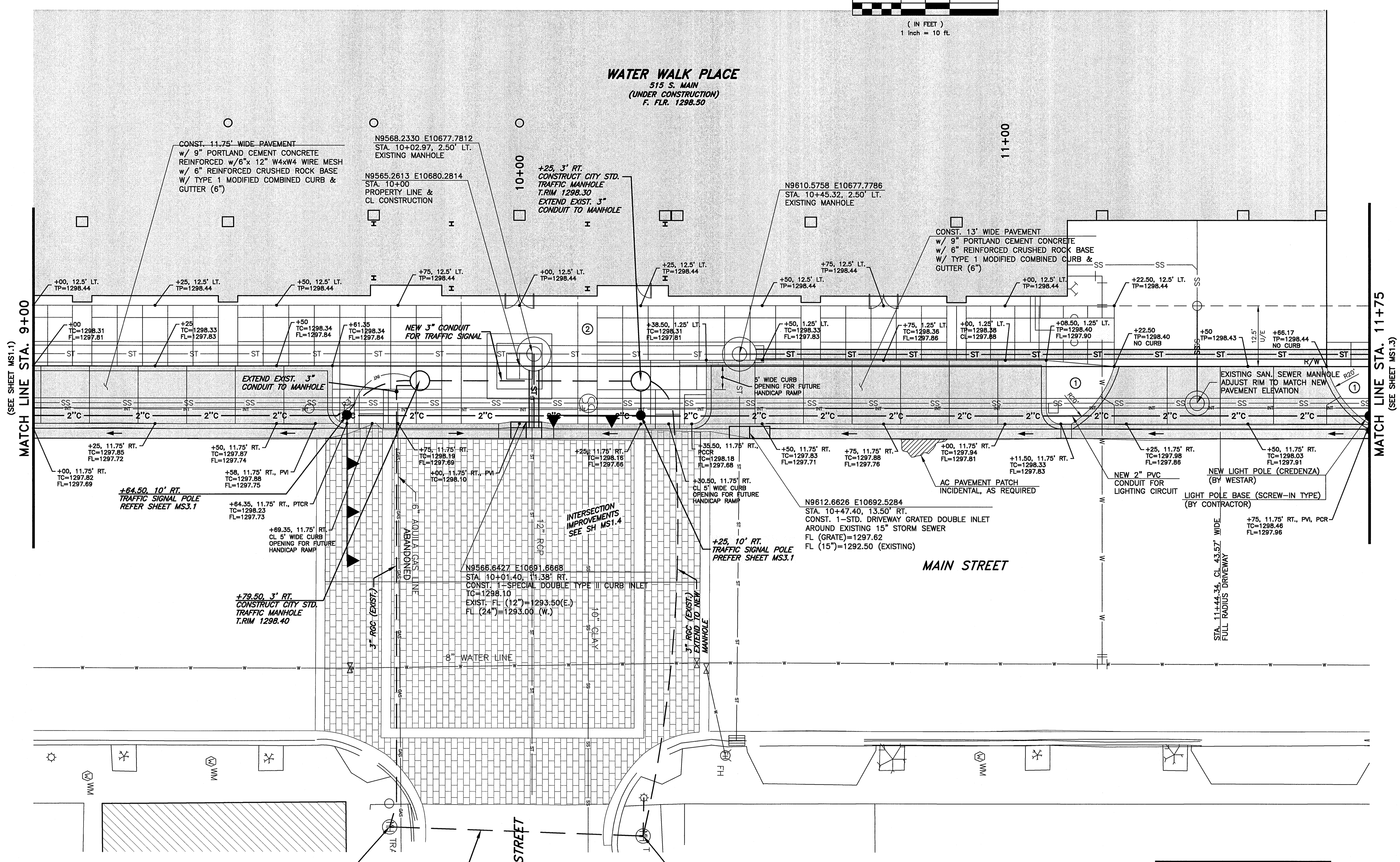

MATCH LINE STA. 9+00
(SEE SHEET MS1.1)

MATCH LINE STA. 11+75
(SEE SHEET MS1.3)

LEWIS STREET

MAIN STREET

- ① PLACE 6" TOPSOIL
INSTALL CURLEX BLANKET
& SEED BETWEEN CURB &
NEW SIDEWALK. COST TO BE
INCIDENTAL TO BID ITEM FOR
EROSION CONTROL.
- ② REFER TO SHEET MS1.5
FOR SIDEWALK DETAILS

LEGEND	
	INTERCONNECT CABLE
	2" PVC CONDUIT FOR LIGHTING CIRCUIT
	LIGHT POLE

Mark	Date	Description
	12/17/07	BID SET
	4/25/07	FIELD CHECK SET

LAYOUT PLAN	
Job No.	MS1.2
Date	12-17-07
Drawn	B.C.
Checked	P.B.
OF 5 35 of 44	

2007 (10/24/07) P:\2007\1215\215 PH 2\1215016 PH 2\1215016-Mon. Street-Eng. 12/15/2007 8:48 AM Peter Bonif