

BL STA 16+59.98 CHAUTAUQUA =  
BL STA 42+81.53 14TH ST. N.  
15.60 S. OF N. CURB LINE &  
15.63 E. OF THE W. CURB LINE.

NEW WATER METER SUMMARY						
No.	BL Station	Lt./Rt.	Service (Long or Short)	Meter Size	Address	AS BUILT
15	17+92.78	Lt.	Short	0.63	1505 N. CHAUTAUQUA ST.	
16	17+92.78	Lt.	Short	0.63	1511 N. CHAUTAUQUA ST.	
17	18+48.07	Lt.	Short	XX	1517 N. CHAUTAUQUA ST.	
18	19+01.19	Lt.	Short	XX	1523 N. CHAUTAUQUA ST.	
19	19+59.70	Lt.	Short	0.63	1527 N. CHAUTAUQUA ST.	
20	19+95.33	Rt.	Long	0.63	1528 N. CHAUTAUQUA ST.	
21	20+61.00	Lt.	Short	0.63	1533 N. CHAUTAUQUA ST.	
22	21+05.44	Lt.	Short	0.63	1539 N. CHAUTAUQUA ST.	
23	21+59.93	Lt.	Short	0.63	1545 N. CHAUTAUQUA ST.	
24	22+21.93	Lt.	Short	XX	1551 N. CHAUTAUQUA ST.	
25	22+67.86	Lt.	Short	0.63	1557 N. CHAUTAUQUA ST.	

STA 22+71.09 LINE 10  
BL STA 22+87.79, 22.00' LT  
1 - 8" 45' MJ BEND (VERT  
AND ROTATED 22.5' LT)  
3.92 L.F. 8" DI CL PIPE

REMOVE OLD FIRE HYDRANT  
AND RETURN TO 1825 S. McLEAN.

BENCHMARK #25:  
1" PIPE @ CL 14TH AND CHAUTAUQUA  
ELEV. = 1342.31 NGVD

BENCHMARK #26:  
"I" CUT ON TOP OF CURB NORTH SIDE OF  
THE NE RETURN @ 15TH AND CHAUTAUQUA  
ELEV. = 1337.68 NGVD

NEW WATER METER SUMMARY						
No.	BL Station	Lt./Rt.	Service (Long or Short)	Meter Size	Address	AS BUILT
26	10+22.22	Lt.	Short	0.63	1601 N. CHAUTAUQUA ST.	
27	10+22.22	Rt.	Long	0.75	1606 N. CHAUTAUQUA ST.	
28	10+22.22	Rt.	Long	XX	1608 N. CHAUTAUQUA ST.	
29	10+22.22	Lt.	Short	0.63	1605 N. CHAUTAUQUA ST.	
30	10+22.22	Lt.	Short	0.63	1611 N. CHAUTAUQUA ST.	
31	10+22.22	Rt.	Long	XX	1620 N. CHAUTAUQUA ST.	
32	10+22.22	Rt.	Long	0.63	1624 N. CHAUTAUQUA ST.	
33	10+22.22	Lt.	Short	0.63	1617 N. CHAUTAUQUA ST.	
34	10+22.22	Rt.	Long	0.63	1628 N. CHAUTAUQUA ST.	
35	10+22.22	Lt.	Short	0.63	1621 N. CHAUTAUQUA ST.	
36	10+22.22	Lt.	Short	0.63	1627 N. CHAUTAUQUA ST.	
37	10+22.22	Rt.	Long	0.63	1632 N. CHAUTAUQUA ST.	
38	10+22.22	Rt.	Long	0.63	1638 N. CHAUTAUQUA ST.	
39	10+22.22	Lt.	Short	0.63	1633 N. CHAUTAUQUA ST.	



SCALE 1" = 40'  
1" = 5' (VERT.)

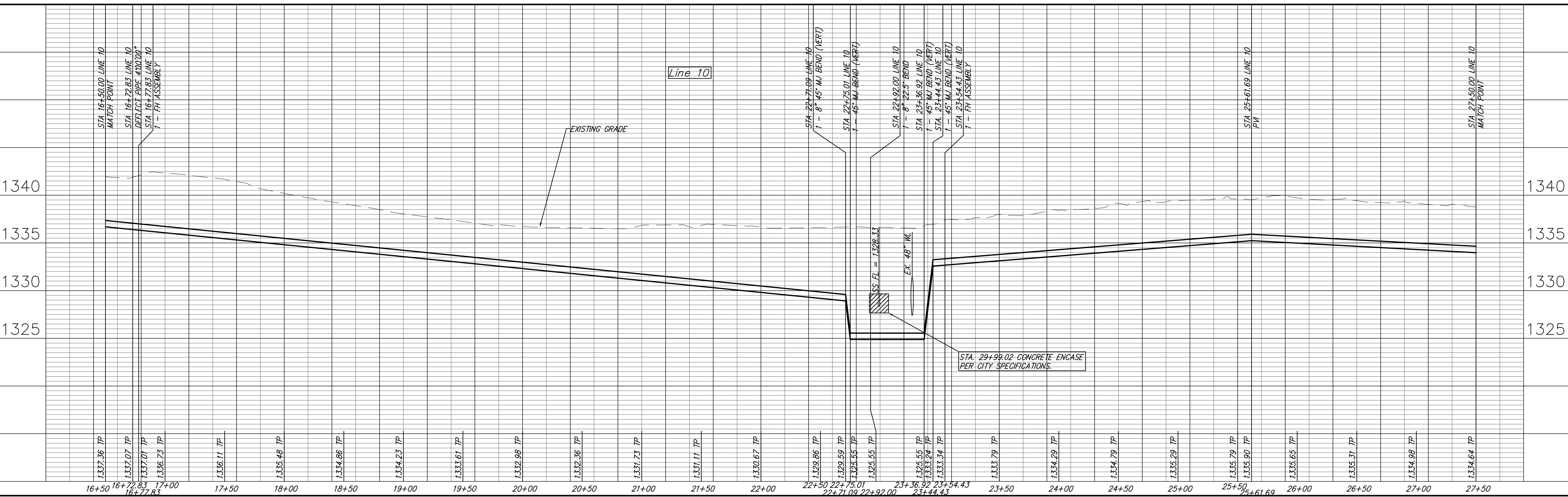

**LOGAN WATER DISTRIBUTION  
CHAUTAUQUA (LINE 10)  
WICHITA, KANSAS**

PROJECT NUMBER 448-90210	DESIGN PC UTILITY	DRAWN MLP	REVIEW REVIEW
DRAWING FILE ENG. BASE \LINE 10B}	DATE Dec. 19, 2006		

RB JOB  
2969W  
SHEET  
22  
OF  
30

**RB**

Ruggles & Bohm, P.A.  
Engineering, Surveying, Land Planning  
1000 W. 12th St., Suite 200  
Wichita, Kansas 67203  
www.ruggles.com  
E-mail: info@ruggles.com