

# STREET IMPROVEMENTS

to serve

## MEADOWLAKE BEACH ADDITION - PH. I

55TH St. S. from the east line of the plat west to the west line of Meadowview  
 Meadowview from the north line of 55th St. S. north to the west line of Maywood  
 Maywood from the west line of Meadowview east to the east line of Elmhurst Cir.  
 Shoffner from the west line of Meadowview west to the west line of Lot 14, Block B  
 Elmhurst Cir. from the south line of Maywood south to and including the cul-de-sac  
 Meadowview Ct. (Lots 33 through 40, Block C) from the east line of Meadowview east to and including the cul-de-sac  
 Meadowview Ct. (Lots 83 through 91, Block A) from the west line of Meadowview west to and including the cul-de-sac  
 Meadowview Ct. (Lots 16 through 21, Block B) from the west line of Meadowview west to and including cul-de-sac

### Benchmark

BM #1 - City of Wichita  
 Benchmark Disc, SE Corner of Clifton and 55th Street South, Southwest corner of RCBC, on top of hubguard at the West end.  
 ELEV. = 1263.29 NGVD29

BM #2 - "□" Cut on wall footing located 29' North of the South end of wall, at the Southeast corner of Lot 7 Block A, Meadowlake Beach Addition, Sedgwick County, Kansas.  
 ELEV. = 1266.82 NGVD29

BM #3 - "□" Cut Top of Curb, West side South end of Concrete street North west of Northeast corner of Meadowlake Beach Addition, Sedgwick County, Kansas.  
 ELEV. = 1262.86 NGVD29

BM #4 - "□" Cut Top of Curb, East return on East side of Concrete street North of the Northwest Corner of Meadowlake Beach Addition, Sedgwick County, Kansas.  
 ELEV. = 1262.95 NGVD29

### CITY OF WICHITA, KANSAS

James L. Armour, P.E. City Engineer

Project Number

**472-84540**

O.C.A. Number:

**766154**

### GENERAL NOTES:

1. Contractor will be required to provide notice to utility companies a minimum of forty-eight (48) hours prior to any excavation, as follows:

Kansas One-Call 687-2470

The Contractor must notify the following in case of an emergency:

Cox Communications	262-4270
Kansas Gas Service	1-888-482-4950
Westar Energy	383-8650
Aquila Energy	1-800-303-0357
SBC	268-2245
City of Wichita Water Dept.	268-4563
City of Wichita Sewer Maint.	268-4024
City of Wichita Storm Sewer Maint.	268-4090
Conoco Phillips Pipeline Co.	268-4034
Southern Star Pipeline Co.	1-877-267-2290
Kinder-Morgan Pipeline Co.	529-6600
Kaneb Pipeline Company	1-888-844-5658
	734-1223

2. Utility service lines, poles, valve boxes, meters, and etcetera are to be adjusted as necessary by others prior to construction unless the plans specifically call for their adjustment by the Contractor or unless the plans specifically identify a utility to be adjusted by its owner during construction. Existing utilities and their location, as shown on the plans, represent the best information obtainable for design. The Contractor will be required to work around existing utilities within the right-of-way which do not conflict with proposed construction.

3. Rubble from the removal of miscellaneous structures and excess excavation which is to be wasted shall be disposed of on sites to be provided by the Contractor. These sites shall be approved by the Engineer as to suitability, appearance and site location. Locations, in the opinion of the Engineer, that will leave an unsightly appearance will not be approved. All disposal sites must be approved by the Kansas Department of Health and Environment. Material either stockpiled or disposed of in a flood plain would require a Kansas State Board of Agriculture permit. Any material dumped in waters of the United States or wetlands is subject to U.S. Corps. of Engineers permitting regulations. Any material buried or stockpiled beyond approved construction limits would require additional archaeological investigations unless buried in a previously approved borrow location.

4. Trees and shrubs in public right-of-way which are in direct conflict with proposed new construction shall be removed by the Contractor with the Engineer's approval. Trees and shrubs which are not in direct conflict with proposed new construction shall be saved and protected from damage.

5. The Contractor shall give all property owners and/or tenants of developed property abutting the construction of this project a minimum of ten (10) days notice prior to start of construction.

6. The Contractor shall be responsible for preserving property irons. The Contractor will be required to re-establish any property irons which are damaged or destroyed by his construction operations. Such irons shall be re-established by a licensed land surveyor in accordance with state laws.

7. All existing and proposed erosion control measures including silt fencing, erosion control mat, straw bales, inlet barriers, and const. entrance shall be maintained throughout construction by the contractor and until project is accepted by the City of Wichita. The on-site engineer shall complete weekly reports on the status of erosion control measures. The contractor shall be required to comply with maintenance and/or replacement of erosion control measures as determined by the on-site engineer until project is accepted by City of Wichita. Maintenance and/or replacement of erosion control measures to be paid by L.S. bid item "Site Clearing & Restoration".

8. All excess excavation shall remain on-site and shall be stockpiled or spread at a location determined by the engineer.

9. A saw cut of at least one-half the depth of existing surface courses or one-fourth the depth of the existing total pavement thickness shall be provided at locations where proposed construction abuts the existing surface course or pavement for which partial removal of that surface or pavement is required. Sawed joint to facilitate removal within three (3) feet of existing joints will not be permitted and for such instances the limits of removal shall extend to the existing joint. Such saw cuts will not be paid for directly and this cost shall be considered as subsidiary to the removal of the surface or pavement.

10. The contractor shall adjust valve boxes as necessary to match proposed grade. Cost to be included in bid item, "Site Clearing & Restoration."

11. Limits of earthwork shall match existing ground elevations at the right-of-way line unless otherwise noted on the plans with a new finished grade elevation. When a new finished grade elevation is shown, the earthwork shall extend one foot beyond the right-of-way line and then slope up or down using permissible slopes to match the existing ground surface.

12. All areas disturbed during construction shall be seeded at 300 lbs./acre with Rye Grass immediately following construction in that area. Contractor shall prepare ground per City Specifications.

13. The developer for this project is Jay Russell, (316) 722-2417

14. Cross Sections Reflect earthwork topography as of 09/10/2007. Contractor shall satisfy himself with the earthwork quantities as bid for excavation and compacted fill prior to bidding. No additional payments or change orders for dirwork will be accepted.

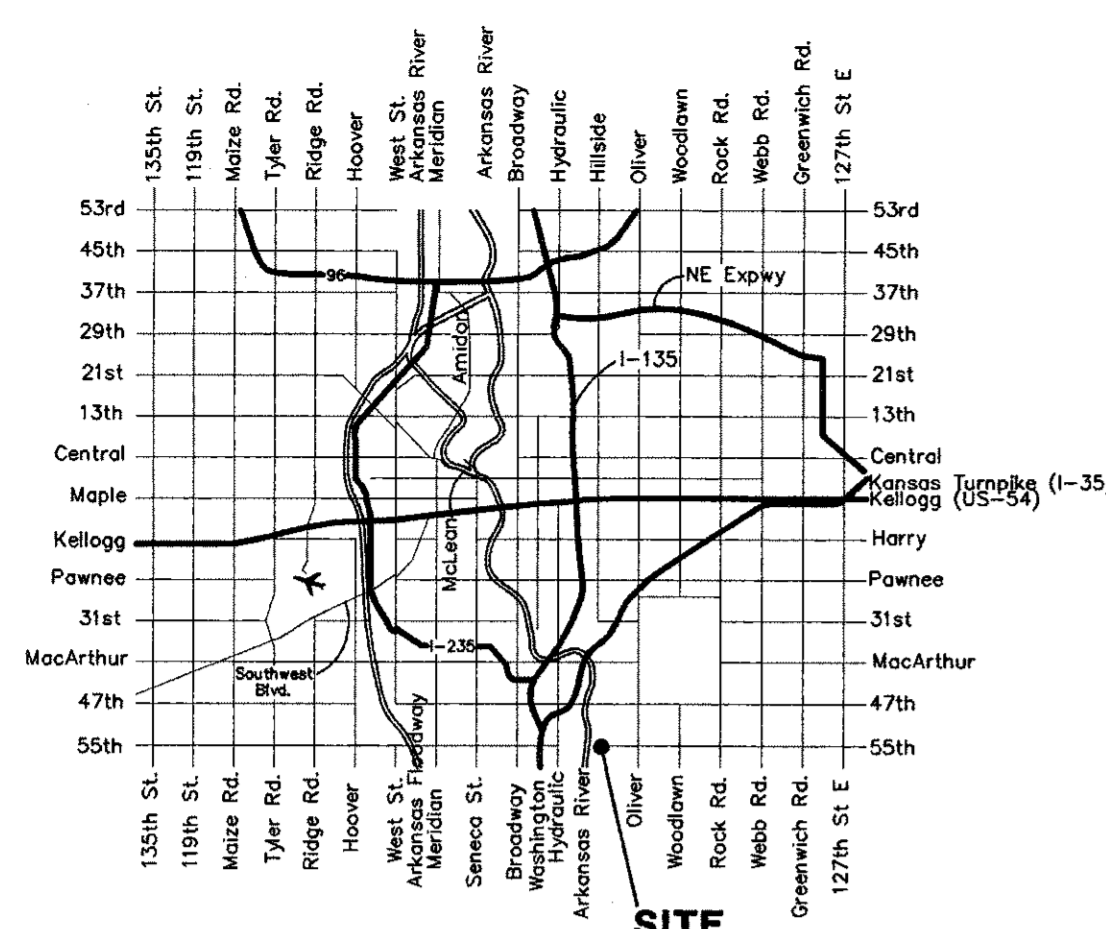

Vicinity Map

Scale: 1" = 150'

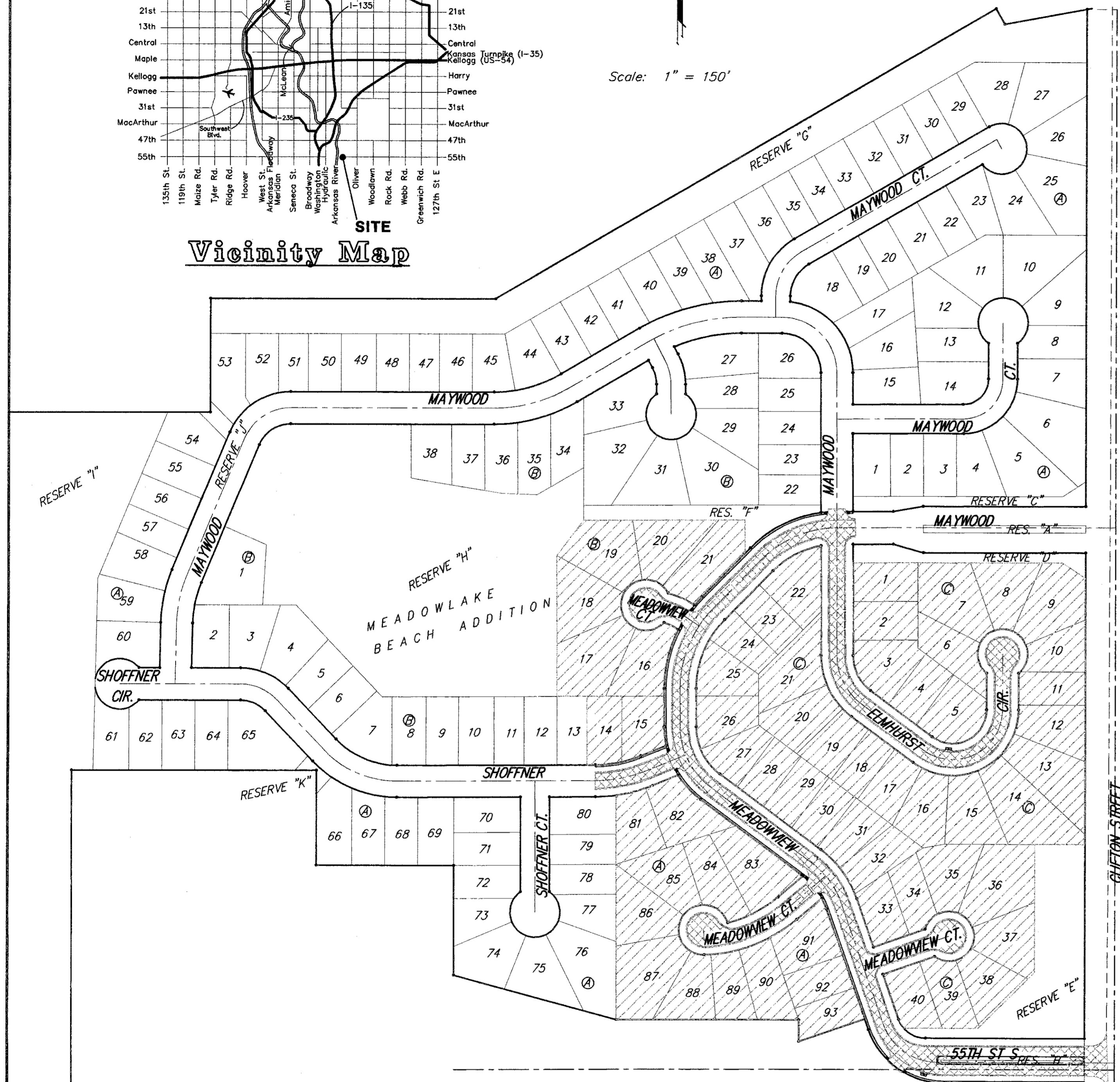

### Sheet Index

Title Sheet	1
35' Pavement Detail	2
29' Pavement Detail	3
Sign Detail	4
Miscellaneous Details	5
Median Detail	6
Meadowview/55th St. S.	7-11
Elmwood Cir.	12-13
Meadowview Ct. (Lots 16-21, Block B)	14
Shoffner	15
Meadowview Ct. (Lots 83-91, Block A)	16
Meadowview Ct. (Lots 33-40, Block C)	17
Erosion Control Plan	18
Soil Erosion BMPs	19-22
Street X-Sections	23-32
Coordinate Sheet	33
Copy of Plat	34

Earthwork Totals  
 Excavation = 2,438 C.Y.  
 Loose Fill = 1,383 C.Y.  
 Compacted Fill = 178 C.Y.

Total Project Length  
 4,226 L.F. = 0.80 Miles

Benefit District:

Proposed Streets:



**Final Plans**  
**01/16/08 ATD**



Baughman Company, P.A. 315 Ellis St. Wichita, KS 67211 P 316-262-7271 F 316-262-0145  
 ENGINEERING | SURVEYING | PLANNING | LANDSCAPE ARCHITECTURE