

BM #1 - City of Wichita  
Benchmark Disc, SE Corner of  
Clifton and 55th Street South,  
Southwest corner of RCBC, on top  
of hubguard at the West end.  
ELEV. = 1263.29 NGVD29

BM #3 - "□" Cut Top of Curb,  
West side South end of Concrete  
street North west of Northeast  
corner of Meadowlake Beach  
Addition, Sedgwick County, Kansas.  
ELEV. = 1262.86 NGVD29

BM #2 - "□" Cut on wall footing  
located 29' North of the South  
end of wall, at the Southeast  
corner of Lot 7 Block A,  
Meadowlake Beach Addition,  
Sedgwick County, Kansas.  
ELEV. = 1266.82 NGVD29

BM #4 - "□" Cut Top of Curb,  
East return on East side of  
Concrete street North of the  
Northwest Corner of Meadowlake  
Beach Addition, Sedgwick County,  
Kansas.  
ELEV. = 1262.95 NGVD29

Scale: 1" = 20' Horizontal

• = Iron

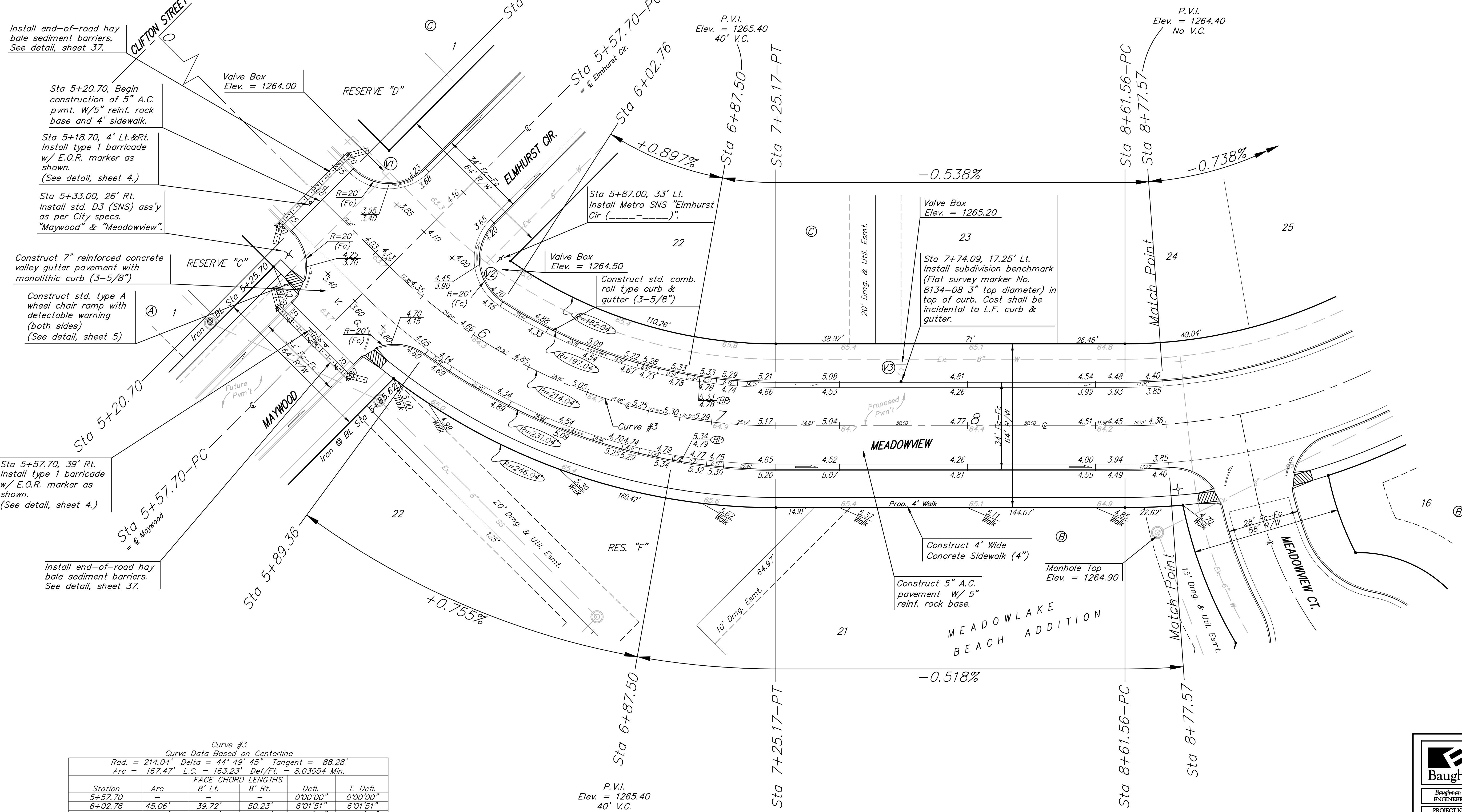

Install end-of-road hay  
bale sediment barriers.  
See detail, sheet 37.

Sta 5+20.70, Begin  
construction of 5" A.C.  
pvm't. W/5" reinf. rock  
base and 4' sidewalk.

Sta 5+18.70, 4' Lt.&Rt.  
Install type 1 barricade  
w/ E.O.R. marker as  
shown.  
(See detail, sheet 4.)

Sta 5+33.00, 26' Rt.  
Install std. D3 (SNS) ass'y  
as per City specs.  
"Maywood" & "Meadowview".

Construct 7" reinforced concrete  
valley gutter pavement with  
monolithic curb (3-5/8")

Construct std. type A  
wheel chair ramp with  
detectable warning  
(both sides)  
(See detail, sheet 5)

Sta 5+57.70, 39' Rt.  
Install type 1 barricade  
w/ E.O.R. marker as  
shown.  
(See detail, sheet 4.)

Install end-of-road hay  
bale sediment barriers.  
See detail, sheet 37.

Curve #3  
Curve Data Based on Centerline  
Rad. = 214.04' Delta = 44° 49' 45" Tangent = 88.28'  
Arc = 167.47' L.C. = 163.23' Def./Ft. = 8.03054 Min.

Station	Arc	FACE CHORD LENGTHS		Defl.	T. Defl.
		8' Lt.	8' Rt.		
5+57.70	-	-	-	0'00"00"	0'00"00"
6+02.76	45.06'	39.72'	50.23'	6'01'51"	6'01'51"
6+25.00	22.24'	19.63'	24.83'	2'58'36"	9'00'27"
6+50.00	25.00'	22.07'	27.90'	3'20'46"	12'21'13"
6+75.00	25.00'	22.07'	27.90'	3'20'46"	15'41'59"
7+00.00	25.00'	22.07'	27.90'	3'20'46"	19'02'45"
7+25.17	25.17'	22.22'	28.09'	3'22'08"	22'24'52"

P.V.I.  
Elev. = 1265.40  
40' V.C.

NOTE:  
ROLL TYPE CURB & GUTTER TO  
BE CONSTRUCTED ON THE  
PAVEMENT SHOWN ON THIS SHEET.  
TOP OF CURB ELEVATIONS ARE  
GIVEN FOR FULL HEIGHT CURB.

**Baughman** MEADOWVIEW  
MEADOWLAKE BEACH ADD. - PH. I  
STA 5+20.70 TO STA 8+77.57

Baughman Company, P.A. 315 Ellis St. Wichita, KS 67211 P3162627271 F3162620149  
ENGINEERING | SURVEYING | PLANNING | LANDSCAPE ARCHITECTURE

PROJECT NUMBER 412-84540	DESIGN ATD	DRAWN TMS
REVISIONS:	APPROVED	DATE 01/08
	SCALE Noted	SHEET 7 OF 34

MeadowlakeBeach\Str1 06-10-E679