

BM #1 - City of Wichita
Benchmark Disc, SE Corner of
Clifton and 55th Street South,
Southwest corner of RCBC, on top
of hubguard at the West end.
ELEV. = 1263.29 NGVD29

BM #2 - "□" Cut on wall footing
located 29' North of the South
end of wall, at the Southeast
corner of Lot 7 Block A,
Meadowlake Beach Addition,
Sedgwick County, Kansas.
ELEV. = 1266.82 NGVD29

BM #3 - "□" Cut Top of Curb,
West side South end of Concrete
street North west of Northeast
corner of Meadowlake Beach
Addition, Sedgwick County, Kansas.
ELEV. = 1262.86 NGVD29

BM #4 - "□" Cut Top of Curb,
East return on East side of
Concrete street North of the
Northwest Corner of Meadowlake
Beach Addition, Sedgwick County,
Kansas.
ELEV. = 1262.95 NGVD29

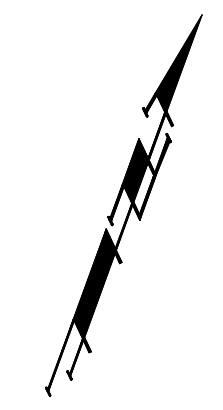

Scale: 1" = 20' Horizontal

• = Iron

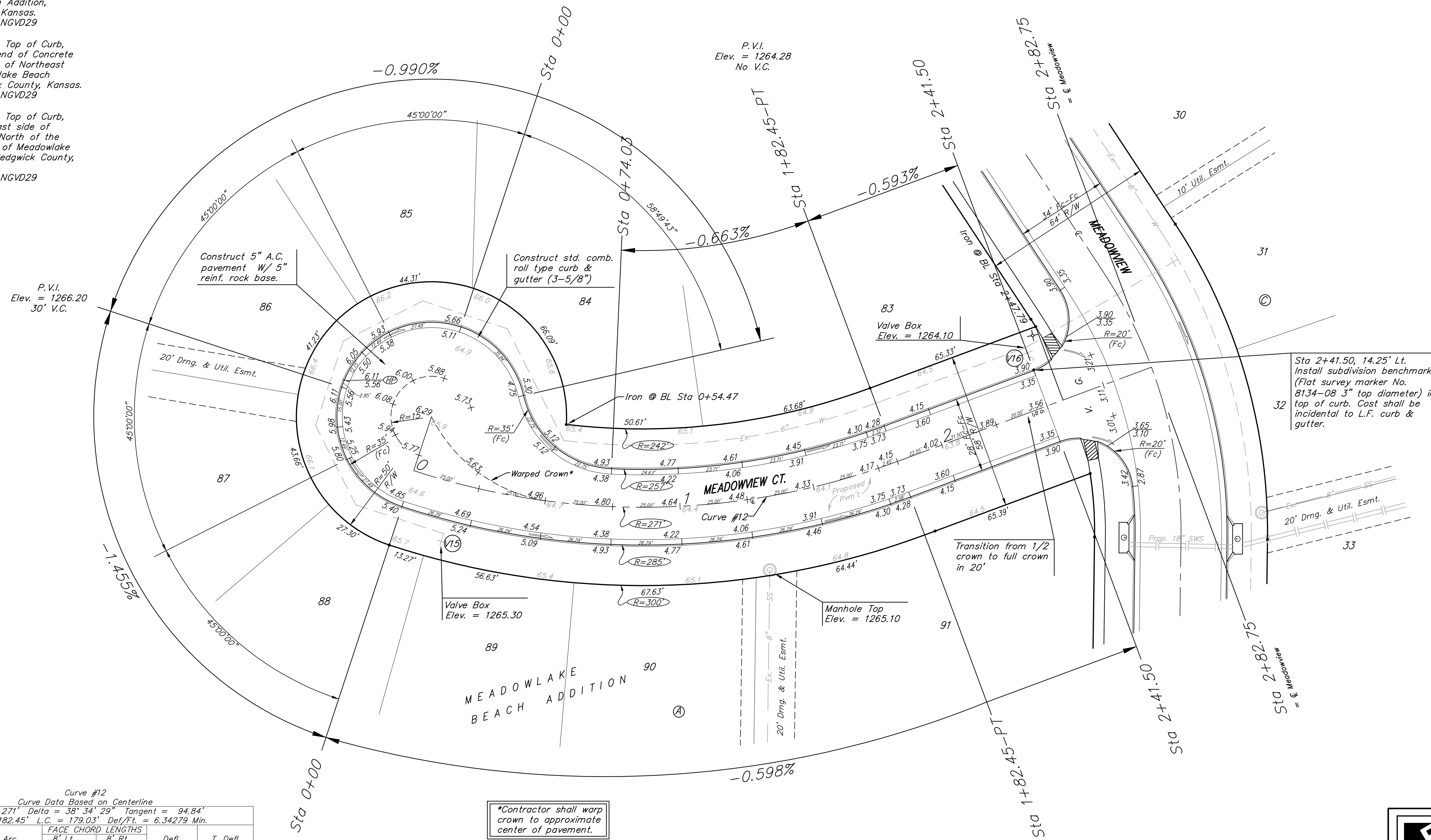

Curve #12
Curve Data Based on Centerline
Rad. = 271' Delta = 38° 34' 29" Tangent = 94.84'
Arc = 182.45' L.C. = 179.03' Def/Ft. = 6.34279 Min.

Station	Arc	FACE CHORD LENGTHS		Defl.	T. Defl.
		8' Lt.	8' Rt.		
0+00.00	-	-	-	0°00'00"	0°00'00"
0+25.00	25.00'	22.96'	27.02'	2°38'34"	2°38'34"
0+50.00	25.00'	22.96'	27.02'	2°38'34"	5°17'08"
0+74.03	24.03'	22.07'	25.97'	2°32'25"	7°49'33"
1+00.00	25.97'	23.85'	28.07'	2°44'43"	10°34'17"
1+25.00	25.00'	22.96'	27.02'	2°38'34"	13°12'51"
1+50.00	25.00'	22.96'	27.02'	2°38'34"	15°51'25"
1+75.00	25.00'	22.96'	27.02'	2°38'34"	18°29'59"
1+82.45	7.45'	6.85'	8.05'	0°47'15"	19°17'14"

*Contractor shall warp
crown to approximate
center of pavement.

P.V.I.
Elev. = 1265.40
No V.C.

NOTE:
ROLL TYPE CURB & GUTTER TO
BE CONSTRUCTED ON THE
PAVEMENT SHOWN ON THIS SHEET.
TOP OF CURB ELEVATIONS ARE
GIVEN FOR FULL HEIGHT CURB.

Baughman		MEADOWLAKE BEACH ADD. - PH. I	
		MEADOWVIEW CT.	
		LOTS 83-91, BLOCK A	
Baughman Company, P.A. 315 Ella St. Wichita, KS 67211 P3162627271 F3162620149			
ENGINEERING SURVEYING PLANNING LANDSCAPE ARCHITECTURE			
PROJECT NUMBER 412-84540	DESIGN ATD	DRAWN TMS	APPROVED DATE 01/08
REVISIONS:	SCALE Noted	SHEET 16 OF 34	
MeadowlakeBeach\Str10		06-10-E679	