

**PAVING AND INCIDENTAL DRAINAGE PLANS FOR
THE WATERFRONT RESIDENTIAL ADD.
ENTRY PHASE**

**VERANDA
ENTRY PAVING**
SHEET TITLE
472-84598
PROJECT NUMBER

DFL
DESIGN BY
DMU
DRAWN BY
GJA
CHECKED BY

ISSUED
January 2008
REVISED

SHEET NO.
8 of 23

WATERFRONT 6TH ADDITION

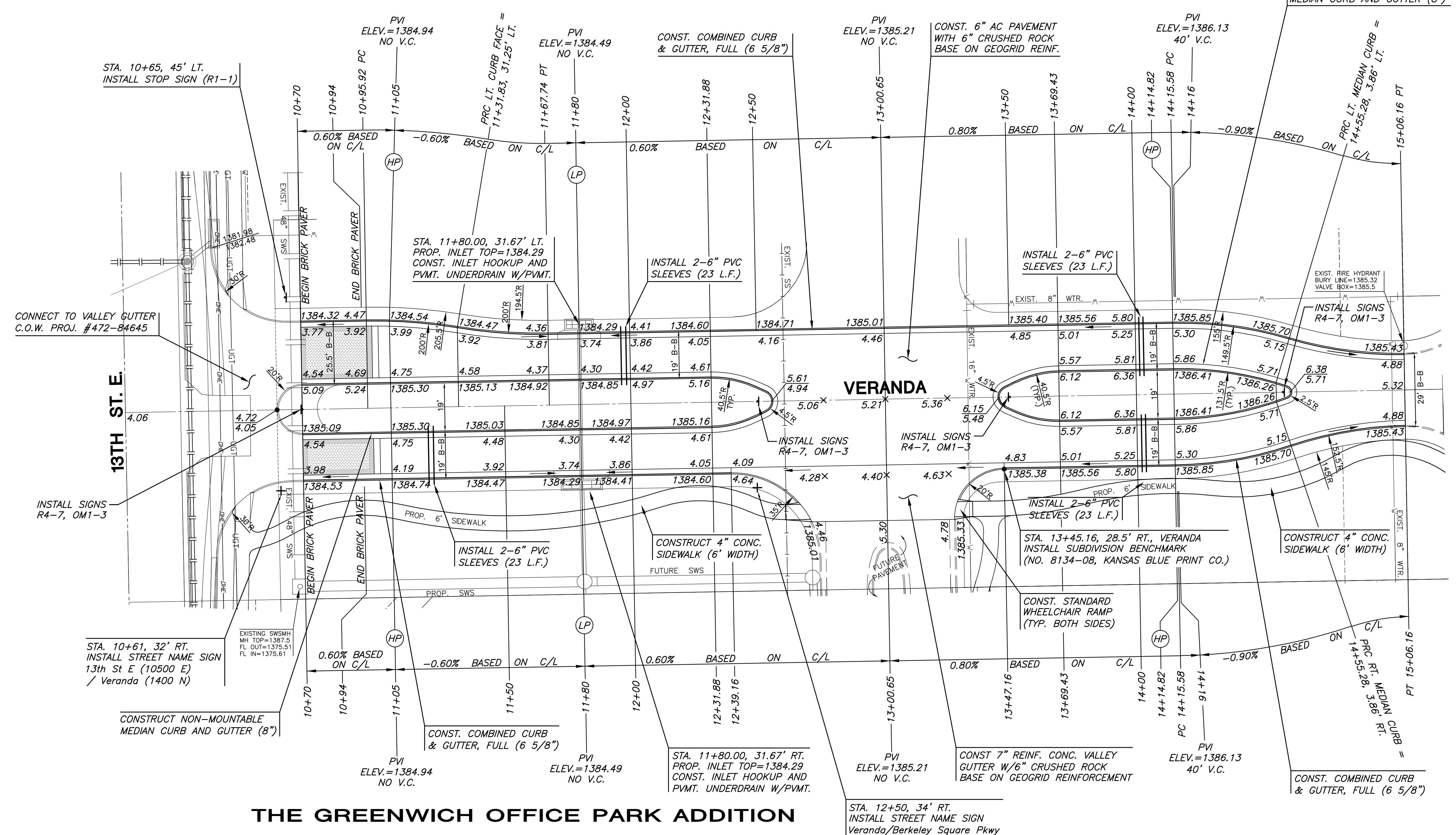

THE GREENWICH OFFICE PARK ADDITION

SUBDIVISION BENCH MARKS				
NO.	STREET AND STATION	FROM CL	DESCRIPTION	ELEVATIONS
1	VERANDA, STA. 13+45.16	28.5' RT	TOP OF CURB AT N. END OF N. CURB RETURN OF VALLEY GUTTER	

NOTE: CONTRACTOR SHALL INSTALL SUBDIVISION BENCH MARKS ("FLAT SURVEY MARKERS NO. 8134-08 3" TOP DIAMETER" PROVIDED BY KANSAS BLUE PRINT CO., INC.) COSTS TO BE CONSIDERED SUBSIDIARY TO CONSTRUCTION OF COMBINED CURB AND GUTTER.

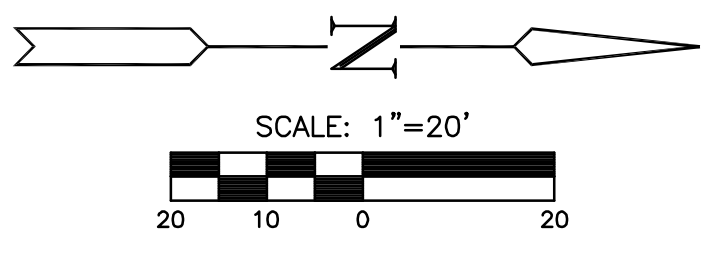

NOTE:
TOP OF CURB ELEVATIONS SHOWN
ARE FOR FULL CURB. CONSTRUCT
CURB AND GUTTER AS NOTED.

LEGEND
+ STREET SIGN & SIGN LOCATION
(SEE SIGN ASSEMBLY TABLE
FOR TYPE & STATION OF SIGN)

PLOTTED: Wednesday, January 16, 2008 @ 09:37PM

J:\CIVIL\06266\DWG\PAV\ENTRY\06266_E1.DWG