

West Rail Plan View

Scale 1/4"=1'-0"

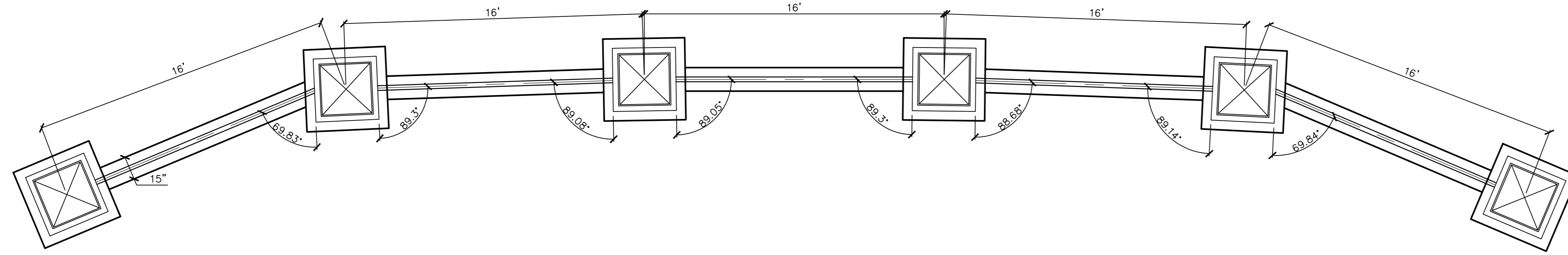

East Rail Plan View

Scale 1/4"=1'-0"

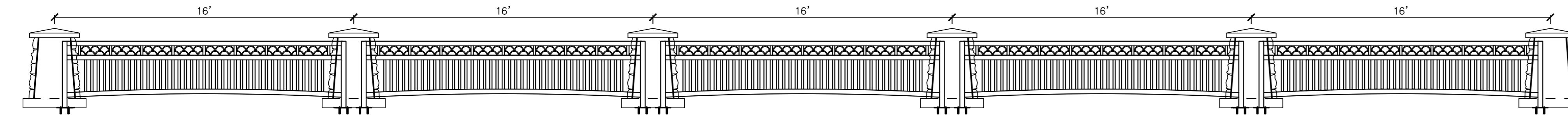

Railings Elevation

Scale 1/4"=1'-0"

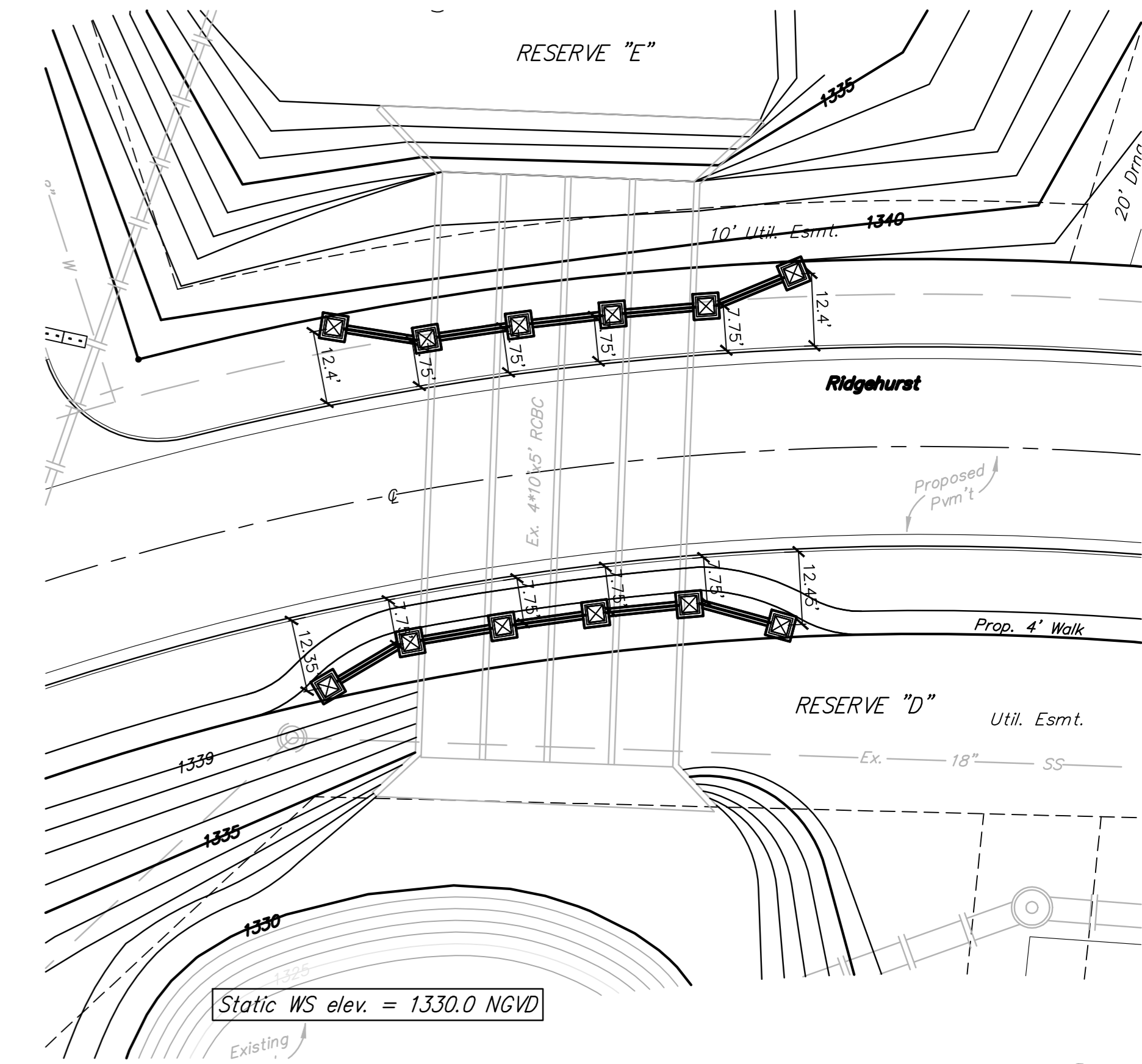

Culvert Railings

Scale 1"=20'-0"

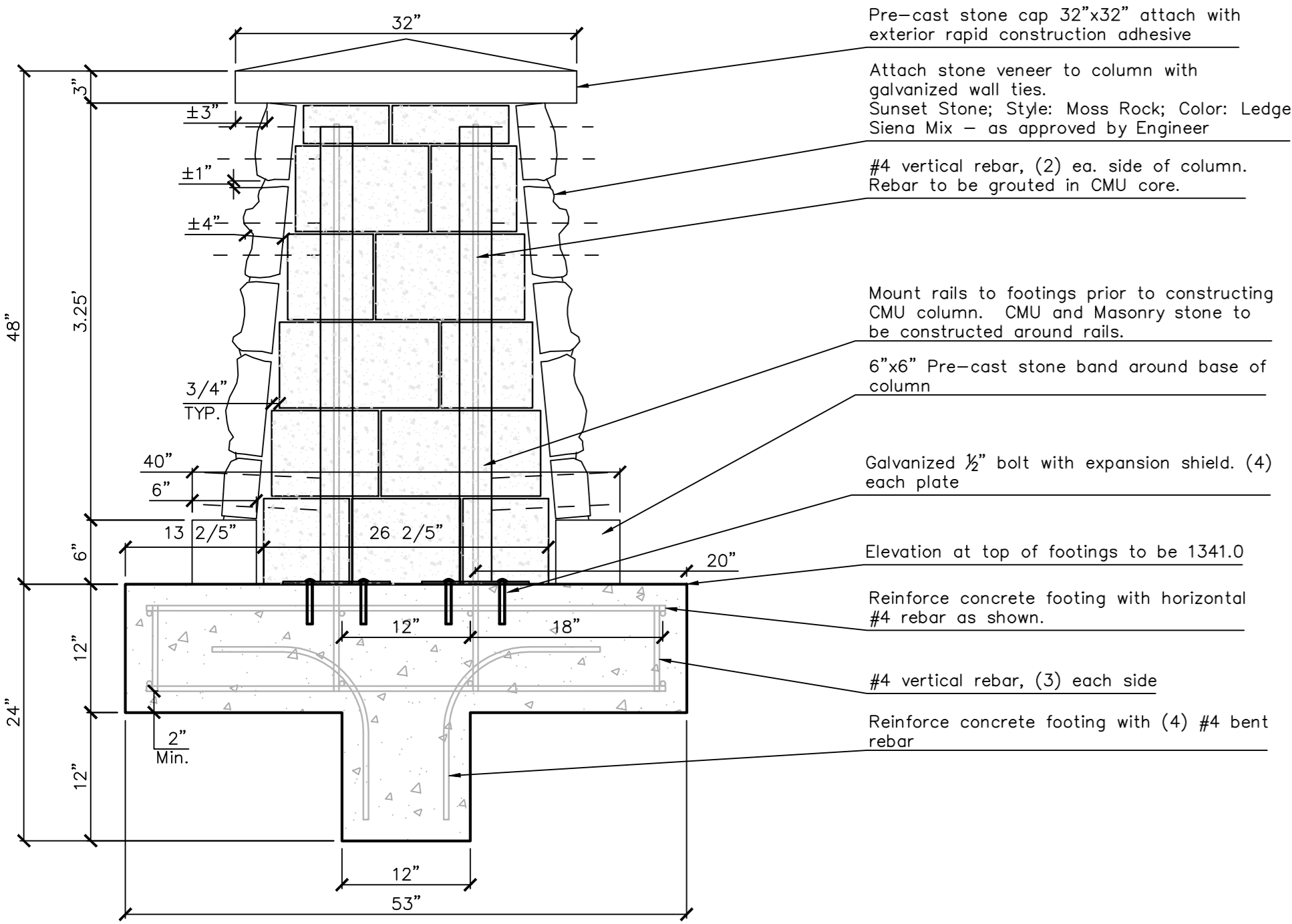

Columns and Footings

Scale 1"=1'-0"

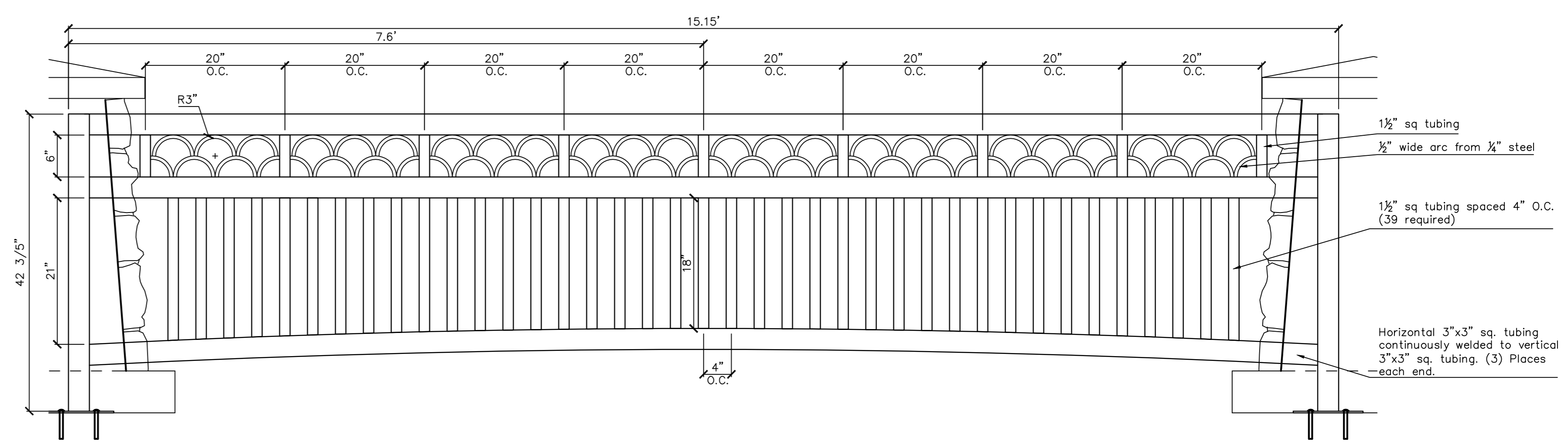

Rail Elevation

Scale 1"=1'-0"

RAILING NOTES:

- The horizontal members of the rail and posts shall be hollow structural tubing. All structural steel and tubing shall comply to A.S.T.M. Designation A36 or A500 Grade B respectively.
- Rail shall be fabricated in lengths as shown.
- Posts and bars shall be set vertical and shimmed if required.
- Abrasive blast to commercial finish SSPC-Sp6, prior to painting steel rails, to obtain a surface profile of 1 1/2 Mil. Shop and field coats shall conform to an inorganic Zinc primer with water-borne Acrylic finish coat. Color shall be a rustic-red type. Final color to be approved by developer.
- Shop details must be submitted and approved by the Engineer.
- Material and construction shall conform to the Structural Welding Code A.W.S. D1.1-88.
- All costs associated with construction of handrails, columns, mow strips, etc. as shown shall be incidental to LS bid item "Handrails".

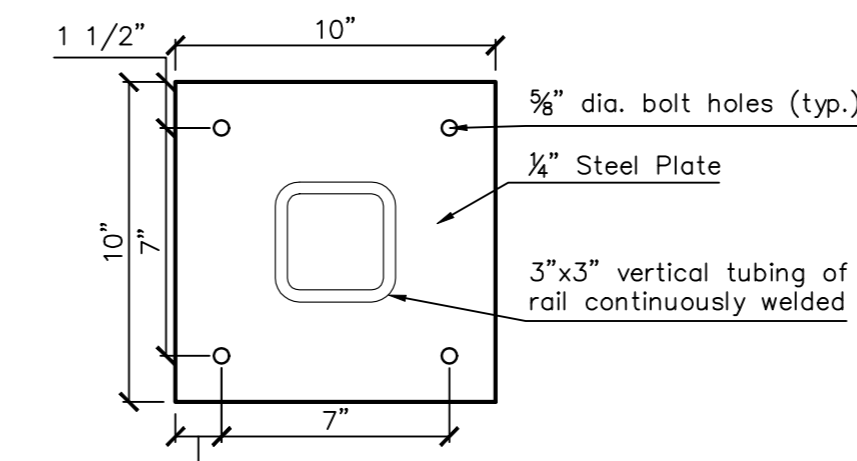

Mounting Plate

Scale 1"=0'-6"

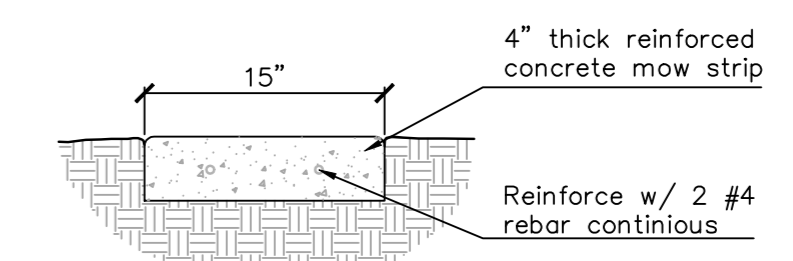

Mow Strip

Scale 1"=1'-0"

	STONEBRIDGE 2ND ADDITION RAILINGS	
	<small>Baughman Company, P.A. 315 Ella St. Wichita, KS 67211 P 316-262-7271 F 316-262-0149 ENGINEERING SURVEYING PLANNING LANDSCAPE ARCHITECTURE</small>	
PROJECT NUMBER 412-84591	DESIGN ATD/BKB	DRAWN BKB
REVISIONS:	APPROVED	DATE 01/08
SCALE Noted		SHEET 7 OF 27
<small>Stonebridge Bridge Railings</small>		<small>0607-E601</small>