

HORIZONTAL CONTROL POINTS		
C.P. NO. 1	N 19211.92 E 18134.47	NE Cor. of Prop. Pipe w/ Plastic Cap Found
C.P. NO. 2	N 19056.91 E 18134.65	SE Corner of Property Pipe Found

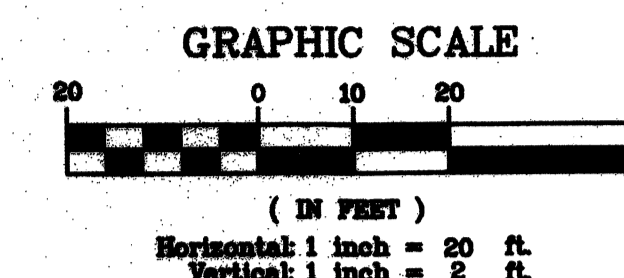

Benchmark:
R.R. Spike in N. Face of P.P.
120' S. of Ctr. Res. A on W.
side of Founders St. (Wawona).
Elev.=190.17(City Datum)

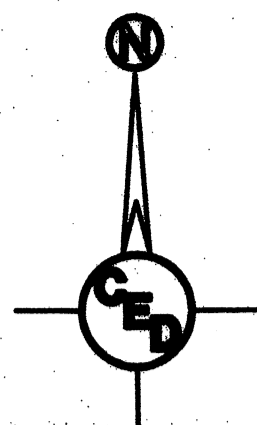
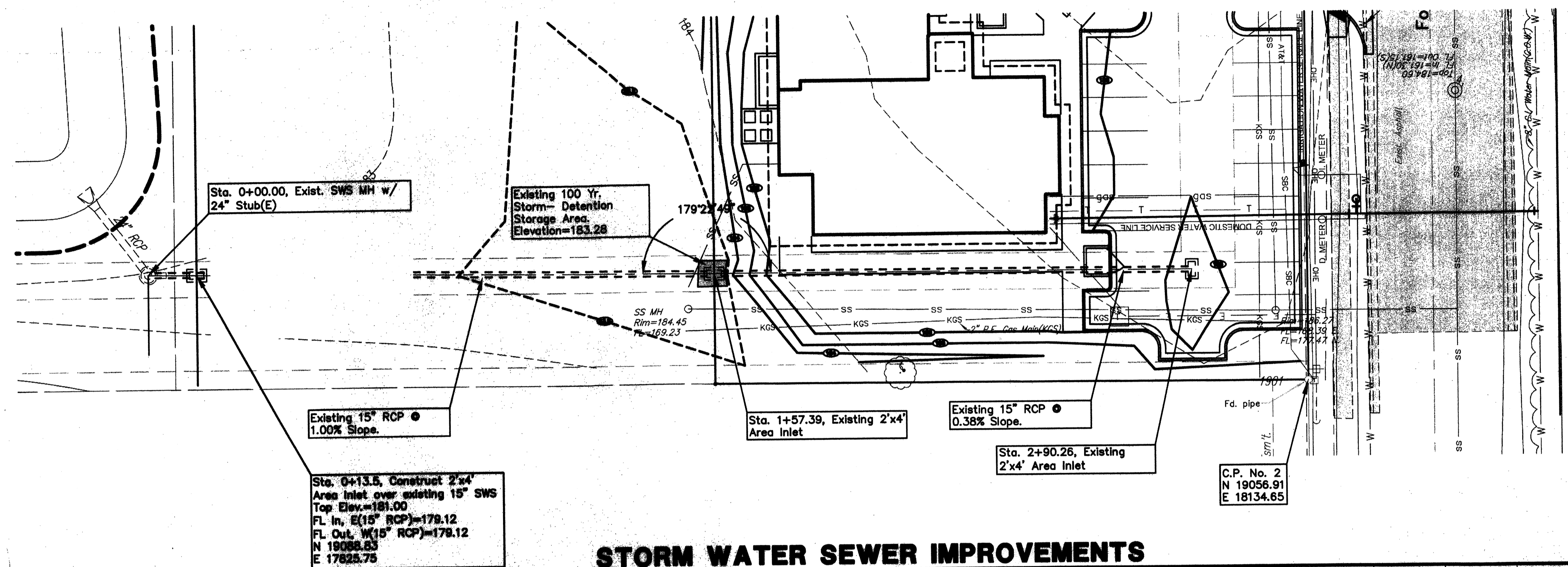

UTILITIES SHOWN REPRESENT THE BEST INFORMATION AVAILABLE FOR DESIGN. ADDITIONAL UTILITIES MAY BE PRESENT ON THIS PROJECT. THE CONTRACTOR SHALL BE RESPONSIBLE FOR DETERMINING THE EXACT LOCATION, DEPTH AND SIZE OF ALL UNDERGROUND UTILITIES PRIOR TO CONSTRUCTION. THE CONTRACTOR SHALL BE LIABLE FOR ANY DAMAGE CAUSED BY THE FAILURE TO DO SO.

STORM WATER SEWER IMPROVEMENTS

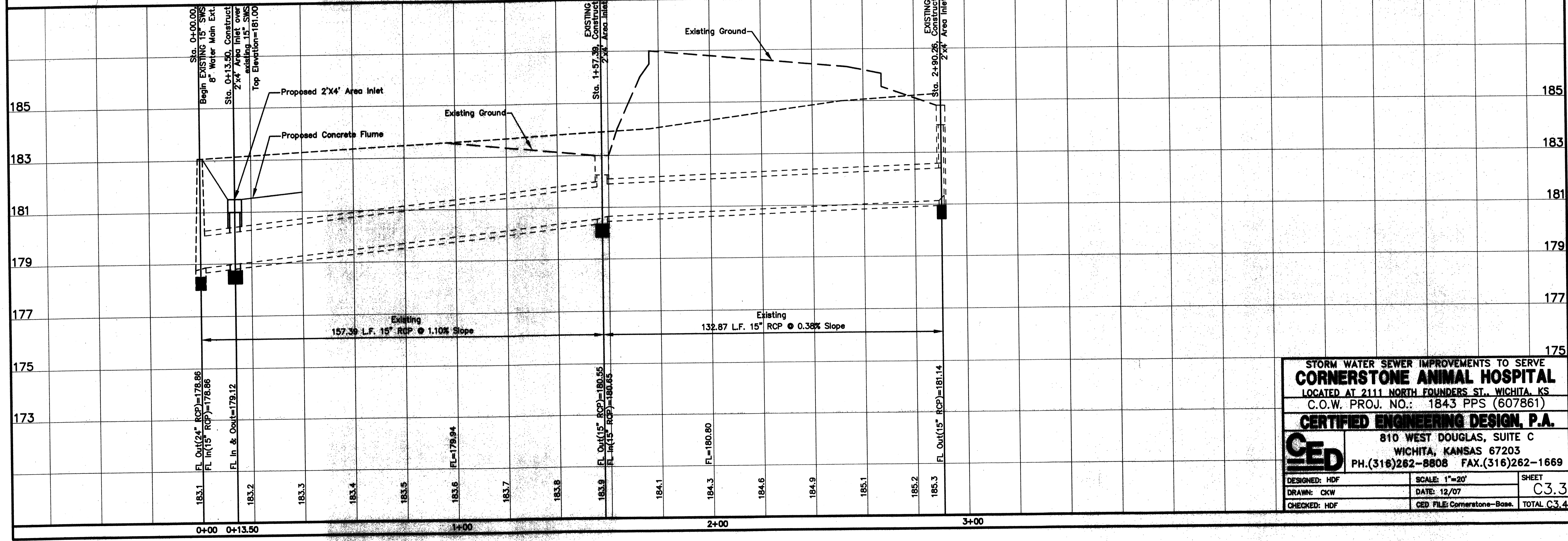

STORM WATER SEWER IMPROVEMENTS TO SERVE
CORNERSTONE ANIMAL HOSPITAL
 LOCATED AT 2111 NORTH FOUNDERS ST., WICHITA, KS
 C.O.W. PROJ. NO.: 1843 PPS (607861)
CERTIFIED ENGINEERING DESIGN, P.A.
 810 WEST DOUGLAS, SUITE C
 WICHITA, KANSAS 67203
 PH.(316)262-8808 FAX.(316)262-1669

DESIGNED: HDF	SCALE: 1"=20'	SHEET
DRAWN: CKW	DATE: 12/07	C3.3
CHECKED: HDF	CD FILE: Cornerstone-Boss	TOTAL C3.4

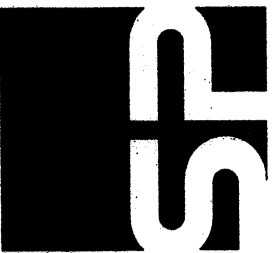

SPANGENBERG PHILLIPS
 ARCHITECTURE
 121 N. Mead, Suite 201, Wichita, KS 67202
 TEL: 316.267.4002 FAX: 316.267.1509
 www.spangenbergphillips.com

**STORM WATER INLET FOR
 CORNERSTONE ANIMAL HOSPITAL**

2111 NORTH FOUNDERS STREET, WICHITA, KANSAS

PERMIT SET
 11 DEC 07
 STORM WATER
 PLAN/PROFILE

C3.3