

LANDSCAPING NOTE:
 CONTRACTOR SHALL SHOW CARE IN REMOVING EXISTING LANDSCAPING MATERIAL. ALL MATERIAL REQUIRED FOR REMOVAL SHALL BE SALVAGED AND STOCKPILED, WHEN POSSIBLE, FOR THE OWNER. THIS INCLUDES BUT IS NOT LIMITED TO TIMBERS, POSTS, ROCKS, STONES, AND FENCING. ANY SUCH MATERIAL NOT WITHIN RIGHT-OF-WAY LIMITS AND DAMAGED SHALL BE REPLACED AT THE CONTRACTOR'S EXPENSE. (SAID WORK IS SUBSIDIARY TO "SITE CLEARING & RESTORATION".)

*DUE TO DIFFERENCE IN NEW DRIVE WAY ELEVATION AND EXISTING ELEVATION OF SHRUB OR TREE, CONTRACTOR SHALL REVIEW CONDITIONS AND SALVAGE IF POSSIBLE.

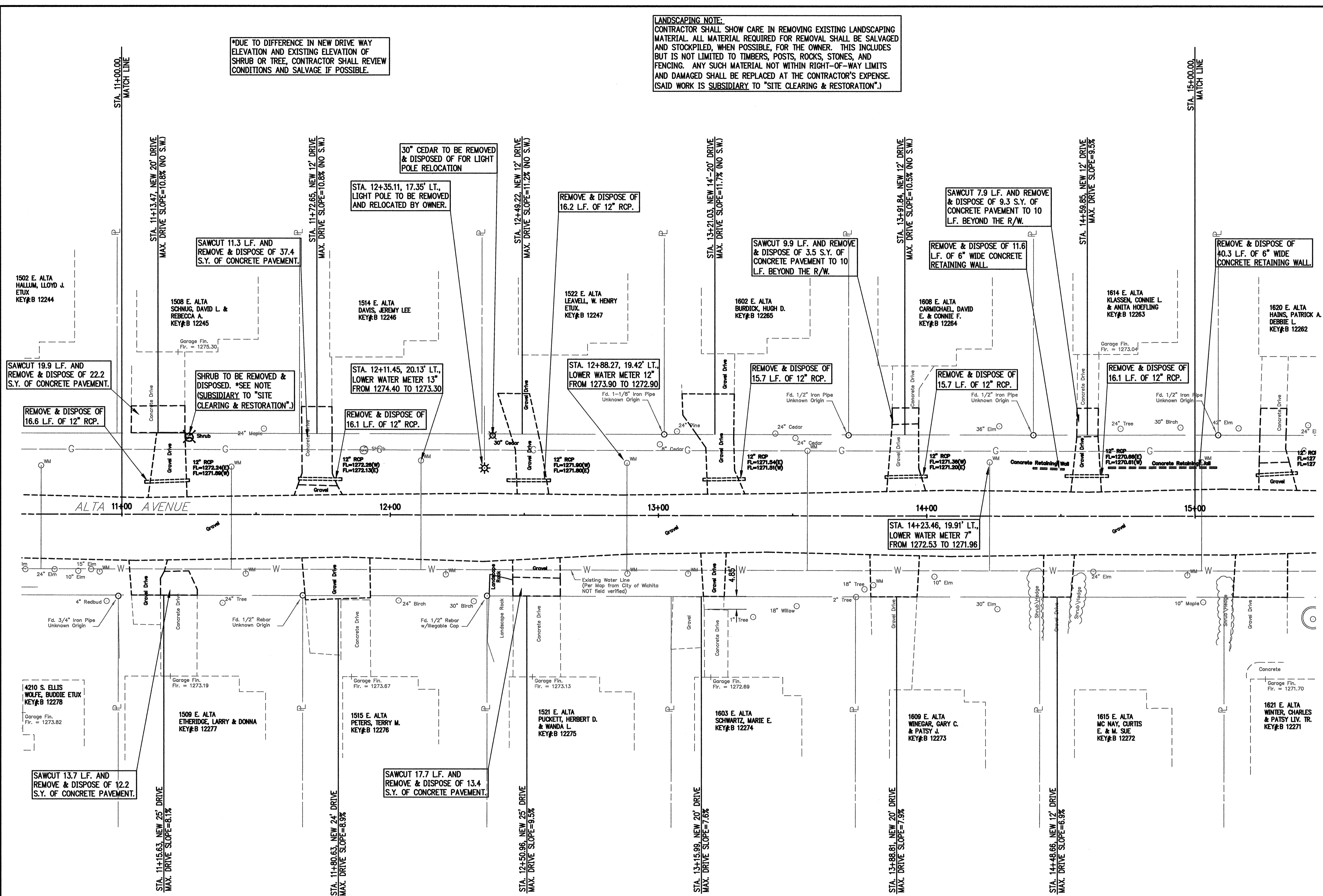
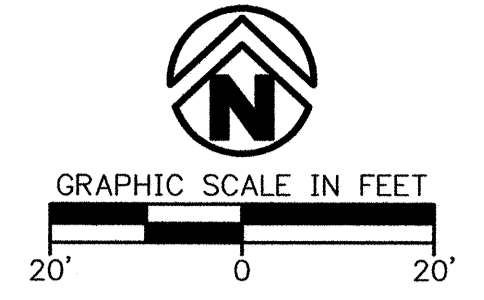

LEGEND

	FOUND IRON PIN
	SET IRON PIN
	EXISTING LIGHT POLE
	EXISTING POWER POLE
	EXISTING TELEPHONE PEDESTAL
	EXISTING WATER VALVE
	EXISTING FIRE HYDRANT
	EXISTING WATER METER
	EXISTING MANHOLE
	EXISTING GAS METER
	EXISTING CURB
	EXISTING INTERMEDIATE CONTOUR
	EXISTING INDEX CONTOUR
	PROPOSED CURB
	EXISTING SANITARY SEWER LINE (8")
	EXISTING GAS LINE
	EXISTING WATER LINE (SPECIFY SIZE & TYPE)
	EXISTING UNDERGROUND TELEPHONE
	EXISTING UNDERGROUND ELECTRIC
	EXISTING FIBER OPTIC
	EXISTING OVERHEAD ELECTRIC
	EXISTING UNDERGROUND TELEVISION
	EXISTING OVERHEAD TELEVISION
	EXISTING WOOD FENCE
	EXISTING BARBED WIRE FENCE
	EXISTING CHAIN LINK OR WIRE FENCE
	PROPERTY LINE
	BUILDING SET BACK
	EXISTING EASEMENT
	EXISTING RIGHT OF WAY
	GUY ANCHOR
	EXISTING REINFORCED CONCRETE PIPE OR CORRUGATED METAL PIPE
	EXISTING TREE
	TREE TO BE REMOVED

- DEMOLITION NOTES**
- CONTRACTOR SHALL ABIDE BY ALL FEDERAL, STATE, AND LOCAL CODES FOR THE DEMOLITION AND DISPOSAL OF ALL MATERIALS.
 - CRAFTON, TULL, SPARKS AND ASSOCIATES, INC. SHALL NOT BE LIABLE FOR ANY DEMOLITION PROCEDURES, SCHEDULING, AND DISPOSAL OF ANY MATERIALS.
 - IT SHALL BE THE RESPONSIBILITY OF THE CONTRACTOR TO MAKE SURE THAT ADJACENT PROPERTY IS NOT DAMAGED AND IS ACCESSIBLE AT ALL TIMES, AND THAT CONSTRUCTION DOES NOT CREATE ANY HARDSHIP TO LAND OWNERS ADJACENT TO THE CONSTRUCTION SITE.
 - THE CONTRACTOR IS RESPONSIBLE FOR THE DEMOLITION, REMOVAL, AND DISPOSING IN A LOCATION APPROVED BY ALL GOVERNING AUTHORITIES, OF ALL STRUCTURES, PADS, WALLS, FLUMES, FOUNDATIONS, PARKING, DRIVES, DRAINAGE, STRUCTURES, UTILITIES, ETC., SUCH THAT THE IMPROVEMENTS SHOWN ON THE REMAINING PLANS CAN BE CONSTRUCTED. ALL FACILITIES TO BE REMOVED SHALL BE UNDERCUT TO SUITABLE MATERIAL AND BROUGHT TO GRADE WITH SUITABLE COMPACTED FILL MATERIAL PER THE SPECIFICATIONS.
 - THE CONTRACTOR SHALL COORDINATE WITH RESPECTIVE UTILITY COMPANIES PRIOR TO THE DISCONNECTION, REMOVAL AND RELOCATION OF ALL UTILITIES. THE CONTRACTOR SHALL COORDINATE WITH THE UTILITY COMPANY CONCERNING PORTIONS OF WORK WHICH MAY BE PERFORMED BY THE UTILITY COMPANY'S FORCES AND ANY FEES WHICH

- ARE TO BE PAID TO THE UTILITY COMPANY FOR SERVICES. THE CONTRACTOR IS RESPONSIBLE FOR PAYING ALL FEES AND CHARGES. THE CONTRACTOR IS RESPONSIBLE FOR REMOVING EXISTING IRRIGATION SYSTEM IN THE AREAS OF PROPOSED IMPROVEMENTS, THE CONTRACTOR SHALL CAP THE EXISTING IRRIGATION SYSTEM TO REMAIN SUCH THAT THE REMAINING SYSTEM SHALL CONTINUE TO FUNCTION PROPERLY.
- THE LOCATIONS OF ALL EXISTING UTILITIES SHOWN ON THIS PLAN HAVE BEEN DETERMINED FROM THE BEST INFORMATION AVAILABLE AND ARE GIVEN FOR THE CONVENIENCE OF THE CONTRACTOR. THE ENGINEER ASSUMES NO RESPONSIBILITY FOR THEIR ACCURACY. PRIOR TO THE START OF ANY DEMOLITION ACTIVITY, THE CONTRACTOR SHALL NOTIFY THE UTILITY COMPANIES FOR ONSITE LOCATIONS OF EXISTING UTILITIES.
- ALL EXISTING SEWERS, PIPING AND UTILITIES SHOWN ARE NOT TO BE INTERPRETED AS THE EXACT LOCATION, OR AS THE ONLY OBSTACLES THAT MAY OCCUR ON THE SITE. VERIFY EXISTING CONDITIONS AND PROCEED WITH CAUTION AROUND ANY ANTICIPATED FEATURES. GIVE NOTICE TO ALL UTILITY COMPANIES REGARDING DESTRUCTION AND REMOVAL OF ALL SERVICE LINES AND CAP ALL LINES BEFORE PROCEEDING WITH WORK. UTILITIES DETERMINED TO BE ABANDONED AND LEFT IN PLACE SHALL BE GROUTED IF UNDER BUILDINGS.
- ELECTRICAL, TELEPHONE, CABLE, WATER, FIBER OPTIC CABLE AND/OR GAS LINES NEEDING TO BE REMOVED OR RELOCATED SHALL BE COORDINATED WITH THE AFFECTED UTILITY COMPANY. ADEQUATE TIME

- SHALL BE PROVIDED FOR RELOCATION AND CLOSE COORDINATION WITH THE UTILITY COMPANY IS NECESSARY TO PROVIDE A SMOOTH TRANSITION IN UTILITY SERVICE.
- CONTRACTOR MUST PROTECT THE PUBLIC AT ALL TIMES WITH FENCING, BARRICADES, ENCLOSURES, ETC.
- ALL EROSION CONTROL DEVICES ARE TO BE INSTALLED PRIOR TO DEMOLITION.
- CONTRACTOR MAY LIMIT SAW-CUT AND PAVEMENT REMOVAL TO ONLY THOSE AREAS WHERE IT IS REQUIRED AS SHOWN ON THESE CONSTRUCTION PLANS BUT IF ANY DAMAGE IS INCURRED ON ANY OF THE SURROUNDING PAVEMENT, ETC. THE CONTRACTOR SHALL BE RESPONSIBLE FOR ITS REMOVAL AND REPAIR.
- CONTRACTOR SHALL MAINTAIN ALL EXISTING PARKING, SIDEWALKS, DRIVES, ETC. CLEAR AND FREE FROM ANY CONSTRUCTION ACTIVITY AND/OR MATERIAL TO ENSURE EASY AND SAFE PEDESTRIAN AND VEHICULAR TRAFFIC TO AND FROM THE SITE.
- THE CONTRACTOR SHALL COORDINATE WATERMAIN WORK WITH THE FIRE DEPARTMENT AND THE CITY/COUNTY UTILITY DEPARTMENT TO PLAN PROPOSED IMPROVEMENTS AND TO ENSURE ADEQUATE FIRE PROTECTION IS CONSTANTLY AVAILABLE TO THE SITE THROUGHOUT THIS SPECIFIC WORK AND THROUGH ALL PHASES OF CONSTRUCTION. CONTRACTOR WILL BE RESPONSIBLE FOR ARRANGING/PROVIDING ANY REQUIRED WATERMAIN SHUT-OFFS WITH THE CITY/COUNTY DURING CONSTRUCTION. ANY COSTS ASSOCIATED WITH WATERMAIN SHUT-OFFS WILL BE THE

- RESPONSIBILITY OF THE CONTRACTOR AND NO EXTRA COMPENSATION WILL BE PROVIDED.
- DAMAGE TO ALL EXISTING CONDITIONS TO REMAIN WILL BE REPLACED AT CONTRACTOR'S EXPENSE. REPAIRS SHALL RESTORE DAMAGED ITEMS TO EQUAL OR BETTER THAN, EXISTING CONDITIONS. CONTRACTOR IS RESPONSIBLE FOR DOCUMENTING ALL EXISTING DAMAGE AND NOTIFYING CONSTRUCTION MANAGER PRIOR TO CONSTRUCTION START.
- ALL TRENCHES AND/OR EXCAVATED AREAS SHALL BE FILLED/TESTED IN ACCORDANCE WITH CITY OF WICHITA STANDARD SPECIFICATIONS.
- IF SEPTIC TANKS ARE FOUND PRESENT WITHIN THE LIMITS OF DISTURBANCE THEY SHALL BE DISPOSED OF IN ACCORDANCE WITH LOCAL, STATE, AND FEDERAL LAWS.
- IF THE CONTRACTOR FINDS ANY UNDERGROUND TANKS ON SITE THEY SHALL CONTACT THE ENGINEER IMMEDIATELY.
- ALL WELLS SHALL BE CAPPED AND CLOSED IN ACCORDANCE WITH APPLICABLE STATE AND FEDERAL LAW.

DRAWING FILE NAME AND LOCATION: G:\073009-01\ENGIN\DWG\demolition.dwg
 LAST SAVED BY: CW3002, 11/26/2007 3:34:50 PM
 PLOTTED BY: CHRIS WINKLER (ONLY VALID ON HARD COPY)
 © 2007 Crafton, Tull, Sparks & Associates, Inc.

LAYOUT TAB: DEMO (2)

Crafton Tull Sparks
 8200 E. 34th Street North, Bldg. 1.600
 Suite 1.603, Wichita, KS 67226
 316.634.6776 FAX: 316.634.6777
 www.craftontullsparks.com

architecture | engineering

ALTA STREET DESIGN, 350' WEST
 OF ELLIS TO HYDRAULIC
 WICHITA, KANSAS
 C.O.W. PROJ. NO.: 472 84437

ISSUED FOR CONSTRUCTION

Revision

Drawn by	Job Number
CKW	073009-00
Checked by	Contact Person
	J. MOHLER
Date	Sheet Number
1/02/08	C0.04