

DRAWING FILE NAME AND LOCATION: G:\073009-00\ENGIN\DWG\street-plans.dwg
 LAST SAVED BY: CW3002 - 11/26/2007 2:54:44 PM
 PLOTTED BY: CHRIS WINKLER (ONLY VALID ON HARD COPY)
 © 2007 Craffon Tull Sparks & Associates, Inc.

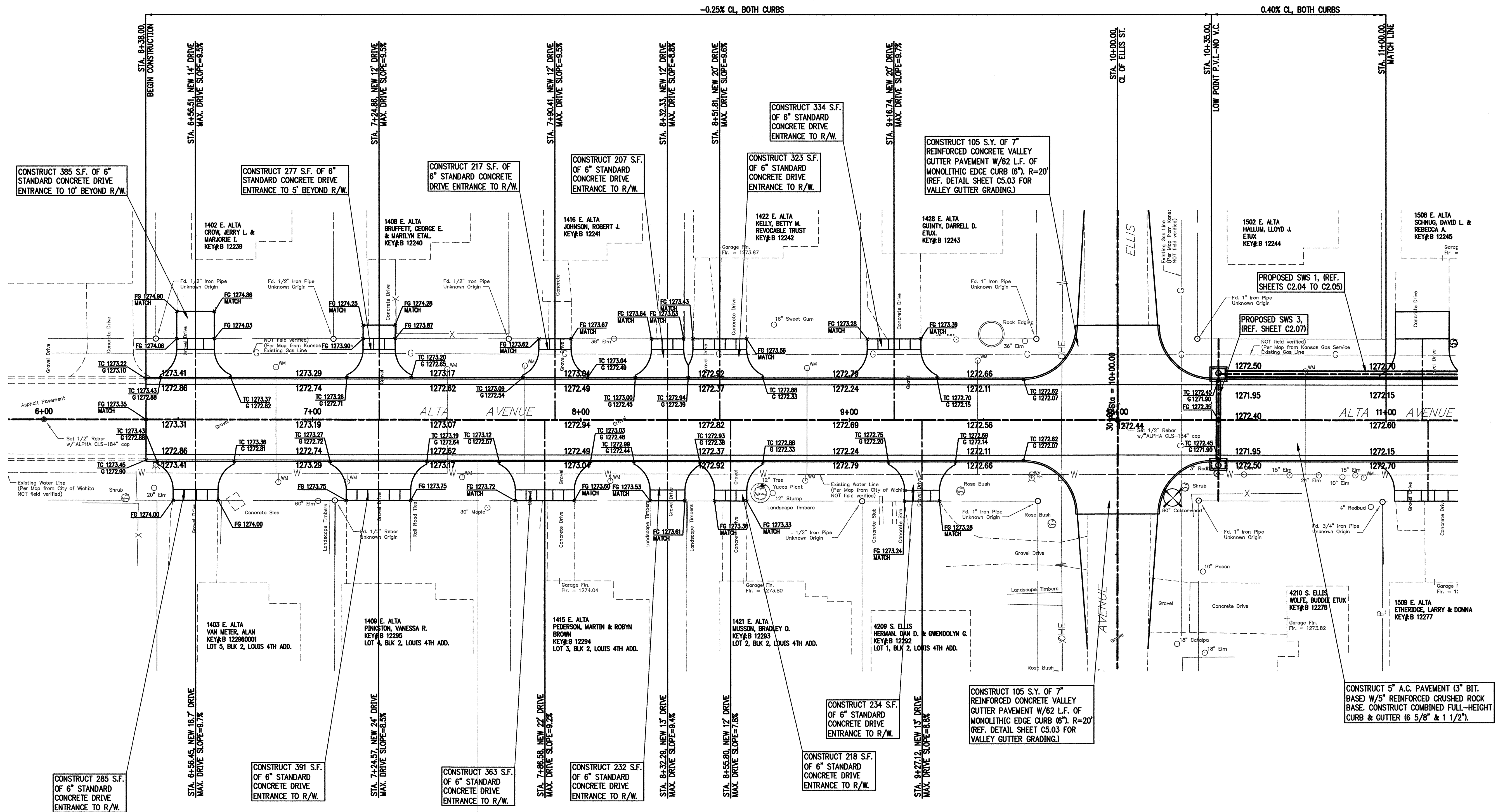

LEGEND			
	FOUND IRON PIN		EXISTING INTERMEDIATE CONTOUR
	SET IRON PIN		EXISTING INDEX CONTOUR
	EXISTING LIGHT POLE		PROPOSED CURB
	EXISTING POWER POLE		EXISTING SANITARY SEWER LINE (8")
	EXISTING TELEPHONE PEDESTAL		EXISTING GAS LINE
	EXISTING WATER VALVE		EXISTING WATER LINE (SPECIFY SIZE & TYPE)
	EXISTING FIRE HYDRANT		EXISTING UNDERGROUND TELEPHONE
	EXISTING WATER METER		EXISTING UNDERGROUND ELECTRIC
	EXISTING MANHOLE		EXISTING FIBER OPTIC
	PROPOSED MANHOLE		EXISTING OVERHEAD ELECTRIC
	EXISTING GAS METER		EXISTING UNDERGROUND TELEVISION
	EXISTING CURB		EXISTING OVERHEAD TELEVISION
			EXISTING WOOD FENCE
			EXISTING BARBED WIRE FENCE
			EXISTING CHAIN LINK OR WIRE FENCE
			PROPERTY LINE
			BUILDING SET BACK
			EXISTING EASEMENT
			EXISTING RIGHT OF WAY
			GUY ANCHOR
			EXISTING REINFORCED CONCRETE PIPE OR CORRUGATED METAL PIPE
			EXISTING TREE
			TREE TO BE REMOVED



KS: 1-800-344-7233
WICHITA: 316-687-2470

Craffon Tull Sparks
 8200 E. 34th Street North, Bldg. 1600
 Suite 1403, Wichita, KS 67226
 316.634.6776 FAX: 316.634.6777
 www.craffontullsparks.com

architecture | engineering

ALTA STREET DESIGN, 350' WEST OF ELLIS TO HYDRAULIC WICHITA, KANSAS
 C.O.W. PROJ. NO.: 472 84437

ISSUED FOR CONSTRUCTION

Revision

Drawn by CKW	Job Number 073009-00
Checked by	Contact Person J. MOHLER
Date 1/02/08	Sheet Number C1.03

STREET PLAN 1