

BENCHMARK:
 BM # 1 - City of Wichita Disc in the Northwest Corner of 37th Street North and Womer Elev. = 1324.06 MSL
 BM # 2 - "C" Cut on the Top of Curb in the NE Corner of the Parking Lot for The Word of Life Church at 37th Street North & Meridian. Elev. = 1323.11 MSL
 BM # 3 - RR Spike in the East Face of Light Pole at the Southwest Corner of 34th Street North & Meridian. Elev. = 1320.32 MSL

Scale: 1" = 20'
 • = Iron

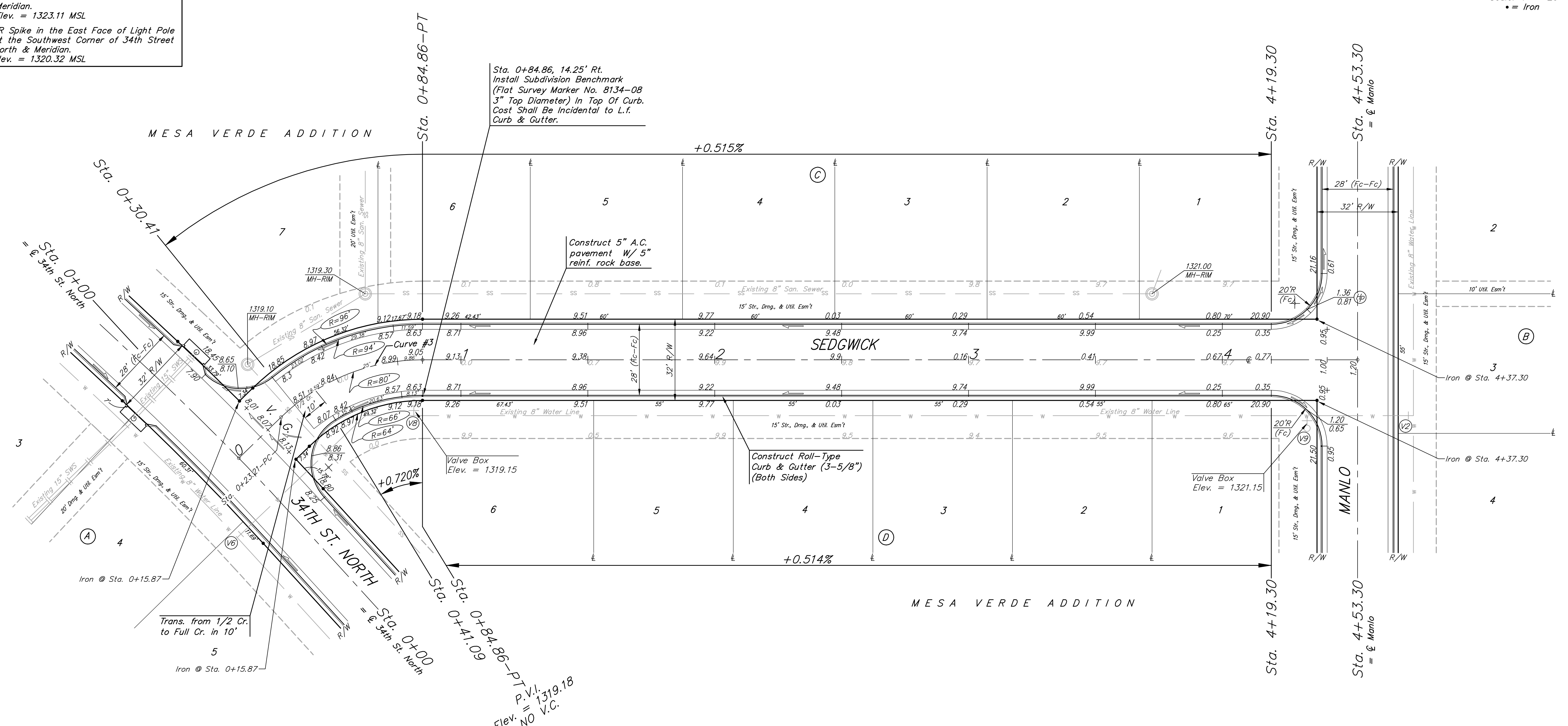

P.V.I. = 1319.18
 Elev. NO V.C.

Subdivision Bench Marks

Street & Station	Location Description	Elevation
Manlo 2+40.00, 14.25' Lt.	Adjacent to Fire Hydrant at N. End of E. Curb Return of Manlo & Sedgwick	
Sedgwick 0+84.86, 14.25' Rt.	Adjacent to Fire Hydrant at W. Line of Lot 6, Block D at P.T.	

Water Valve Location Table

Valve Number	Street	Station
V1	Manlo	0+18.00, 22' Rt.
V2	Manlo	2+28.00, 20' Rt.
V3	Manlo	2+90.00, 20' Rt.
V4	Manlo	3+20.00, 20' Rt.
V5	34th St. North	0+18.00, 22' Rt.
V6	34th St. North	3+89.56, 20' Rt.
V7	34th St. North	4+19.56, 20' Rt.
V8	Sedgwick	8+80.30, 19.90' Rt.
V9	Sedgwick	4+33.42, 24' Rt.

Paving Contractor shall be responsible to operate all water valves on the project, in the presence of the Inspector, to ensure accessibility to the valves, and that all valves are left in the "ON" position when the project is completed.

Curve #3
 Curve Data Based on Centerline
 Rad. = 80', Delta = 44°09'18" Tangent = 32.45'
 Arc = 61.65' L.C. = 60.14' Def/Ft. = 21.48662 Min.

Station	Arc	FACE CHORD LENGTHS		Defl.	T. Defl.
		8' Lt.	8' Rt.		
0+23.21	-	-	-	0'00'00"	0'00'00"
0+25.00	1.79'	2.28'	1.30'	0'38'28"	0'38'28"
0+50.00	25.00'	31.75'	18.05'	8'57'10"	9'35'38"
0+75.00	25.00'	31.75'	18.05'	8'57'10"	18'32'48"
0+84.86	9.86'	12.56'	7.14'	3'31'51"	22'04'39"

Roll Type Curb & Gutter To Be Constructed On The Pavement On This Sheet. Top Of Curb Elevation Are Given For Full Height Curb.

B Baughman	Mesa Verde Addition - Phase I	
	SEDGWICK STA. 0+00 TO STA. 4+53.30	
Baughman Company, P.A. 315 Ellis St. Wichita, KS 67211 F 3163627771 F 3163620149 ENGINEERING SURVEYING PLANNING LANDSCAPE ARCHITECTURE		
PROJECT NUMBER 47284481	DESIGN JAK	DRAWN JAK
REVISIONS:	APPROVED	DATE 2/20/08
	SCALE Noted	SHEET 7 OF 18
Mesa Verde\Phase1\Str3		07-11-E995