

**STORM WATER SEWER  
COUNTRY HOLLOW ADDITION  
PHASE 2**

**9'X3' RCB**  
SHEET TITLE  
468-84114  
PROJECT NUMBER

DESIGN BY DFL  
DRAWN BY SMS  
CHECKED BY GJA

ISSUED February 2008  
REVISED

SHEET NO.  
**9 of 20**

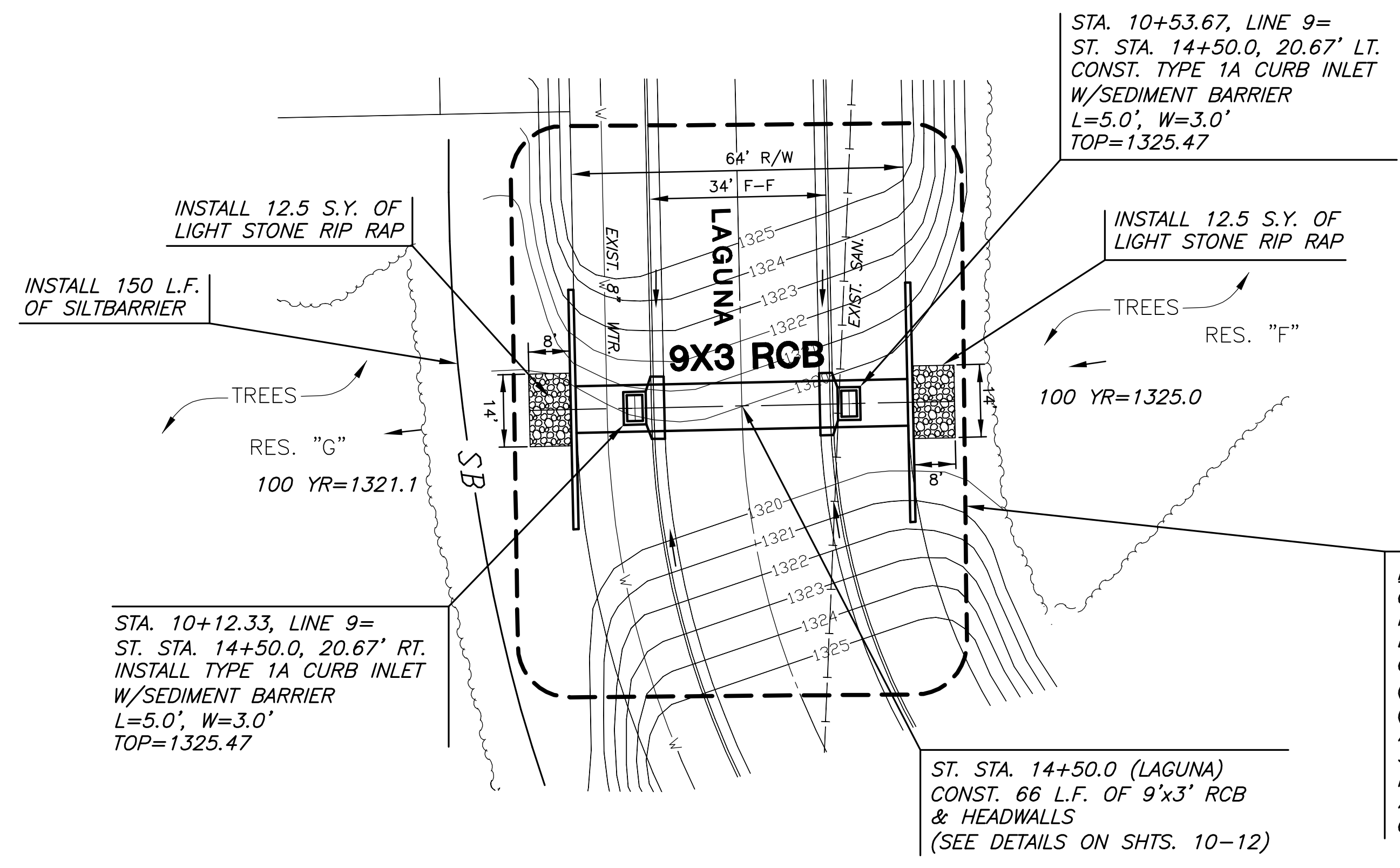

**RCB GRADING CONSTRUCTION LIMITS**  
CONTRACTOR TO FILL 1' ABOVE 9'X3' RCB AND TIE INTO EXISTING 1325 ELEVATION EACH SIDE OF THE BOX FROM RIGHT-OF-WAY TO RIGHT-OF-WAY. COMPACT IN 6" LIFT TO 95% STD DENSITY. (APPROX. 500 CY COST SUBSIDIARY TO PROJECT) (SEQUENCE FOR PLACING FILL: AFTER PRECAST SECTIONS ARE PLACED CONTRACTOR SHALL PLACE FILL OVER BOX TO PROVIDE ACCESS FOR GRADING/PAVING CONTRACTORS EQUIPMENT. AFTER CAST-IN-PLACE PORTIONS OF THE RCB HAVE CURED CONTRACTOR SHALL FINISH PLACING FILL.)

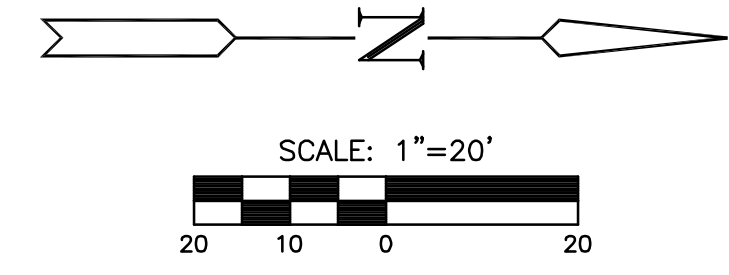

**PLAN RCB**  
SCALE: 1"=20'

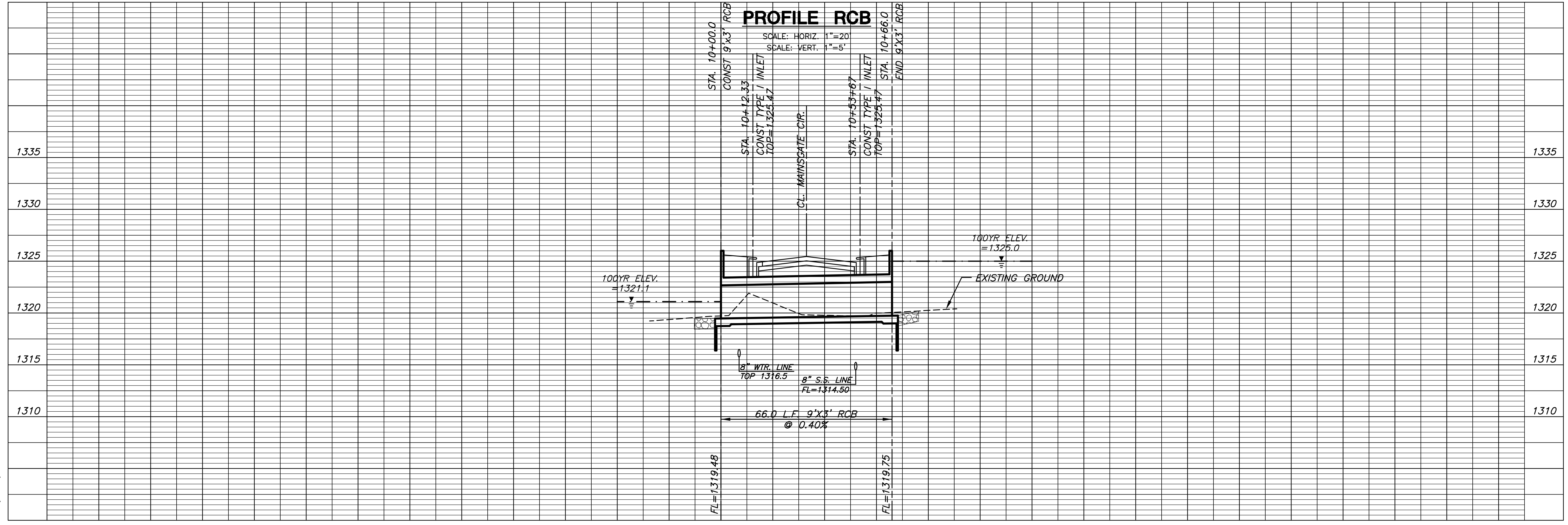

**PROFILE RCB**  
SCALE: HORIZ. 1"=20'  
SCALE: VERT. 1"=5'