

SCALE:  
1" = 20' HORIZONTAL  
1" = 5' VERTICAL

**BENCHMARK**

□ Cut on Crosswalk Signal Pole Base  
6.4' N and 25.3' E of the Ne Corner  
SE ¼, NW ¼ Section 29-26S-1E  
Elev. = 1323.41

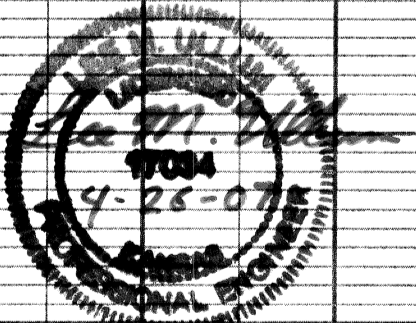
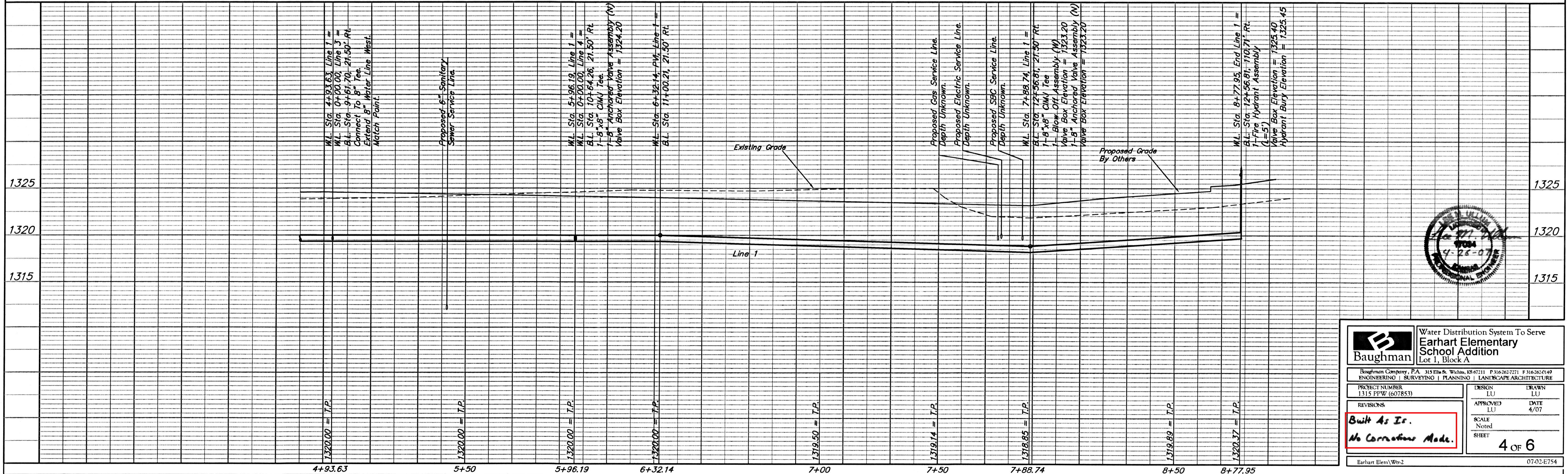

		Water Distribution System To Serve <b>Earhart Elementary School Addition</b> Lot 1, Block A	
Baughman Company, P.A. 315 Elm St. Wilkes, KS 67111 P 316-262-7271 F 316-262-0149 ENGINEERING   SURVEYING   PLANNING   LANDSCAPE ARCHITECTURE			
PROJECT NUMBER 1315 PPW (607853)	DESIGN LU	DRAWN LU	DATE 4/07
REVISIONS	APPROVED LU	SCALE Noted	SHEET 4 OF 6
<b>Built As It.</b> <b>No Corrections Made.</b>			
Earhart Elem Wtr-2		07.02-E754	