



KS: 1-800-344-7233
WICHITA: 316-687-2470

STA. 1+52.23, EXISTING 24" SANITARY SEWER LINE. APPROXIMATE DEPTH=17' APPROXIMATE CLEARANCE=7.5'

INSTALL 218.99 L.F. OF 60"x38" RCPHE @ 0.20% SLOPE.

STA. 0+00.00, SWS 1, CONNECT TO EXISTING INLET. SEAL NEW PIPE TO INLET WALL WITH QUICK-SET HYDRAULIC CEMENT. INVERT ELEV.=1301.50 PROPOSED FL ELEV.=1301.60

STA. 2+22.49, SWS 1, CONSTRUCT NEW 8'X8'X6.5' INLET/MH SPECIAL. (REF. DETAIL SHEET C5.02) GRATE ELEV.=1308.00 42" RCP FL IN(N)=1302.24 50"x38" RCPHE FL OUT(W)=1302.04 (GRADING FOR SUMP CONDITION IS SUBSIDIARY TO 'OTHER' ITEMS IN THE CONTRACT.)

CONTRACTOR SHALL INSTALL 225 S.Y. OF PERMANENT TURF REINFORCEMENT MAT (TRM) (LANDLOK 300 OR PRE-APPROVED EQUAL) TO MANUFACTURERS RECOMMENDATIONS. INSTALL FROM EDGE OF INLET UP TO ELEVATION 1313.00.

CONTRACTOR SHALL INSTALL LIMESTONE DRAINAGE DROP STRUCTURE PER DETAILS, THIS SHEET. (ALL ITEMS INCLUDING BUT NOT LIMITED TO THE LIMESTONE BLOCKS, FILTER STONE & GRADING IS SUBSIDIARY TO THE LUMP SUM BID ITEM FOR "LIMESTONE DRAINAGE DROP STRUCTURE.") (SEE SECTION A-A DETAIL & LIMESTONE DRAINAGE DROP STRUCTURE DETAIL, THIS SHEET.)

STA. 1+96.84, EXISTING UNDERGROUND ELECTRIC LINE. APPROXIMATE DEPTH=48" APPROXIMATE CLEARANCE=20" COORDINATE W/ WESTAR REP. SHANE PRICE PRIOR TO BEGINNING EXCAVATION. OFFICE: (316)261-6315 CELL: (316)706-6702

INSTALL 219.17 L.F. OF 42" RCP @ 0.20% SLOPE.

STA. 4+48.17, SWS 1, MATCH LINE CONSTRUCT NEW 7'-6" X 7'-6" REINFORCED CONCRETE MH. (REF. DETAIL SHEET C5.01) EXISTING GROUND ELEV.=1317.82 RIM ELEV.=1318.25 42" RCP FL IN(N)=1311.20 42" RCP FL OUT(SW)=1302.68

STA. 3+59.36, CAUTION!!! EXISTING 18" SANITARY SEWER LINE. APPROXIMATE DEPTH=6.1' APPROXIMATE CLEARANCE=18"

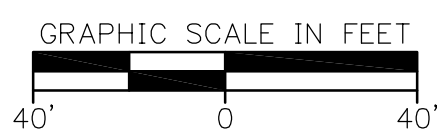

- LEGEND**
- G = GAS MAIN
 - W = WATER MAIN
 - SS = SANITARY SEWER
 - SWS = STORM WATER SEWER
 - UGE = UNDER GROUND ELECTRIC
 - UGT = UNDER GROUND TELEPHONE
 - B.M. = BENCH MARK
 - C.O. = CLEAN OUT
 - F.H. = FIRE HYDRANT
 - FO MKR = FIBER OPTIC MARKER
 - L.P. = LIGHT POLE
 - M.W. = MONITOR WELL
 - P.P. = POWER POLE
 - SIGN = SIGN
 - W.V. = WATER VALVE
 - XFMR = ELECTRIC TRANSFORMER
 - SS M.H. = SANITARY SEWER MANHOLE

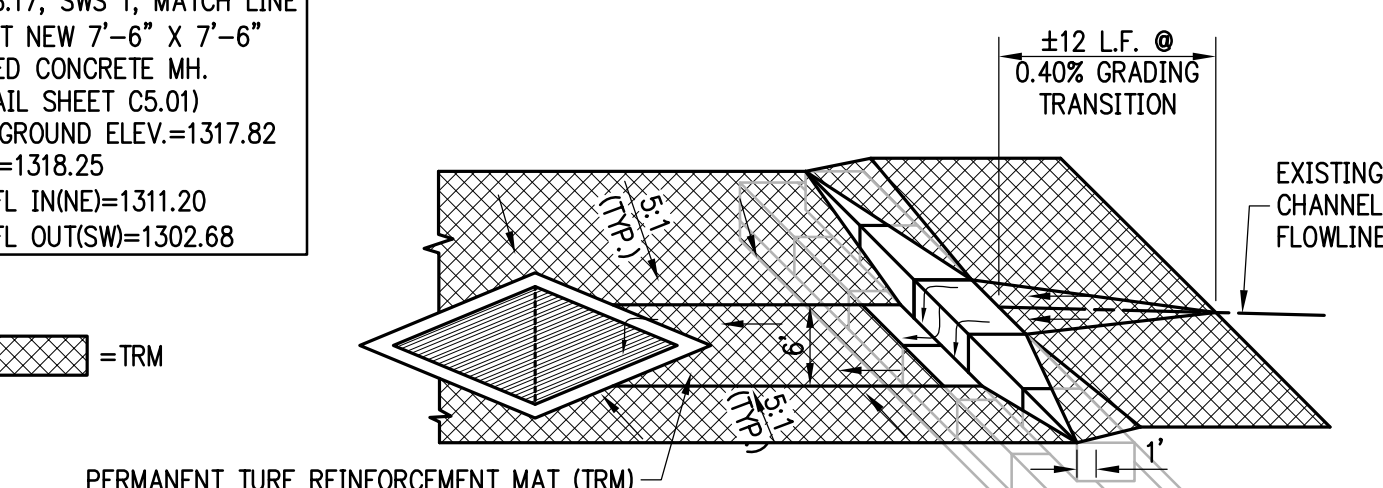

PERMANENT TURF REINFORCEMENT MAT (TRM) (LANDLOK 300 OR PRE-APPROVED EQUAL)

LIMESTONE BLOCK (SIZE TOLERANCE= ±3") CONTRACTOR SHALL BE RESPONSIBLE FOR CONSTRUCTING DROP STRUCTURE IN ACCORDANCE WITH THE DETAIL SHOWN REGARDLESS IF THE SIZE USED IS THE EXACT SIZE OR WITHIN THE NOTED TOLERANCE.

12" LAYER OF TYPE I FILTER COURSE PER KDOT SPEC. "1114-2.C. STONE FOR FILTER COURSE."

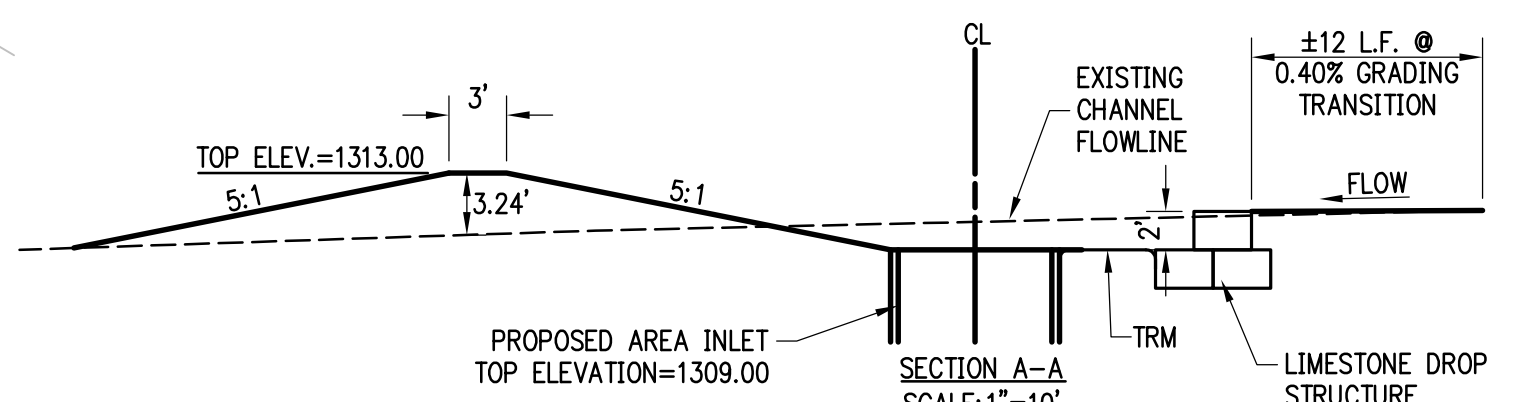

SWS NO. 1

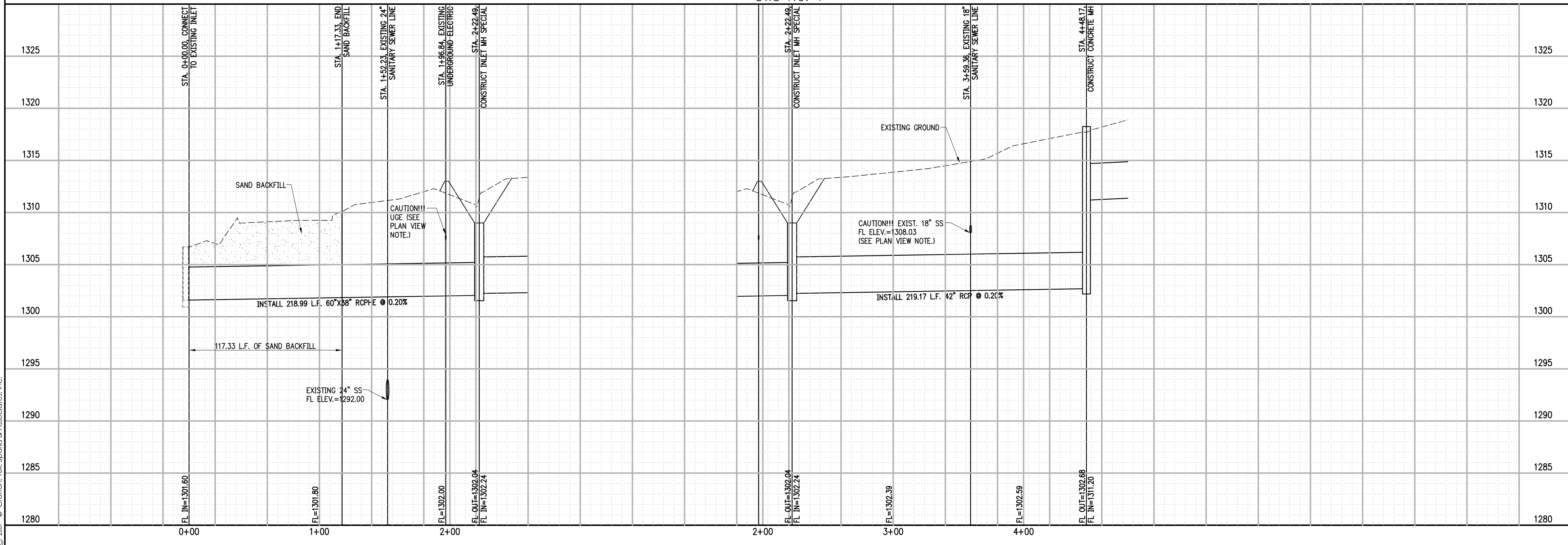

DRAWING FILE NAME AND LOCATION: C:\073010\00\ENGL\DWG\SWS 1 P&P.dwg
 LAST SAVED BY: CKW 2/13/2008 9:15:40 AM
 PLOTTED BY: CHRIS WINKLER (ONLY VALID ON HARD COPY)
 © 2007 Craffton Tull Sparks & Associates, Inc.

Craffton Tull Sparks
 8200 E. 34th Street North, Bldg. 1600
 Suite 1603, Wichita, KS 67226
 316.634.6776 FAX: 316.634.6777
 www.crafftontullsparks.com

architecture | engineering

CESSNA PARK WEST
 STORM WATER SEWER
 IMPROVEMENTS
 WICHITA, KANSAS

ISSUED FOR CONSTRUCTION

Revisions

Drawn by CKW	Job Number 073010-00
Checked by	Contact Person J. MOHLER
Date 2/08/08	Sheet Number C2.01