

**STORM WATER SEWER PLANS FOR
WATERFRONT RESIDENTIAL
ADDITION**

GRADING PLAN
SHEET TITLE
468-84423
PROJECT NUMBER

MLP
DESIGN BY
MLP
DRAWN BY
GJA
CHECKED BY

ISSUED
February 2008
REVISED

SHEET NO.
24 of 34

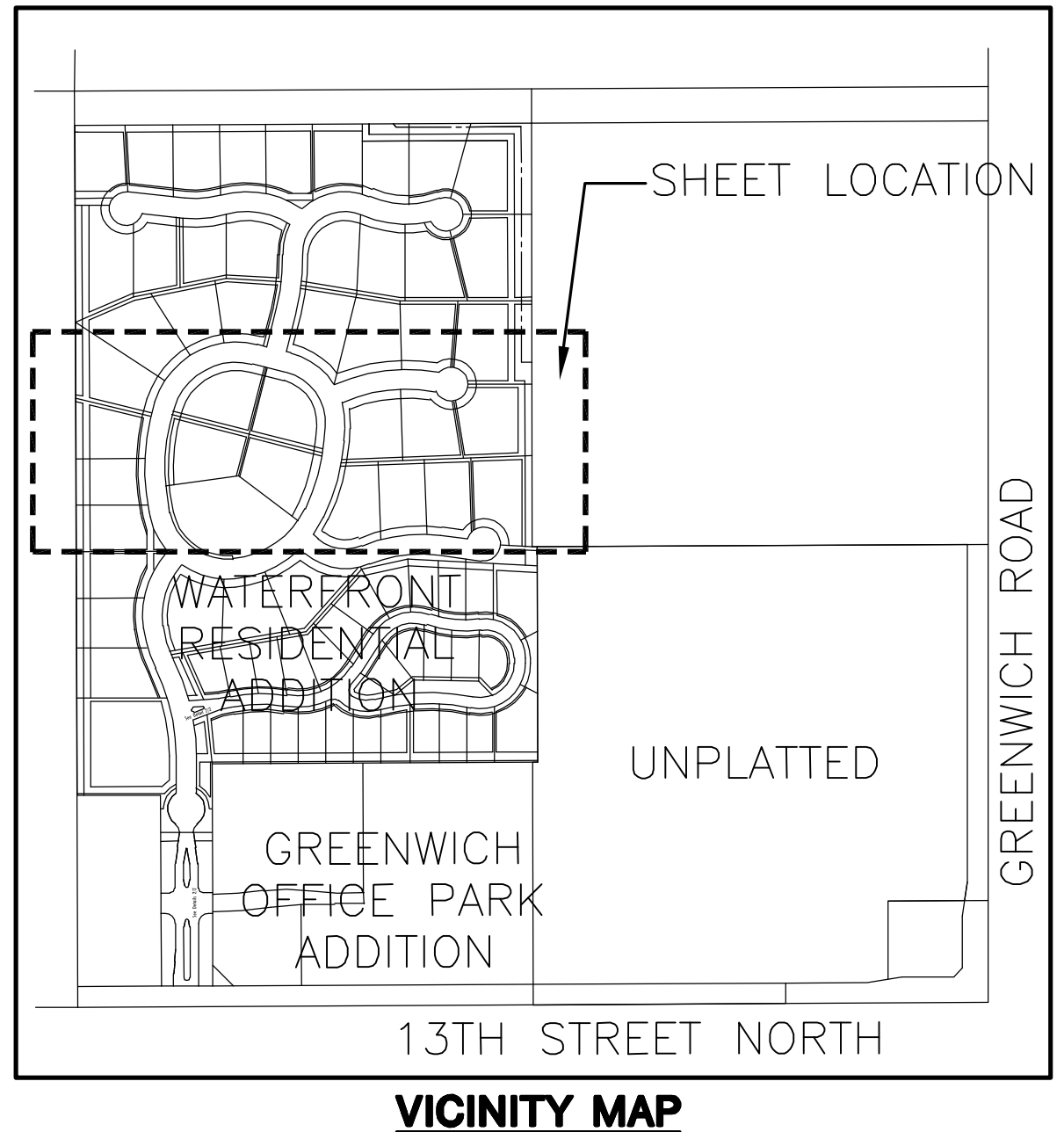
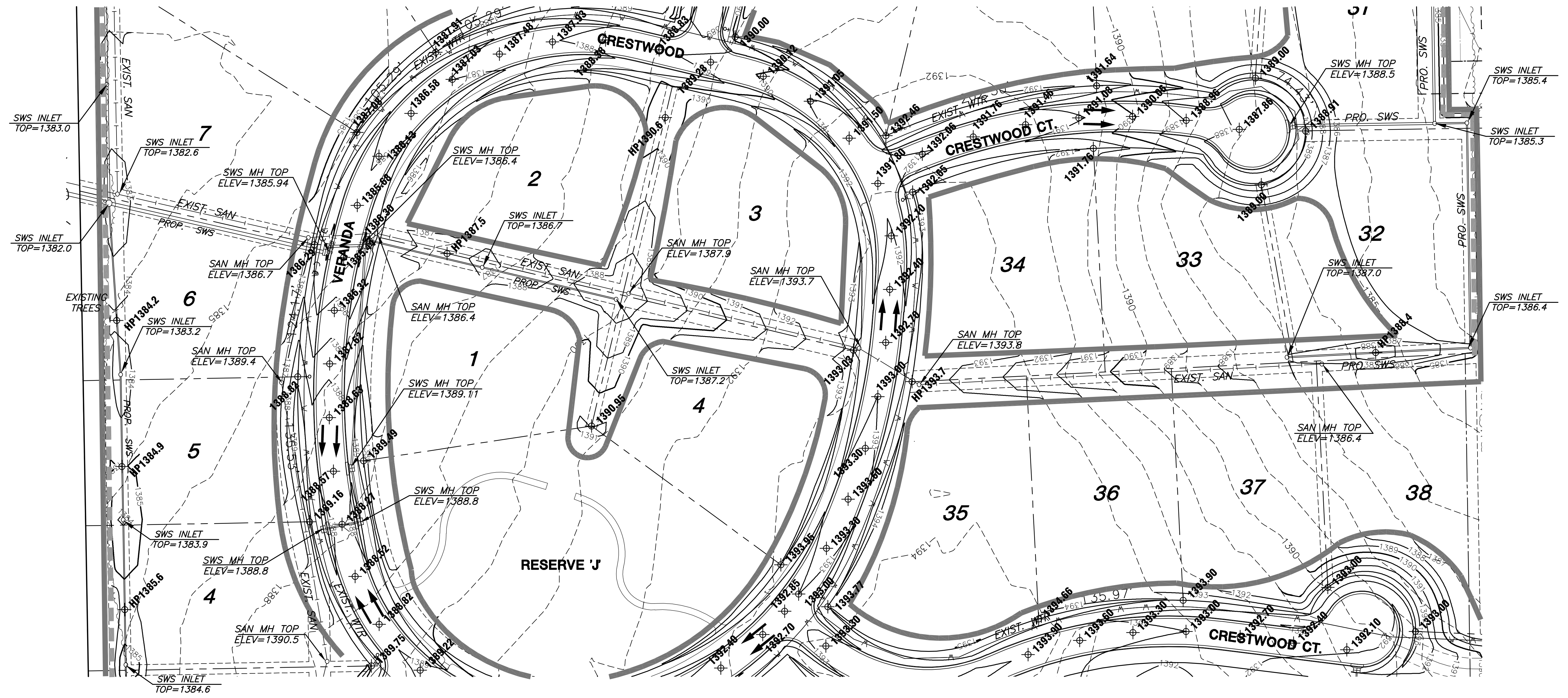

EXCAVATION AREA NOTES:
REMOVE TOPSOIL FROM EXCAVATION AREA AND STOCKPILE UNTIL EXCAVATION IS COMPLETE THEN REPLACE OVER DISTURBED AREA. COST SUBSIDIARY TO EARTHWORK.
CONTRACTOR TO INSURE POSITIVE DRAINAGE OUT OF EXCAVATION AREA.

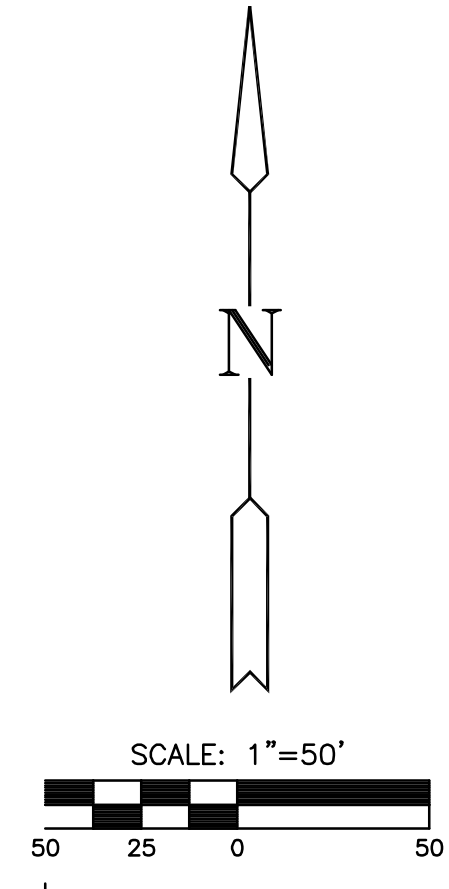

- LEGEND**
- PROPOSED TREE PROTECTION
 - ===== PROPOSED STORM WATER SEWER
 - EXISTING WATER LINE
 - EXISTING SANITARY SEWER LINE
 - - - - - 1359 - - - - - EXISTING CONTOURS
 - 1360 - - - - - PROPOSED CONTOURS
 - ===== LIMITS OF GRADING
 - █----- NORMAL POOL
 - DRAINAGE ARROWS
 - ▨----- TREE REMOVAL

PLOTTED: Wednesday, February 20, 2008 @ 09:15AM

J:\CIVIL\06266\DWG\GRAD\RESIDENTIAL\06266_02.DWG