

BENCHMARKS:
 City of Wichita Disc, 13 feet south
 and 85 feet east of Kellogg and
 119th Street West

Elevation = 1333.36 (MSL)

SCALE:
 1" = 20' HORIZONTAL
 1" = 5' VERTICAL
 • = IRON

SCALE:
 1" = 20' HORIZONTAL
 1" = 5' VERTICAL
 • = IRON

SCALE:
 1" = 20' HORIZONTAL
 1" = 5' VERTICAL
 • = IRON

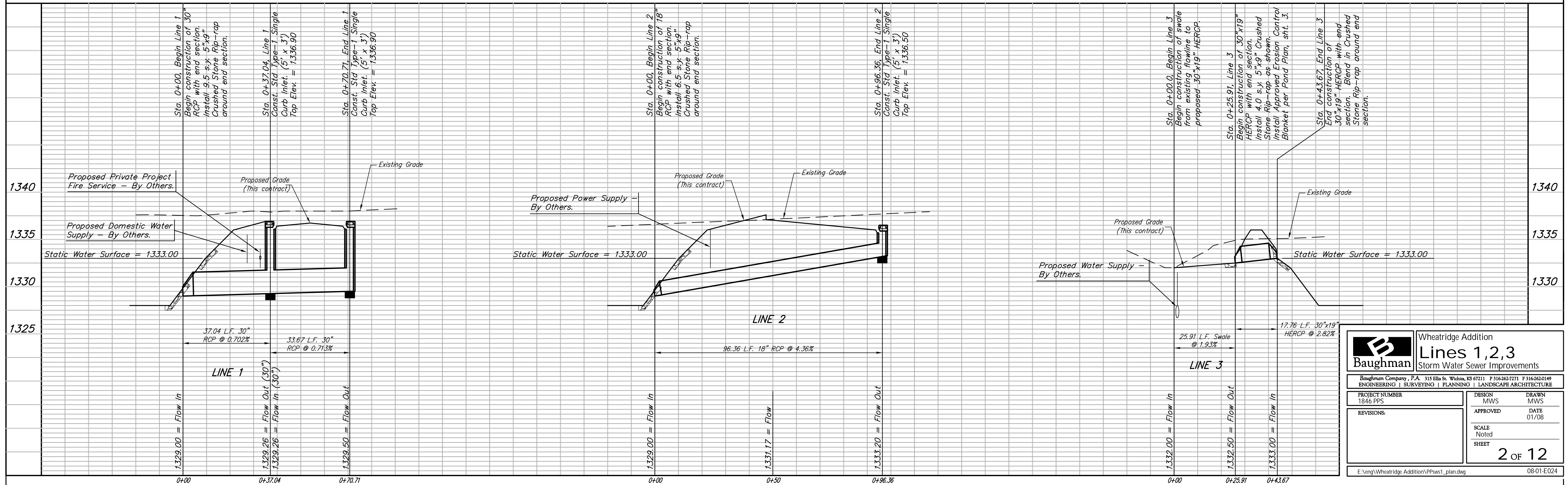
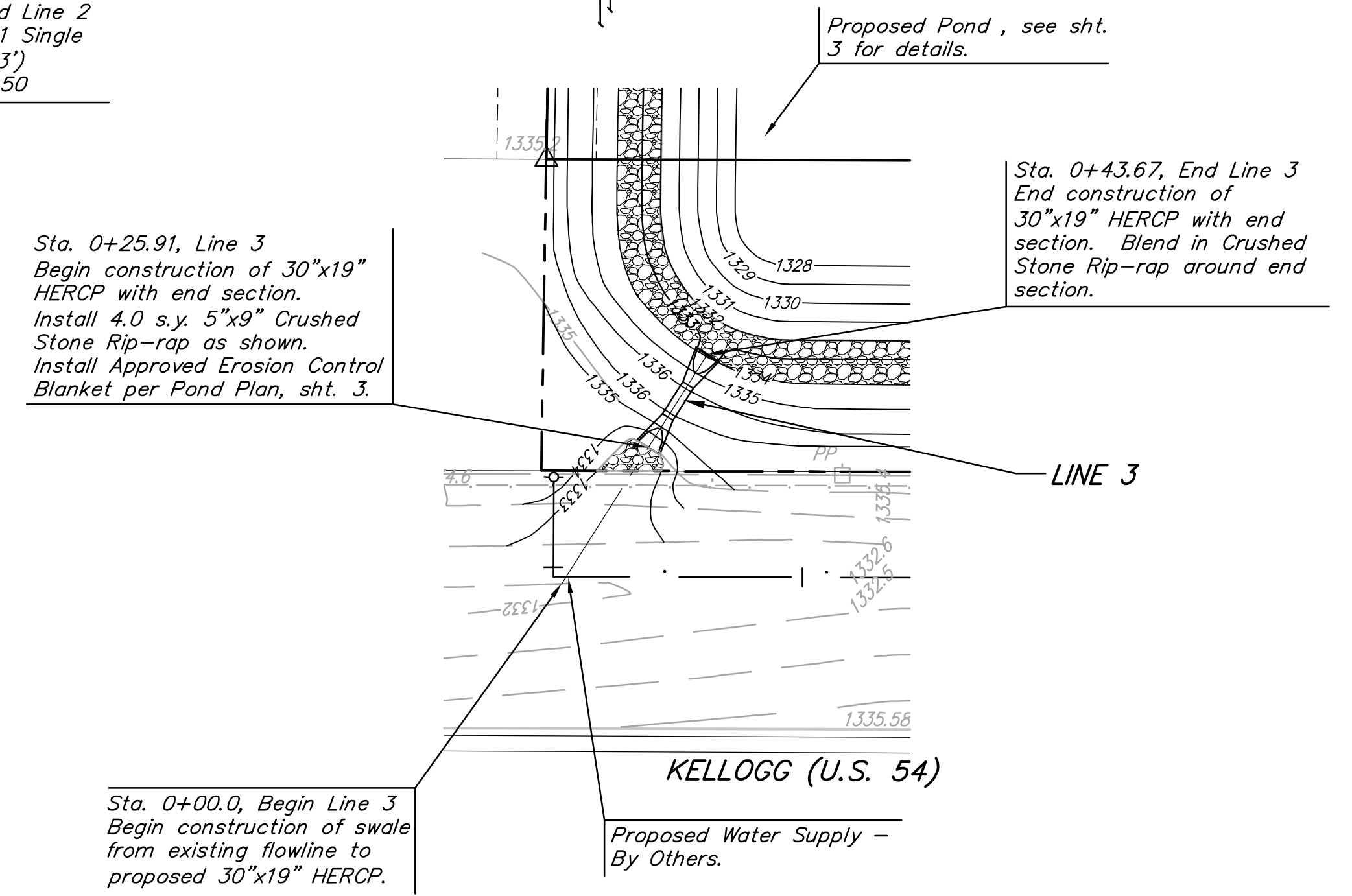
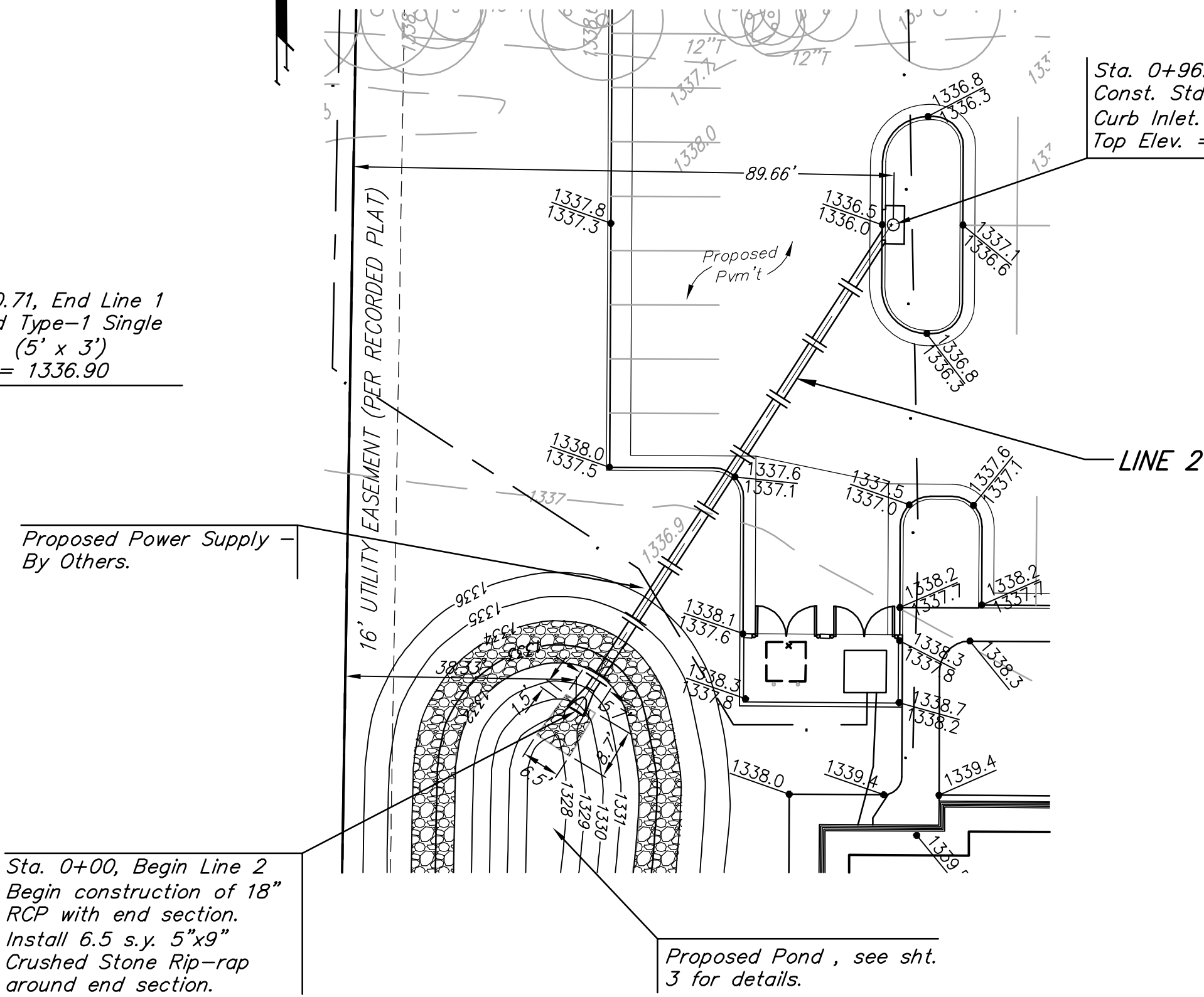
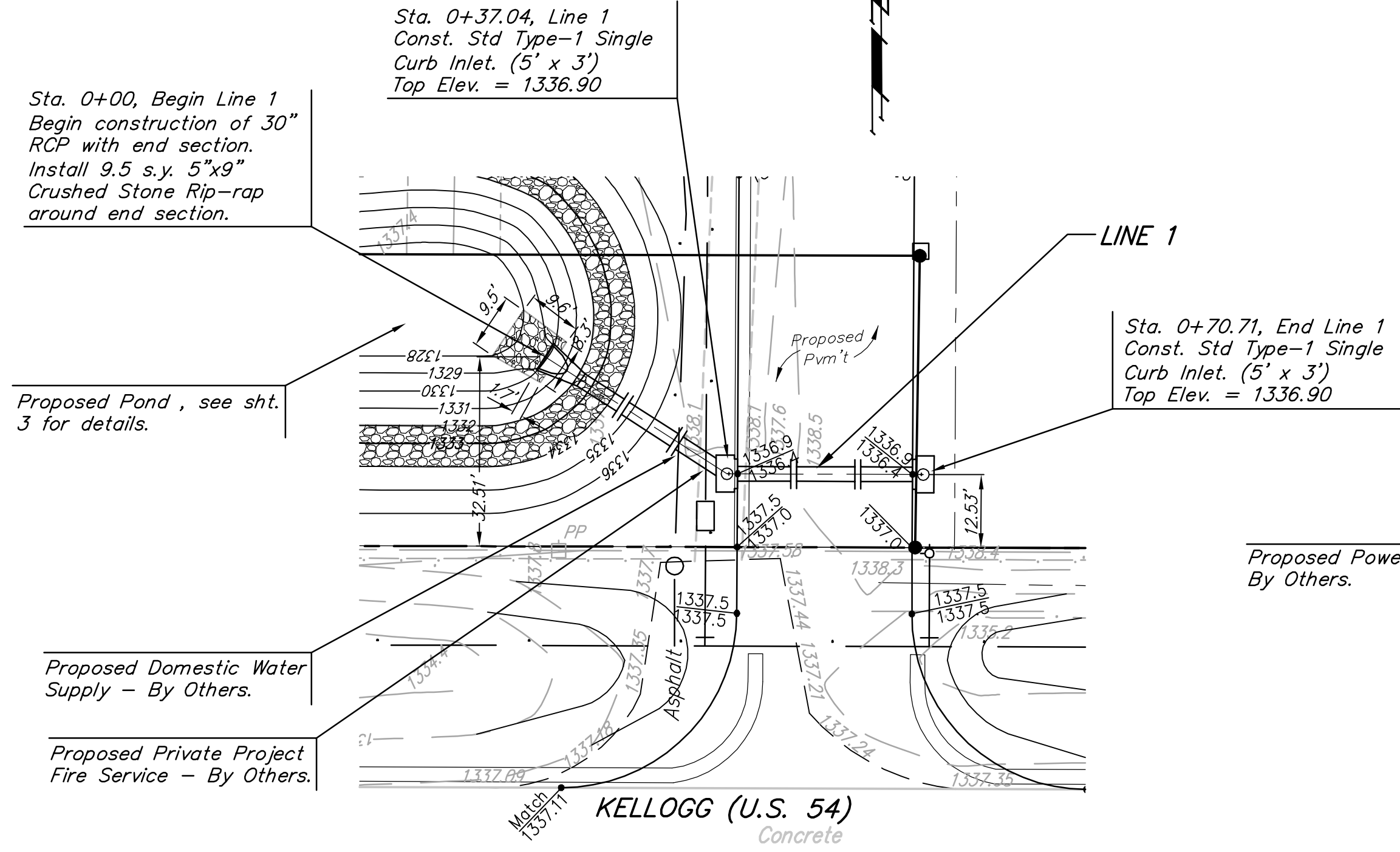

	Wheatridge Addition	
	Lines 1, 2, 3	
Storm Water Sewer Improvements		
<small>Baughman Company, P.A. 315 Ella St. Wichita, KS 67211 P 316-262-7771 F 316-262-0149 ENGINEERING SURVEYING PLANNING LANDSCAPE ARCHITECTURE</small>		
PROJECT NUMBER 1846 PPS	DESIGN MWS	DRAWN MWS
REVISIONS:	APPROVED	DATE 01/08
	SCALE Noted	
	SHEET	2 OF 12
E:\eng\Wheatridge Addition\PPsws1_plandwg		08-01-E024