

BENCHMARKS:
City of Wichita Disc, 13 feet south
and 85 feet east of Kellogg and
119th Street West

Elevation = 1333.36 (MSL)

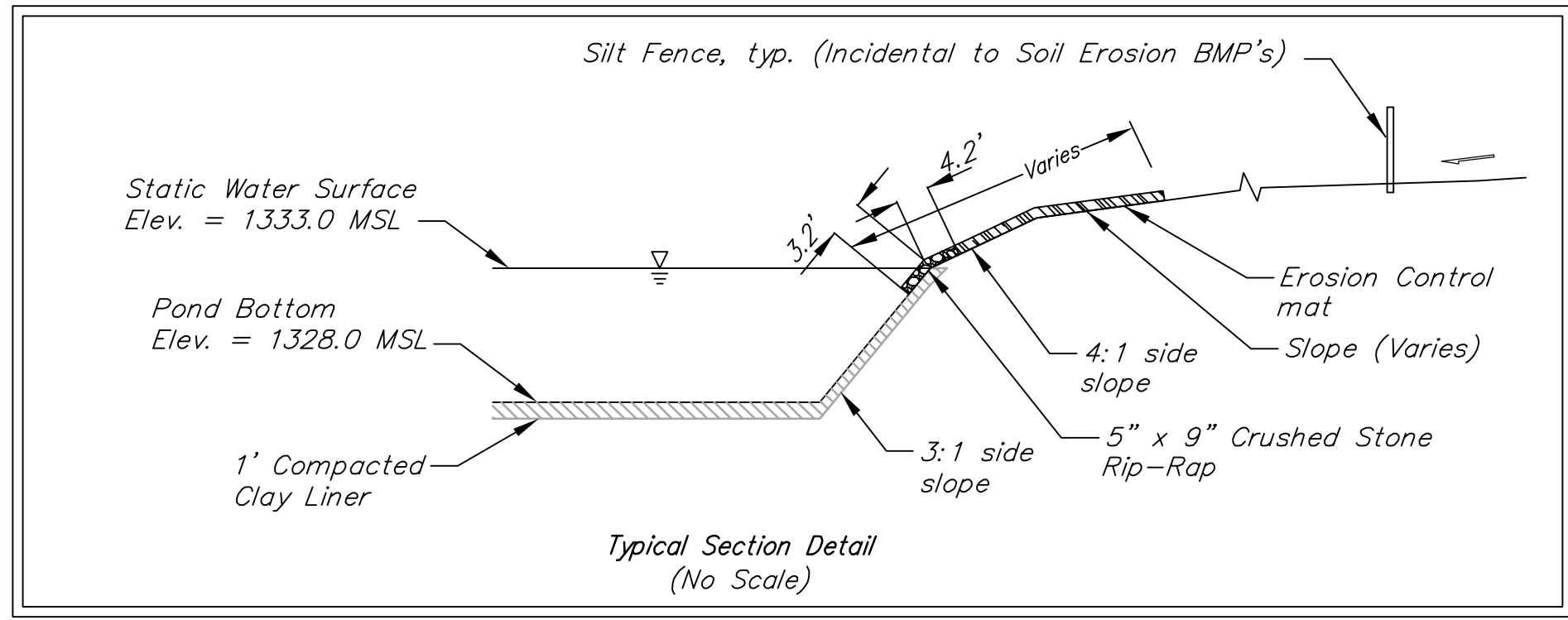
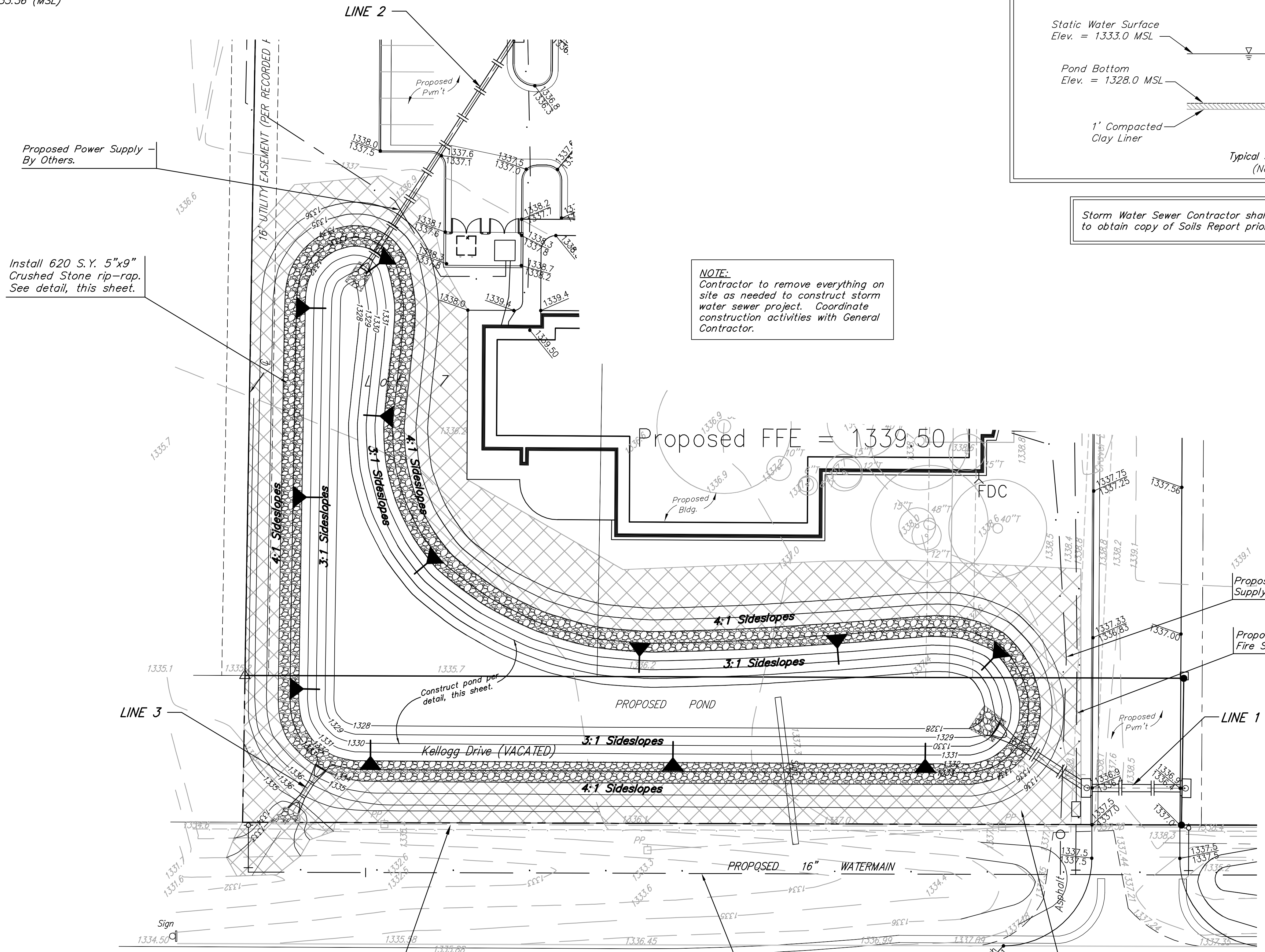

Storm Water Sewer Contractor shall contact General Contractor to obtain copy of Soils Report prior to bidding and construction.

NOTE:
Contractor to remove everything on site as needed to construct storm water sewer project. Coordinate construction activities with General Contractor.

Existing Grade
Proposed Grade

- NOTES:**
- Pond bottom and sideslopes below static pool elevation shall be over-excavated 1' and a 1' clay liner shall be compacted to 95% std. density. The plasticity index (P.I.) shall be at least 30. The compaction and P.I. shall be verified during construction. P.I. determination and compaction testing shall be arranged by the contractor at the request of the inspector. Cost shall be incidental to "Project". Cost of over-excavation to install Clay Liner shall be incidental to "Project."
 - All of the area around the Proposed Pond, from building to KDOT R/W and in-between West Property Line and Drive, above the static water surface shall be seeded and mulched as follows: (Permanent Seeding)
SEED -- Kansas Premium Fescue Blend; 8#/1000 Sq. Ft.
FERTILIZER -- 12-24-12 Ratio at 350 Lbs./Ac.
MULCH -- 2 Tons Prairie Hay / Acre
All of KDOT Right-of-Way shall be seeded per attached KDOT Specifications: (See Attached Sheet)
Contractor shall prepare ground per City and KDOT Specifications. All seeding operations shall conform to City of Wichita Standard Specification and KDOT Specifications. All cost associated with seeding, mulching and fertilizing shall be included in bid item "Project Seeding".
 - Install Erosion Control Mat (Curlax II or approved equal) from top edge of Crushed Rock Ribbon to areas indicated on drawing, this sheet.
 - Contractor to strip top 3" of soil within Pond Area before mass grading and stockpile. Top soil stockpile to be redistributed over Pond Area above static water elevation prior to seeding.
 - Compaction of 95% shall be obtained in all street R/W's, 90% in all other areas.
 - Any excess excavation shall be stockpiled on-site at an area indicated by the Engineer out of easements and R/W.

CAUTION!
Ex. Over-Head Elec.

POND DATA:
STATIC POOL ELEVATION: 1333.0 MSL
BOTTOM ELEVATION: 1328.0 MSL
100 YEAR DESIGN WATER SURFACE: 1335.22 MSL

Install 1,710 S.Y. Curlax II Erosion Control Mat, or approved equal. Erosion control mat shall be installed and anchored per manufacturer's specifications. Note: This quantity does not include excess material necessary for overlap and anchoring.

Baughman		Wheatridge Addition	
		Pond	
		Storm Water Sewer Improvements	
Baughman Company, P.A. 315 Ella St. Wichita, KS 67211 F 316-262-7271 F 316-262-0149			
ENGINEERING SURVEYING PLANNING LANDSCAPE ARCHITECTURE			
PROJECT NUMBER 1846 PPS	DESIGN MWS	DRAWN MWS	DATE 01/08
REVISIONS:	APPROVED	SCALE Noted	SHEET
			3 OF 12