

BENCHMARK:
 BM #1: HOOVER AND 45TH ST NORTH
 - COW BENCHMARK AT NE CORNER OF
 INTERSECTION, 10.20' SSE OF PP.
 58.80' ESE OF PP ON NW CORNER,
 85.50' NE OF GAS LINE MARKER,
 59.00' NORTH OF GAS LINE MARKER,
 28.50' EAST OF CENTERLINE, 14.50'
 NORTH OF CENTERLINE.
 ELEV. = 1335.29 (NGVD 29)

BM #2: Small RR spike in 3rd PP west
 of Hoover St. on the north side of
 45th St. N.
 Elev. = 1337.68

BM #3: Small RR spike in 2nd PP east
 of NW corner of SEC. 23, T1N, R26-S.
 R-1-W (North side of 45th St. N.,
 west of Hoover St.)
 Elev. = 1339.57

BM #4: 60d nail in PP at the SE
 corner of exception on west side of
 Hoover St., south of 45th St. N.
 Elev. = 1335.26

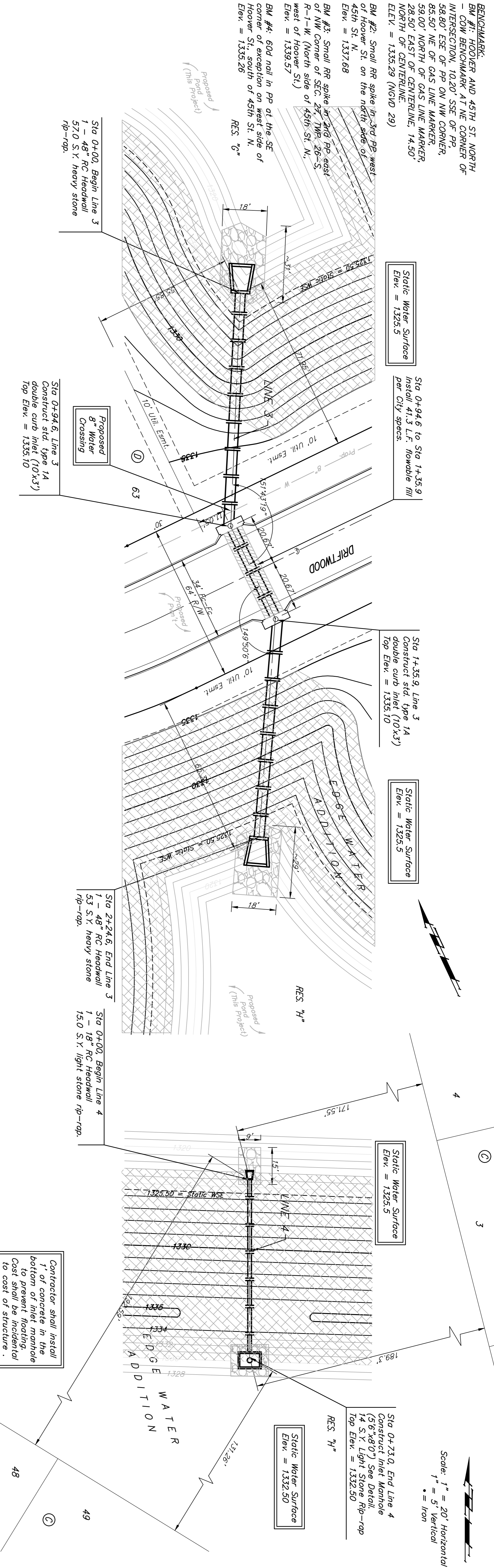

Static Water Surface
 Elev. = 1325.5

Static Water Surface
 Elev. = 1325.5

Static Water Surface
 Elev. = 1325.5

Static Water Surface
 Elev. = 1325.5

Static Water Surface
 Elev. = 1325.5

Static Water Surface
 Elev. = 1325.5

Contractor shall install
 1' of concrete in the
 bottom of inlet manhole
 to prevent floating.
 Cost shall be incidental
 to cost of structure.

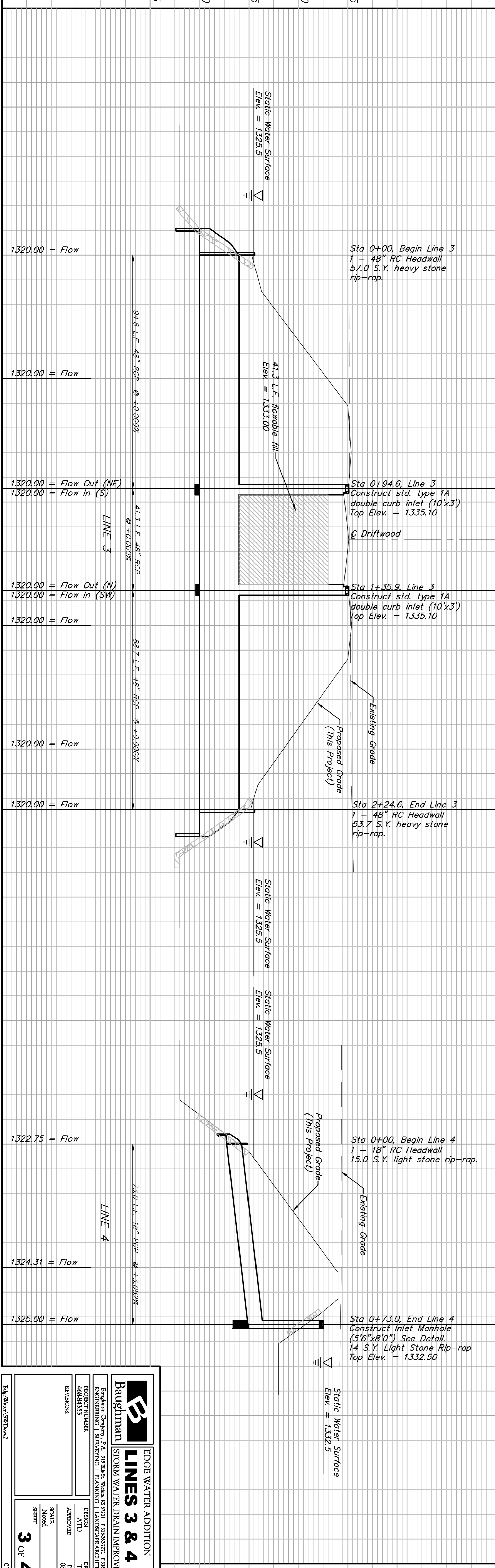

Baughman
EDG WATER ADDITION
LINES 3 & 4
STORM WATER DRAIN IMPROVEMENTS

PROJECT NUMBER: 46844333
 DESIGN: TMS
 DATE: 08/07
 SCALE: Normal
 SHEET: 3 OF 44

07.05.2019